



, Alcester, B49 6DG

£122,000

KING
HOMES

This stunning, brand new 2-bedroom holiday home is located in the tranquil and sought-after Wixford Grange, offering the perfect blend of comfort, modern living, and a peaceful setting. With spacious and well-designed interiors, this home features an open-plan living area that seamlessly combines the lounge, dining, and kitchen spaces, creating a perfect hub for relaxation and entertaining.

The fully fitted kitchen is a standout, equipped with high-quality appliances and ample storage, making it a dream for those who love to cook. The two well-proportioned bedrooms provide a restful retreat, with the master bedroom benefiting from an ensuite bathroom for added convenience and privacy. An additional family bathroom is also thoughtfully designed to meet your needs.

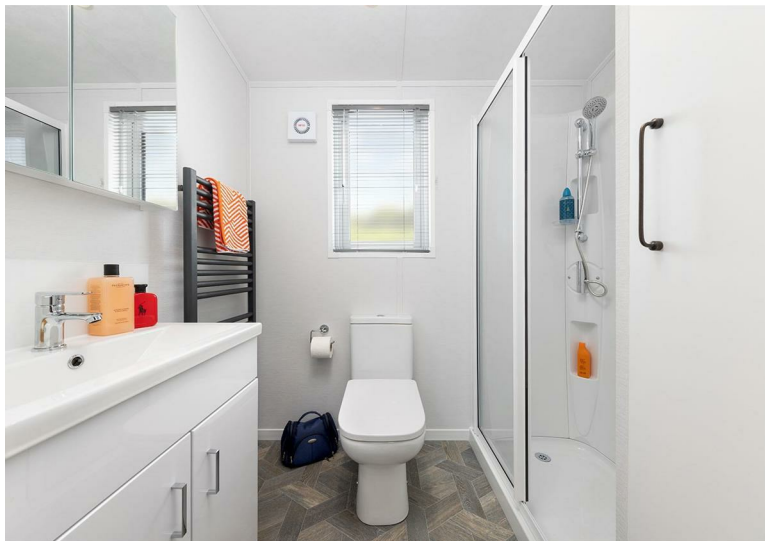

360 VIRTUAL TOUR AVAILABLE

OUR HOMES *ANYWHERE ANYTIME!*
kinghomes.co.uk

A woman wearing a VR headset, looking forward. The headset is black and white with the 'KING' logo on the side.

Location: Wixford, a picturesque riverside village, is nestled in the breathtaking Warwickshire countryside. Situated just 1.5 miles from the abundant amenities of Alcester, a bustling market town, and a mere 15-minute drive from the renowned Stratford-upon-Avon, Wixford boasts two charming village pubs and is also a gateway to the beloved Heart of England Way.

****Images and 360 Virtual Tour are to be used as a guide for the home that will be available****

The first main image is a CGI render and not the actual setting but is the model that will be available*





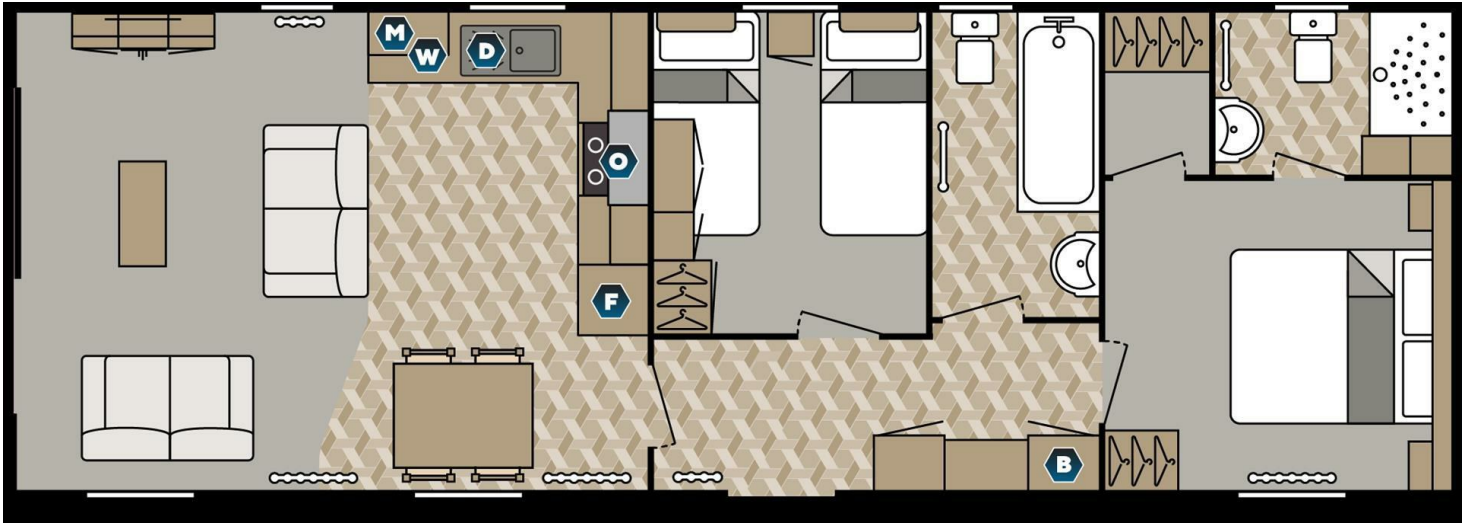

Energy Efficiency Rating		
	Current	Potential
Very energy efficient - lower running costs		
(92 plus) A		
(81-91) B		
(69-80) C		
(55-68) D		
(39-54) E		
(21-38) F		
(1-20) G		
Not energy efficient - higher running costs		
England & Wales	EU Directive 2002/91/EC	

Environmental Impact (CO ₂) Rating		
	Current	Potential
Very environmentally friendly - lower CO ₂ emissions		
(92 plus) A		
(81-91) B		
(69-80) C		
(55-68) D		
(39-54) E		
(21-38) F		
(1-20) G		
Not environmentally friendly - higher CO ₂ emissions		
England & Wales	EU Directive 2002/91/EC	