



Bartletts Avenue, Stratford-Upon-Avon, CV37 9AF

Price £125,000



* PRICE START FROM 40% SHARED OWNERSHIP * END OF TERRACE * Three Bedrooms * Kitchen Diner * Downstairs Cloakroom * Rear Garden * Two parking spaces * NO CHAIN * ENERGY EFFICIENT * Contact us today to find out more!



Hall	
Living Room	13'8" x 12'0" (4.19m x 3.68m)
Inner Hallway	
WC	4'9" x 6'2" (1.45m x 1.88m)
Store	
Kitchen / Diner	12'2" x 15'5" (3.73m x 4.71m)
Landing	
Bedroom One	10'1" x 12'0" (3.08m x 3.68m)
Bedroom Two	13'5" x 8'2" (4.11m x 2.51m)
Bedroom Three	11'4" x 6'10" (3.47m x 2.10m)

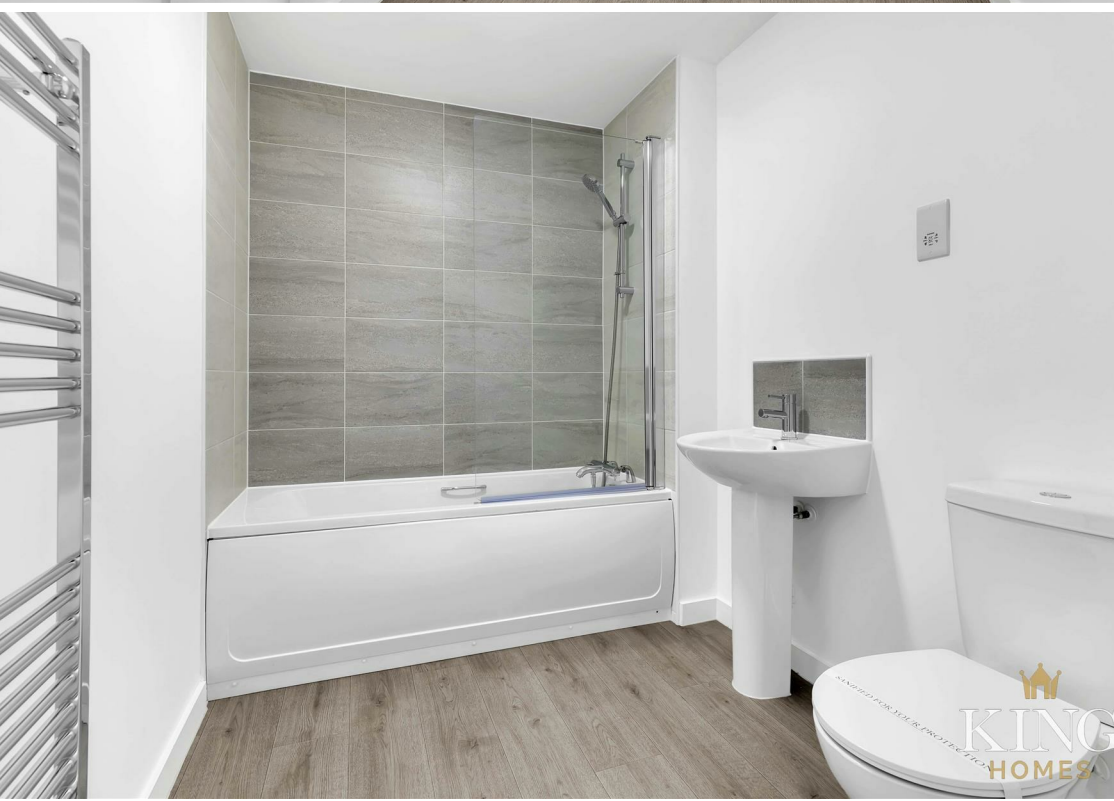





KING
HOMES

Ground Floor

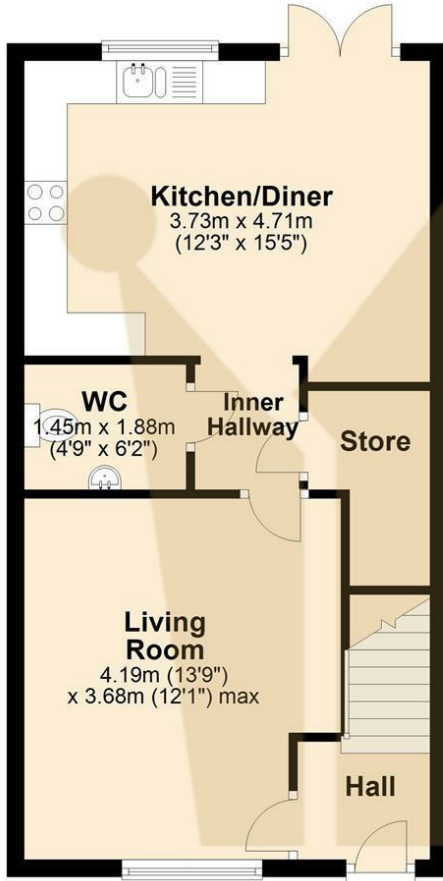
Approx. 43.7 sq. metres (469.9 sq. feet)



First Floor

Approx. 43.7 sq. metres (469.9 sq. feet)

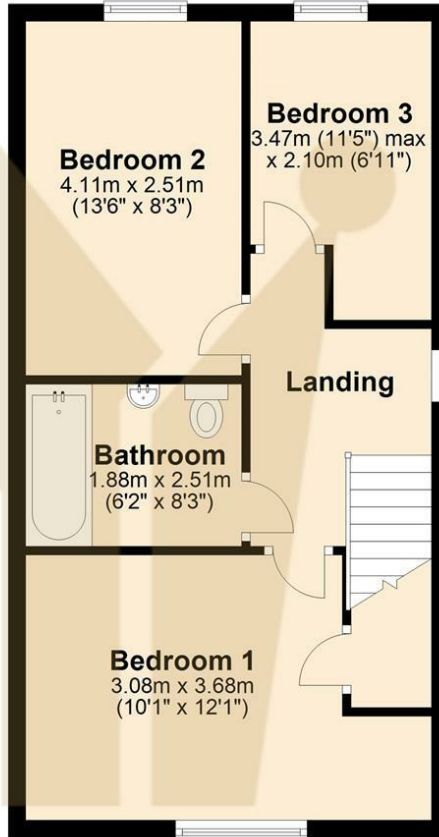

Total area: approx. 87.3 sq. metres (939.7 sq. feet)

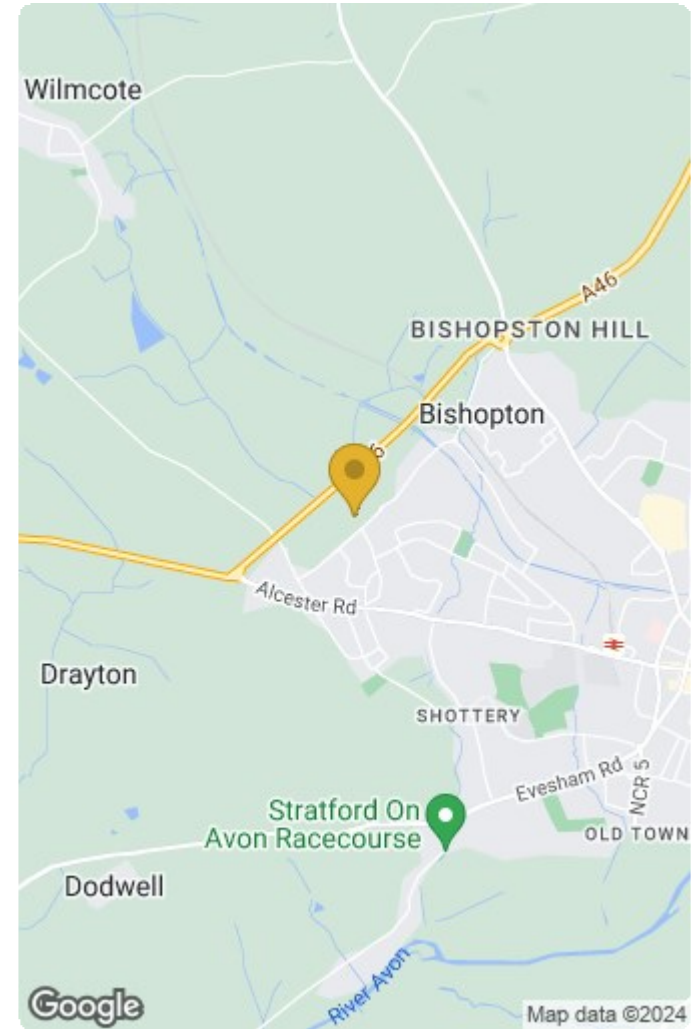

Energy Efficiency Rating		Current	Potential
Very energy efficient - lower running costs			
(92 plus) A			
(81-91) B			
(69-80) C			
(55-68) D			
(39-54) E			
(21-38) F			
(1-20) G			
Not energy efficient - higher running costs			
England & Wales	EU Directive 2002/91/EC		

Environmental Impact (CO ₂) Rating		Current	Potential
Very environmentally friendly - lower CO ₂ emissions			
(92 plus) A			
(81-91) B			
(69-80) C			
(55-68) D			
(39-54) E			
(21-38) F			
(1-20) G			
Not environmentally friendly - higher CO ₂ emissions			
England & Wales	EU Directive 2002/91/EC		