



Frome Park, Bartestree - HR1 4BF

Guide Price £385,000



hollywell
homes



8 Frome Park

Bartestree, Hereford

Beautifully modernised 3-bed detached home in quiet cul-de-sac. Stylish interiors, spacious living areas, driveway and garage. Peaceful location. Must-see property! Call Hollywell Homes today!

Council Tax band: D

Tenure: Freehold

EPC Energy Efficiency Rating: D

EPC Environmental Impact Rating: E

- 3 Bedroom Detached
- Spacious Living Throughout
- Conservatory
- Beautifully Presented
- Recently Modernised Throughout
- Ideal Family Home





hollywell
homes







GROUND FLOOR



FIRST FLOOR

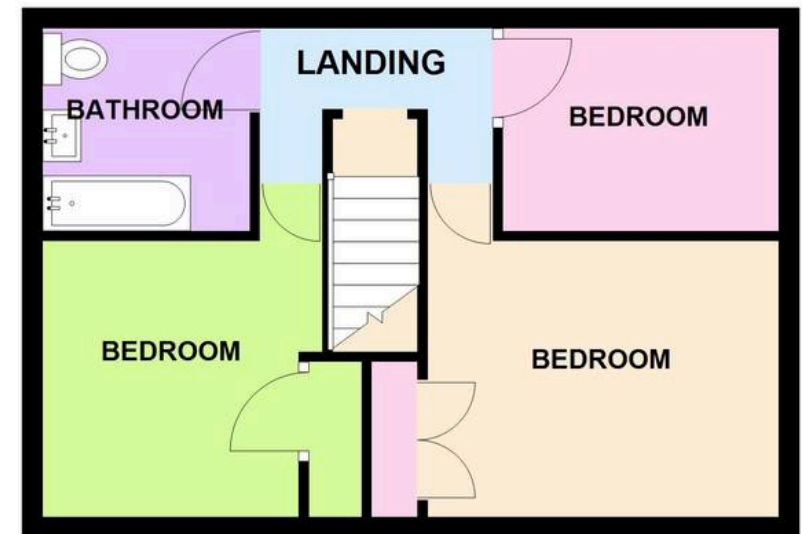

Entrance Hall

Downstairs WC

Lounge

15' 6" x 11' 2" (4.73m x 3.40m)

Kitchen/Diner

15' 6" x 8' 11" (4.73m x 2.71m)

Conservatory

12' 6" x 8' 9" (3.80m x 2.67m)

Landing

Family Bathroom

Bedroom

8' 9" x 11' 2" (2.67m x 3.40m)

Bedroom

8' 3" x 8' 9" (2.51m x 2.67m)

Bedroom

6' 9" x 8' 2" (2.05m x 2.49m)





Hollywell Homes

14 St Johns, Worcester - WR2 5AH

01905 948848

info@hollywellhomes.co.uk

<http://www.hollywellhomes.co.uk/>



hollywell
homes 