

## Brook Lane, Birmingham, B13 0TQ

£465,000

🛏 5 🚗 2 🚲 1



- Five-bedroom detached home with a loft conversion and rear extension.
- High-end appliances included
- Two modern bathrooms
- Excellent local amenities, including schools, parks, and shops.
- 
- Spacious Kitchen/Diner
- Minton-tiled hallway
- Driveway parking
- 
- 

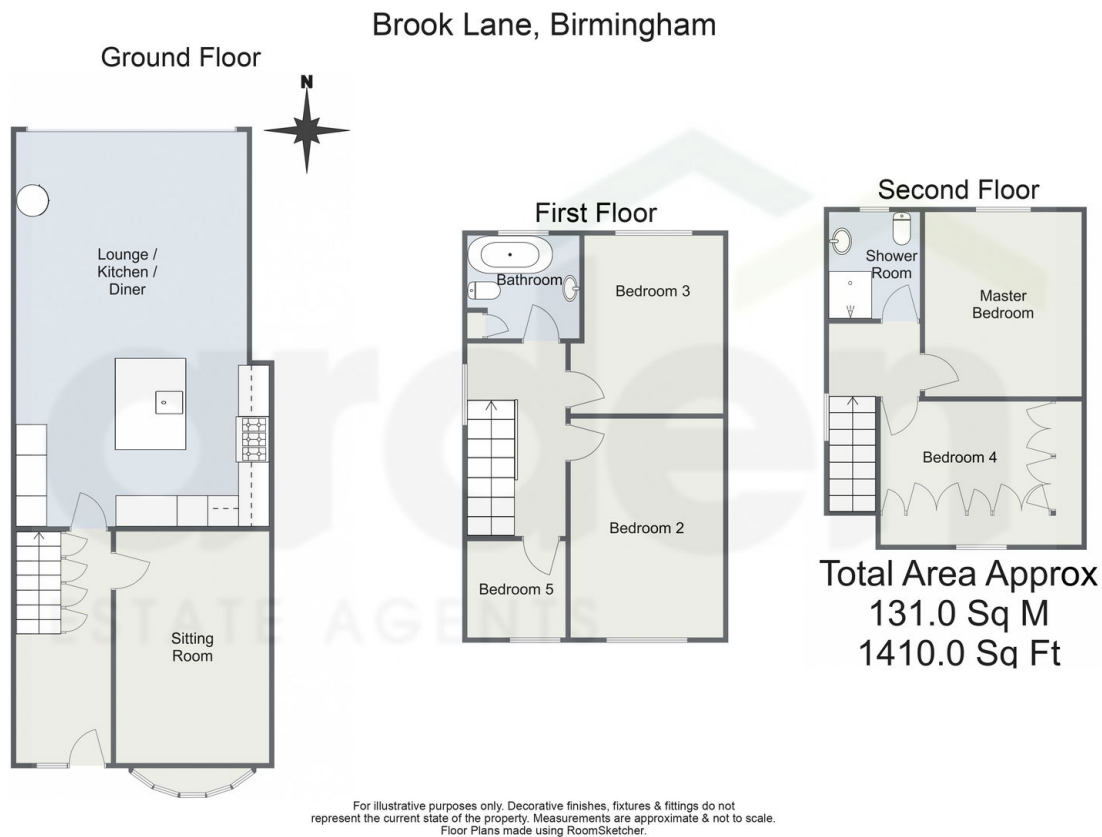

Nestled in the heart of Kings Heath, Brook Lane is a beautifully extended five-bedroom detached home that effortlessly combines period charm with modern upgrades. With a loft conversion and rear extension completed just three years ago, this spacious home has been carefully designed to offer both character and practicality, making it an ideal choice for families.