



## Farnborough Centrifuge, GU14

### £1,350,000

Dexters are delighted to introduce the Farnborough Centrifuge, a unique opportunity to purchase a piece of British aviation history.

Constructed in 1954 the centrifuge was designed to replicate the high G-force environment of flight, under controlled, repeatable and safe conditions enabling scientists to investigate how G-force affects the human body, as well as testing of aircraft equipment, clinical investigation and training.

The total site area is circa 1,756 sq m (18,9013 sq ft) with a built area of circa 1,040 sq m (11,202 sq ft), featuring a roughly circular reinforced concrete structure that forms the main building housing the Centrifuge. The Centrifuge Facility rises to the equivalent of four-storeys with an additional basement for the centrifuge drive motor and bearings.

The Centrifuge was operational until its final run on the 4th of March 2019, by which point it had completed a total of 122,133 runs. During this time, it played a key role in research into the High G environment and contributed to many world-leading technological developments.

Located with 115 metres of Farnborough Airport, Farnborough town centre is within 1.5 kilometres whilst Farnborough (Main) train station is within 2.0 kilometres providing direct trains to London Waterloo.

Access to the M3 is within 4.5 kilometres providing road access Northeast into London and Southwest to Southampton.

The building is listed under the Planning (Listed Buildings and Conservation Areas) Act 1990 as amended for its special architectural or historic interest. The building was classified as Grade II Listed on the 16th of August 2007, List Entry Number: 1392200.

The sale is for the unencumbered Freehold.

### Features

- The Former Royal Airforce Institute of Aviation Medicine
- Constructed in 1954
- Grade II Listed
- Site area is circa 1,756 sq m (18,9013 sq ft)
- Built area of circa 1,040 sq m (11,202 sq ft)
- Within 115 metres of Farnborough Airport

# Farnborough Centrifuge, GU14

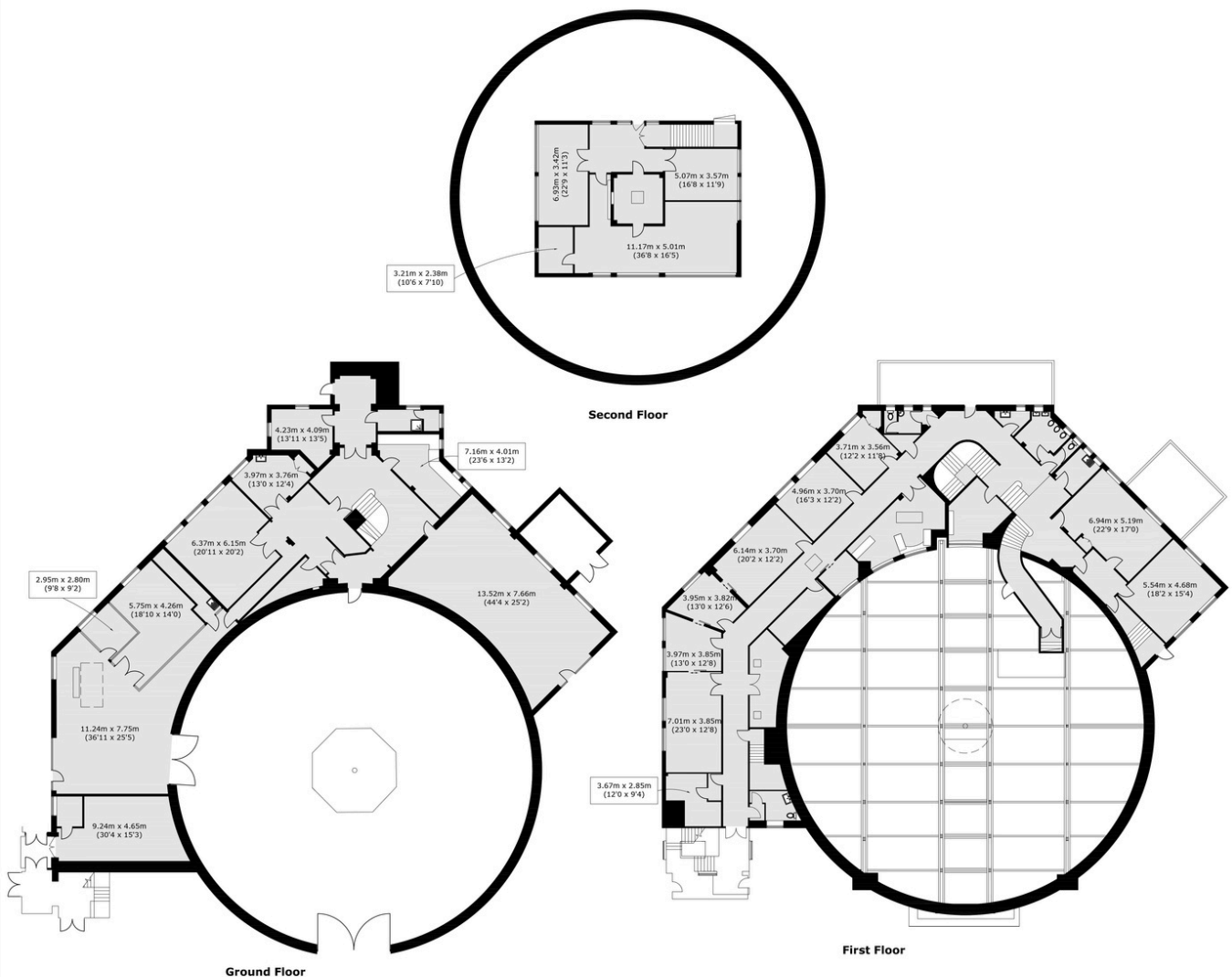

Total area (approx.): 1040.7 sq. m (11,202.1 sq. ft)