



41 Burnet Close, Melksham, SN12 7SJ

£950 Per Month

- Two bedroom mid terrace house
- Available end of July 2025
- Longer term let preferred
- Enclosed garden with summer house / shed
- Pets are not considered
- Viewing Day - Friday 23rd May
- Council Tax - B (Wiltshire Council)
- EPC - D

THE PROPERTY

Blueleaf Property are delighted to offer this well presented two bedroom home situated in a sought after area of Melksham.

The ground floor accommodation comprises lounge with understairs storage cupboard and kitchen breakfast room with patio doors onto the rear garden.

The first floor accommodation comprises landing, two double bedrooms, airing cupboard and bathroom.

The property further benefits from one parking space to the front, electric heating, upvc double glazing, enclosed rear garden with summer house / shed.

The landlord would prefer a longer term let. Pets are not considered.

Viewing Day - Friday 23rd May.

All room measurements are approx:

Lounge: 4.85m x 3.56m

Kitchen Breakfast Room: 2.57m x 3.56m

Bedroom One: 2.59m x 3.56m

Bedroom Two: 2.51m x 3.56m

SITUATION

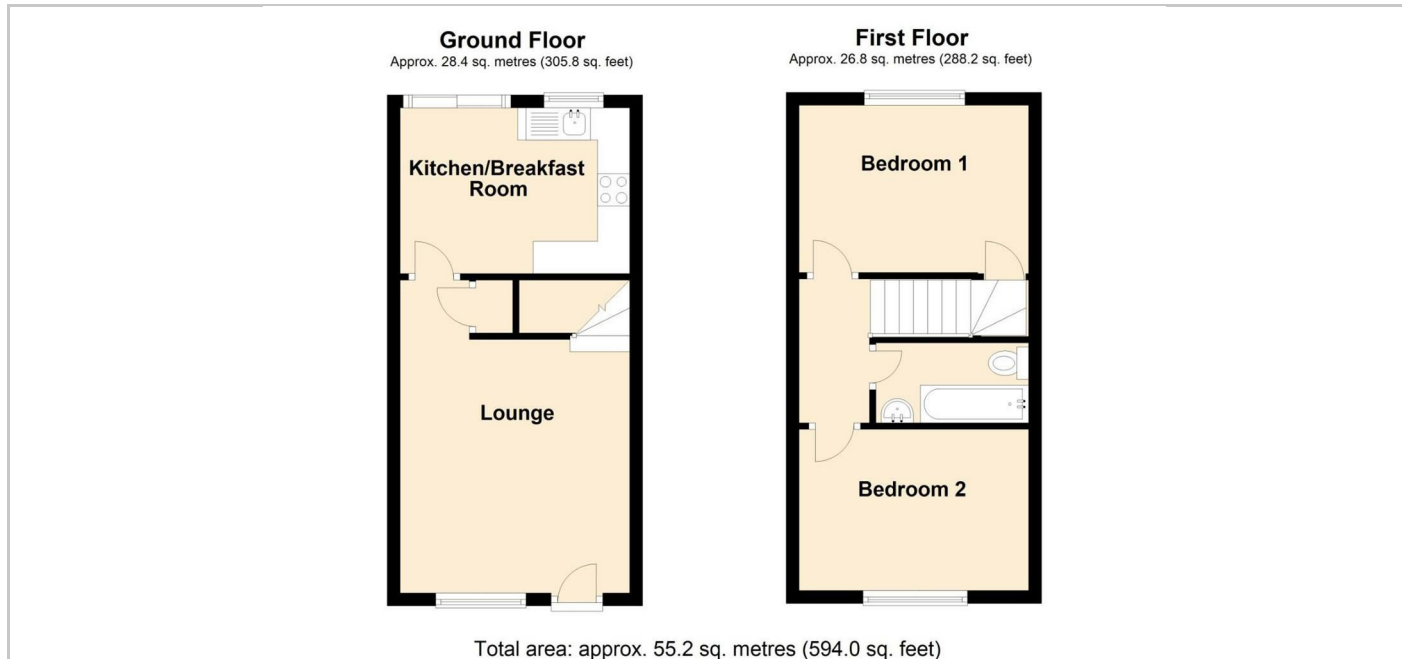

Directions