



14 Penny Lane, Chippenham, SN15 3SS

£1,000 Per Month

- Two bedroom house
- Parking for two cars
- Gas central heating
- EPC - C
- Long term let preferred
- Enclosed rear garden
- Council Tax - B (Wiltshire Council)

THE PROPERTY

Blueleaf Property are delighted to offer this two bedroom property to let in Pewsham, Chippenham.

The ground floor accommodation comprises lounge with storage cupboard and kitchen with stable style door onto the rear garden. The first floor accommodation comprises landing with airing cupboard, main bedroom with built in storage, second bedroom and bathroom.

The property further benefits from an enclosed rear garden with deck, lawn and shed. Please note the shed is showing signs of age and there is a gated right of access across the bottom of the garden that does not appear to have been used for some time. There is also two allocated parking spaces in a courtyard to the side of the property.

The landlord would prefer a longer term let. Pets are not considered.

All room measurements are approx.

Lounge: 3.73m x 4.69m

Kitchen; 3.73m x 2.39m

Bedroom One: 3.45m x 1.73m ext 3.06m

Bedroom Two: 3.64m x 1.73m

Bathroom: 1.92m x 1.89m

SITUATION

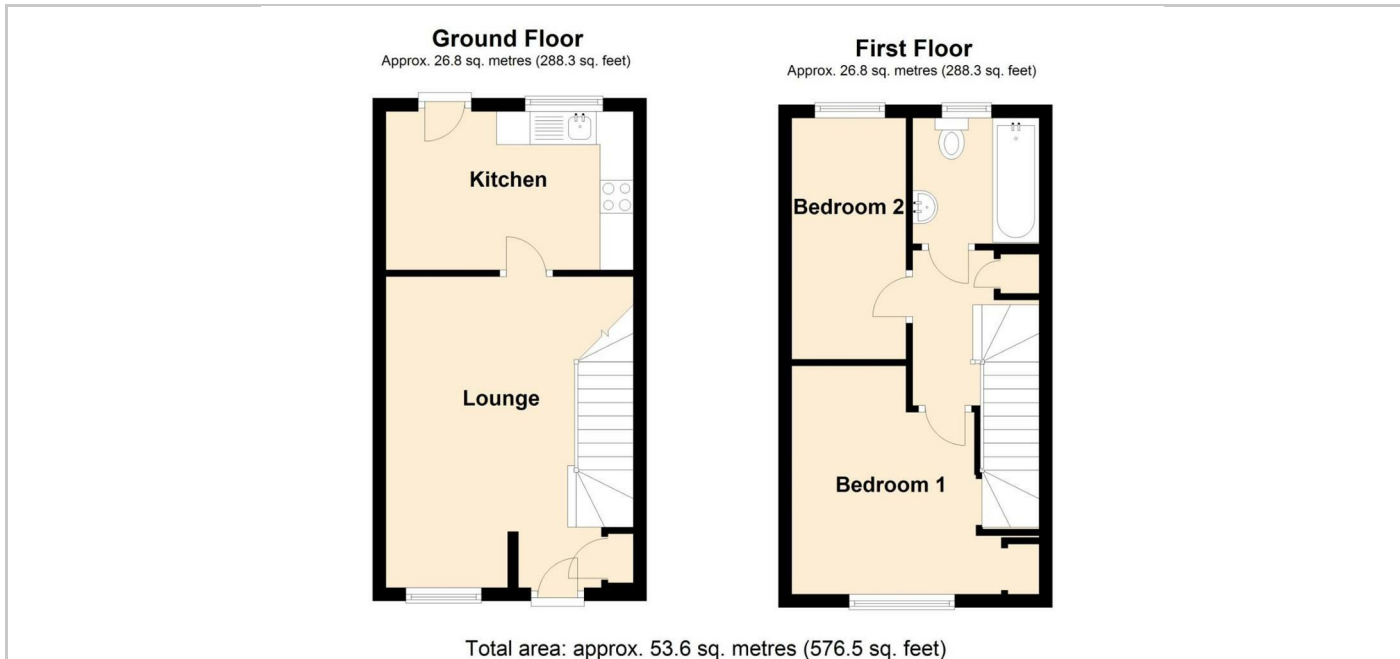

Directions

Office 4 Stockley Farm, Stockley, Wiltshire, SN11 0NT

Tel: 01225 839050 Email: hello@blueleafproperty.co.uk <https://www.blueleafproperty.co.uk>