



TO LET



4 Chapel Close, Melksham, Wiltshire, SN12 7ER

£675 PCM

- One bedroom apartment
- Long term let preferred
- Allocated parking
- Gas central heating
- Upvc double glazing
- EPC - C
- Council Tax - A

THE PROPERTY

Blueleaf Property are delighted to offer this one bedroom first floor apartment located in Church Lane, Melksham.

The accommodation comprises entrance hall, lounge dining room, kitchen, bathroom and bedroom with fitted wardrobe.

The property further benefits from gas central heating (combination boiler), UPVC double glazing and allocated parking to the rear of the building for two cars.

The landlord would prefer a longer term let. Pets are not considered.

Please note photos are from start of previous tenancy.

All room measurements are approx;
Lounge Dining Room: 2.67m x 4.45m
Kitchen: 1.63m x 3.43m
Bedroom: 3.15m x 2.32m

SITUATION

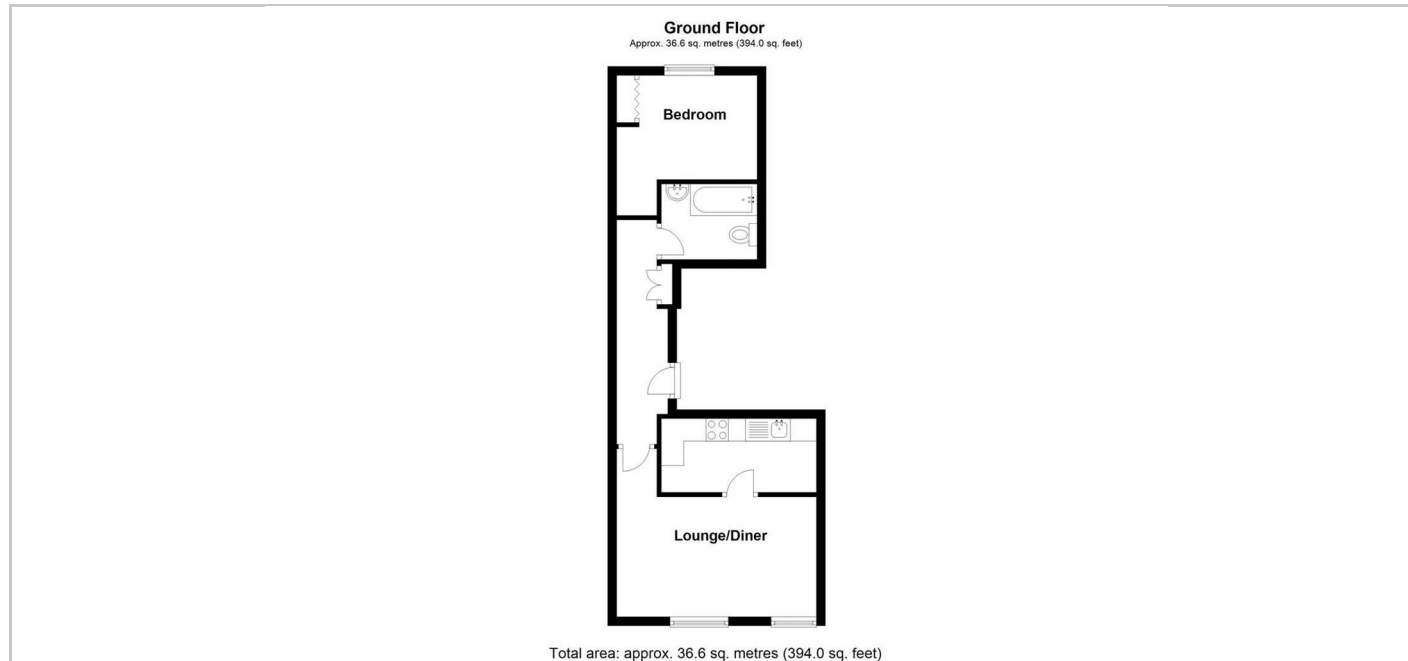

Directions