



MALLINSON
& CO

INNOVATIVE PROPERTY EXPERTS

Hartcliffe View, Thurgoland, Sheffield, S35 7BD

Offers Over £450,000

🛏 4 🚿 2 🛋 1



- STONE BUILT DETACHED FAMILY HOME
- OPEN PLAN DINING KITCHEN
- LARGE CONER PLOT
- WESTERLY FACING LANDSCAPED GARDEN
- BEAUTIFULLY PRESENTED THROUGHOUT
- 4 BEDROOMS
- JACK & JILL BATHROOM & EN SUITE
- DOUBLE GARAGE & DRIVEWAY
- COUNTRYSIDE VIEWS
- EASY ACCESS TO OPEN COUNTRYSIDE, LOCAL AMENITIES, SCHOOLING AND TRANSPORT LINKS



TAKE A LOOK AT THIS ... SITUATED IN A PRIVATE SECLUDED CUL DE SAC POSITION IS THIS SELF-BUILT DETACHED STONE PROPERTY, SET WITHIN A LARGE CORNER PLOT WITH COUNTRYSIDE VIEWS. THE PROPERTY FEATURES AN OPEN PLAN DINING KITCHEN, EN SUITE ACCESS TO THREE BEDROOMS AND A DETACHED DOUBLE GARAGE. IDEALLY SUITED TO THE FAMILY PURCHASER WITH EASY ACCESS TO OPEN COUNTRYSIDE, LOCAL AMENITIES, SCHOOLING AND TRANSPORT LINKS. AN EARLY INSPECTION IS HIGHLY RECOMMENDED.

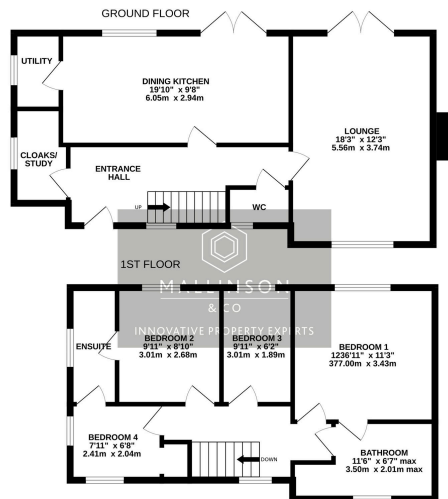

TOTAL FLOOR AREA - 1156 sq.ft. (107.4 sq.m.) approx.
Unless energy saving has been made to reduce the quantity of the following standard tests, measurements of doors, windows, floors and any other items are approximate and no responsibility is taken for any error, omission or misstatement. This plan is for guidance purposes only and should be used in conjunction with the prospective purchaser. The services, systems and equipment shown on this plan are for guidance only and no guarantee is given as to their operation or efficiency can be given.
 Made with Hertsplan 12/05

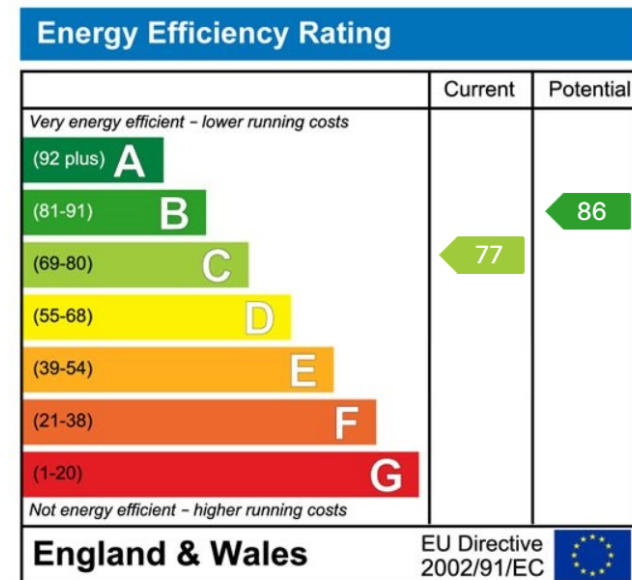

INNOVATIVE
PROPERTY
EXPERTS

Mallinson & Co

Office: 01226 414 150

Email: ben@mallinsonandco.co.uk

Web: www.mallinsonandco.co.uk

Suite 2, Penistone 1, St. Mary's Street, Penistone, Sheffield S36 6DT