



MALLINSON
& CO

INNOVATIVE PROPERTY EXPERTS

Ivy Bank Close, Penistone, Sheffield, S36 7GT

Offers Over £585,000

🛏 6 🍳 5 🛋 2



- DETACHED FAMILY HOME
- 6 DOUBLE BEDROOMS
- SUPERB OPEN PLAN LIVING KITCHEN & UTILITY
- 3 MODERN EN SUITES & FAMILY BATHROOM
- INTEGRAL DOUBLE GARAGE & DRIVE
- LANDSCAPED GARDENS
- WELL PRESENTED THROUGHOUT
- VERSATILE TOP FLOOR ACCOMMODATION
- FAR REACHING VIEWS
- CLOSE TO LOCAL OPEN COUNTRYSIDE, AMENITIES, SCHOOLS & TRANSPORT LINKS



LOCATED IN THE IDYLIC AND HIGHLY REGARDED VILLAGE OF INGBIRCHWORTH, THIS BEAUTIFULLY APPOINTED SIX DOUBLE BEDROOM DETACHED FAMILY HOME OFFERS EXCEPTIONAL AND VERSATILE ACCOMMODATION ARRANGED OVER THREE SPACIOUS LEVELS. ENJOYING FAR-REACHING RURAL VIEWS AND POSITIONED ON A PRIVATE DRIVEWAY, THE PROPERTY IS IDEALLY SUITED TO THE GROWING FAMILY OR THOSE SEEKING FLEXIBLE MULTI-GENERATIONAL LIVING. THE TRUE HEART OF THE HOME IS THE IMPRESSIVE OPEN PLAN LIVING KITCHEN, COMPLETE WITH A WOOD-BURNING STOVE AND DIRECT ACCESS TO THE LANDSCAPED REAR GARDEN. FURTHER HIGHLIGHTS INCLUDE THREE EN-SUITE FACILITIES, A DRESSING ROOM TO THE PRINCIPAL BEDROOM AND AN INTEGRAL DOUBLE GARAGE, ALL WITHIN CLOSE PROXIMITY TO LOCAL AMENITIES, THE FOUNTAIN PUBLIC HOUSE AND THE SCENIC WALKS AROUND INGBIRC

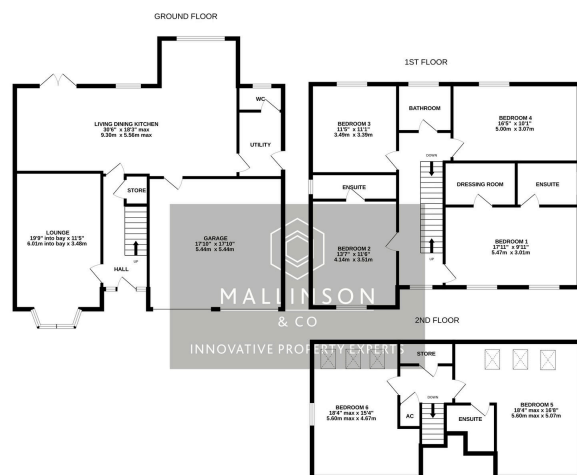

TOTAL FLOOR AREA: 2757 sq.ft. (256.1 sq.m.) approx.
Whilst every attempt has been made to ensure the accuracy of the floorplan contained here, measurements of doors, windows, rooms and any other items are approximate and no responsibility is taken for any error, omission or mis-statement. This plan is for illustrative purposes only and should be used as such by any prospective purchaser. The services, systems and appliances shown have not been tested and no guarantee as to their operability or efficiency can be given.
 Made with Metropix 2020/21

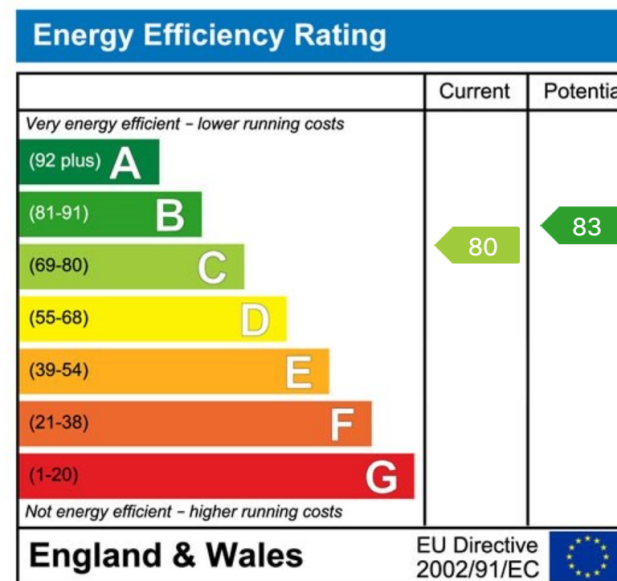

INNOVATIVE
PROPERTY
EXPERTS

Mallinson & Co

Office: 01226 414 150

Email: ben@mallinsonandco.co.uk

Web: www.mallinsonandco.co.uk

Suite 6, Penistone 1, St. Mary's Street, Penistone, S36 6DT