





MALLINSON
& CO

INNOVATIVE PROPERTY EXPERTS

West Green Avenue, Monk Bretton, Barnsley, S71 5SG

Offers Over £250,000

 3  2  1



- FANTASTIC DETACHED HOME
- STUNNING OPEN PLAN LIVING ACCOMMODATION
- DRIVEWAY PROVIDING OFF ROAD PARKING
- CLOSE TO SCHOOLS, NURSERIES & TRANSPORT LINKS
- PERFECT FOR FIRST TIME BUYERS, FAMILIES & DOWNSIZERS
- 3 DOUBLE BEDROOMS
- NEWLY FITTED KITCHEN
- LOW MAINTENANCE WESTERLY FACING REAR GARDEN
- ENSUITE TO BEDROOM ONE
- NO UPWARD VENDOR CHAIN



NEWLY REFURBISHED OPEN PLAN LIVING KITCHEN! OFFERED TO MARKET WITH NO UPWARD CHAIN IS THIS OUTSTANDING DETACHED HOME SET ON THIS HIGHLY REGARDED DEVELOPMENT. THE PROPERTY FEATURES 3 WELL APPOINTED BEDROOMS, ONE WITH ENSUITE, HOUSE BATHROOM AND A STUNNING OPEN PLAN LIVING KITCHEN SPANNING THE FULL GROUND FLOOR WITH BI FOLD DOORS OPENING OUT ONTO THE LARGE WESTERLY FACING REAR GARDEN. LOCATED CLOSE TO LOCAL AMENITIES, SCHOOLING AND TRANSPORT LINKS, THE PROPERTY IS PERFECTLY SUITED TO FIRST TIME BUYERS, FAMILIES AND DOWNSIZERS ALIKE.

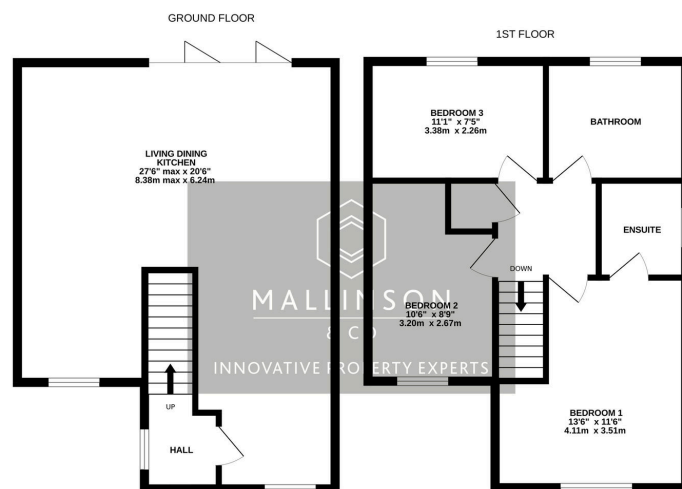

TOTAL FLOOR AREA : 1017 sq.ft. (94.5 sq.m.) approx.
Whilst every attempt has been made to ensure the accuracy of the floorplan contained here, measurements of doors, windows, rooms and any other items are approximate and no responsibility is taken for any error, omission or mis-statement. This plan is for illustrative purposes only and should be used as such by any prospective purchaser. The services, systems and appliances shown have not been tested and no guarantee as to their operability or efficiency can be given.
Made with Metagap ©2020

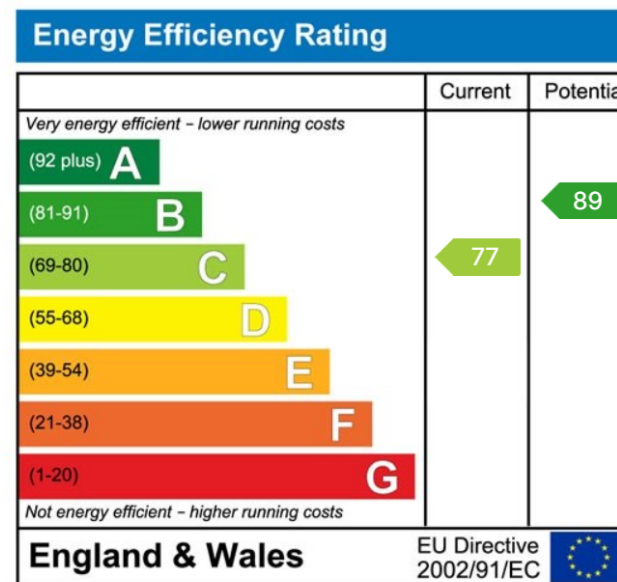

**INNOVATIVE
PROPERTY
EXPERTS**

Mallinson & Co

Office: 01226 414 150

Email: ben@mallinsonandco.co.uk

Web: www.mallinsonandco.co.uk

Suite 2, Penistone 1, St. Mary's Street, Penistone, Sheffield S36 6DT