



MALLINSON  
& CO

INNOVATIVE PROPERTY EXPERTS



## Copster Close, Thurgoland, Sheffield, S35 7BQ

Offers Over £295,000

🛏 4 🚿 1 🛋 1



- SEMI DETACHED FAMILY HOME
- BEAUTIFULLY RENOVATED
- NEW BATHROOM & DOWNSTAIRS W.C.
- LANDSCAPED SOUTH FACING GARDEN
- NO UPPER VENDOR CHAIN
- 4 BEDROOMS
- NEWLY FITTED OPEN PLAN KITCHEN & A UTILITY SPACE
- MEZZANINE LEVEL OFFICE/ OCCASIONAL BEDROOM 5
- AMPLE OFF STREET PARKING
- CLOSE TO LOCAL AMENITIES, SCHOOLS & TRANSPORT LINKS





ARE YOU IN THE MARKET FOR A FAMILY HOME? ... THIS BEAUTIFULLY REFURBISHED FOUR BEDROOM TOWNHOUSE STYLE PROPERTY IS AN EXCEPTIONAL OPPORTUNITY FOR GROWING FAMILIES SEEKING SPACE, STYLE, AND CONVENIENCE. SET WITHIN A QUIET CUL-DE-SAC IN THE HEART OF THURGOLAND, THE HOME HAS BEEN EXTENSIVELY RENOVATED THROUGHOUT TO INCLUDE NEW BOILER/ HEATING SYSTEM REWIRING, REPLUMBING, NEW BATHROOMS AND A STUNNING OPEN PLAN KITCHEN WITH DIRECT ACCESS TO SOUTH FACING LANDSCAPED GARDENS. SPANNING THREE FLOORS OF WELL-APPOINTED ACCOMMODATION, THIS STYLISH HOME OFFERS GENEROUS LIVING SPACE, OFF STREET PARKING, AN INTEGRAL GARAGE, AND A MEZZANINE LEVEL IDEAL AS A HOME OFFICE OR OCCASIONAL FIFTH BEDROOM. WITH CLOSE PROXIMITY TO THURGOLAND JUNIOR SCHOOL, BEAUTIFUL OPEN COUNTRYSIDE TRANSPORT

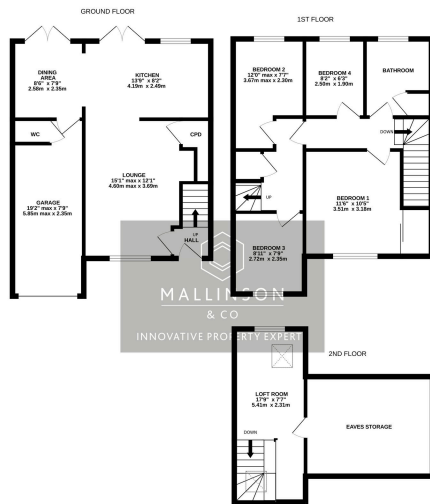

TOTAL FLOOR AREA - 1370 sq ft (127.3 sq.m.) approx.  
While every attempt has been made to ensure the accuracy of the floorplan contained here, measurements of doors, windows, rooms and any other items are approximate and no responsibility is taken for any error, omission or misstatement. This plan is for illustrative purposes only and should be used as such by any prospective purchaser. The services, systems and appliances shown have not been tested and no guarantee as to their operability or efficiency can be given.  
Made with MergeM 10/2019

ENT  
PROPERTY.

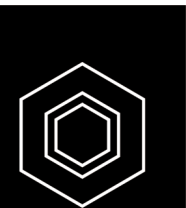
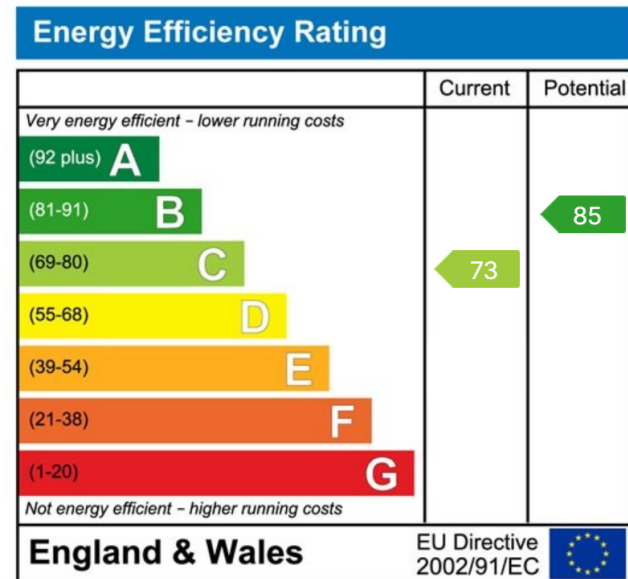

INNOVATIVE  
PROPERTY  
EXPERTS

**Mallinson & Co**

Office: 01226 414 150

Email: [ben@mallinsonandco.co.uk](mailto:ben@mallinsonandco.co.uk)

Web: [www.mallinsonandco.co.uk](http://www.mallinsonandco.co.uk)

Suite 2, Penistone 1, St. Mary's Street, Penistone, Sheffield S36 6DT