



THE MCPHERSON
DEVELOPMENT
— GOUROCK —

**BOWMAN
REBECCHI**
— ESTATE AGENTS —





The McPherson Development

The Perfect Location For Family Living

In a thoroughly unique location, this exciting new development offers exceptional homes for modern family living.

Situated in the highly popular town of Gourock, this selection of semi-detached houses will create 22 new 3-bedroom homes, set exclusively on landscaped grounds that blend new planting with its natural surroundings.

Built on the site of the former McPherson Centre Hospital, the land is set to be regenerated to create a new chapter for this rich historical piece of Scotland.

Located in Inverclyde, the Clyde Valley region boasts great scenery, a vibrant housing market, and great transport links to Glasgow, Argyll & Bute, and beyond to create the perfect environment for homeowners and families.

The development began in 2023, with the first homes ready for handover in late Summer 2023.



Computer Generated Image



Computer Generated Image





A Computer Generated Image of the McPherson development.



A Computer Generated Image example of a bedroom at McPherson Development

Bringing Your Future Home To Life

Through Virtual Reality and 3D Modelling

Rebecchi Architectural has created several additional features to help potential buyers with their customer experience of buying a home at the McPherson Development.

Through the use of virtual reality, interested parties will be able to walk through the layout of the homes to help understand and visualise what the property will look like once built and completed.

Additionally, three-dimensional models have been created of the development and the individual homes to further understand the layout of the homes and the functionality of each property.

planning@rebecchia.com | 01475 634844 | www.rebecchia.com



A 3D Model of the McPherson Development



The Virtual Reality headset





Globe Homes

Delivering Family Homes For Scotland

Globe Homes completed the acquisition of the McPherson Development in Gourrock in March 2022, with the development getting underway in January 2023.

The luxury independent housebuilder has been building bespoke, sustainable, and affordable homes in Central Scotland for the past 20 years.

The McPherson Development marks the first Inverclyde build for the business as it expands across Scotland, with several planned developments in the pipeline.

Globe Homes are also currently developing 24 three, four, and five-bedroom luxury homes at Houston Grove in Renfrewshire.

www.globehomes.info

Houston Grove



View Online



**BOWMAN
REBECCHI**
ESTATE AGENTS

Bowman Rebecchi Estate Agents

West Central Scotland's Property Professionals

Proudly based in Gourock, **Bowman Rebecchi** provides specialist residential and commercial lettings and sales services across west-central Scotland and is the largest independently owned property firm in Inverclyde.

Alongside its residential arm Bowman Rebecchi Letting, a joint venture with Glasgow-based Newton Letting, the group currently manages over 1,200 properties across west and central Scotland.

With branches in Inverclyde and Glasgow, **Bowman Rebecchi Estate Agents** provides an experienced, personable, and professional service for all of the McPherson Development sales.

Independently owned, other businesses within its group include Bowman Rebecchi Commercial, Rebecchi Architectural, and A&M Advertising.

sales@bowreb.com | 01475 639000 (option 2) | www.bowmanrebecchi.com



Bowman Rebecchi Directors at the Gourock Promenade



Bowman Rebecchi Team





Lunderston Bay Beach



Gourrock Outdoor Pool



Gourrock Golf Club

Gourock

The Perfect Family Location To Enjoy

With stunning views, Gourock sits proudly on the south bank of the Firth of Clyde, just 28 miles west of Glasgow and providing a scenic gateway to the best that Scotland can offer.

With its famous outdoor heated pool and variety of traditionally owned shops, Gourock has plenty to enjoy with warm hospitality from the locals.

The town has a rich history, including Castle Levan, a fortified tower house dating from the 14th century. Gourock Golf Club and its indoor development studio and the Royal Gourock Yacht Club are both popular with other landmarks including Castle Mansions and St John's Church, whose distinctive steeple dominates the skyline over Gourock.

There are superb views from Gourock across the Clyde Estuary to the mountains of the southwest Highlands. Visitors can enjoy walks along the promenade toward Lunderston Bay beach. Three miles west of Gourock lies Cloch Point, where there is a lighthouse that dates from 1797.

Regular ferries run from Gourock to Dunoon, Kilcreggan and Helensburgh, with Gourock railway station located at the Pierhead, providing services to Paisley, Glasgow and Wemyss Bay. A number of local bus services connect the town to the surrounding area and Gourock is part of the National Cycle Route 75.



Cardwell Garden Centre



Cafe Continental





Gourock

The Town In More Detail

Gourock is in Inverclyde with a population of just under 11,000 people.

Its development has reflected its location on the River Clyde. Historically activities such as rope making and fish processing took place. Clyde steamers stopped at Gourock (where passengers could transfer to the train) and today it is the headquarters of Caledonian MacBrayne and a ferry port to Dunoon.

Other global businesses include Amazon and Texas Instruments. This type of large town is extremely mixed in terms of demographics. There is a particularly wide range of people, housing and activities. The number of older couples with no children is higher than average.

There is a mix of professional and non-professional jobs, and part-time and self-employment are both important for a significant proportion of residents.

Socioeconomic status is higher than in other kinds of towns in Scotland and there is a mix of professionals and non-professionals.

The secondary school catchment includes Clydeview Academy and St Columba's High School, with primary schools including Gourock Primary and Moorfoot, with several nurseries in close proximity.



[View Online](#)



Remembering Captain Duncan McPherson

Duncan McPherson was born in Inveraray, Argyll on 28th April 1845. His parents were Mary Smith and Alexander McPherson, who had married on 4th July 1844. He had a brother Alexander and by 1851 the family had moved to Gourock.

Duncan was educated at the Gourock Free Church School before following his father into a career at sea. Initially, he worked for his father but then served with William Robertson, the founder of the Gem Shipping Line for 40 years. Duncan gained his captain's certificate when he was relatively young and rose through the ranks, becoming Commodore Skipper of the Fleet & Marine Superintendent, retiring in 1904.

He married Mary Shaw on 18th July 1872 in Coatbridge, Lanarkshire. During his working life, Duncan and Mary lived in Glasgow where you can see Duncan's career progress from master mariner to marine superintendent. They had no children.

Mary died on 23rd December 1892 in Glasgow at the early age of 47. On retirement, Duncan returned to Gourock and lived at Mavis Bank, Ashton Road with the Shaw family – his in-laws.

He became very involved in all kinds of local affairs becoming a Bailie on the local Council. He was Commodore at the Royal Gourock Yacht Club and was involved in several charitable societies as a generous benefactor to many.

A water fountain was donated to the town and for many years was situated at Gourock pier head. It was taken down and lay in storage but in 2005 was re-erected near to the pier not far from its original site. He also gave a flagstaff erected on Tower Hill. The ship on the development logo is the same ship on the fountain at Gourock Gardens at the Pierhead.

Duncan McPherson died on 15th October 1910 and was buried in Gourock Cemetery alongside his parents and brother on 18th October. Such was the esteem that he was held in the town, the shops and schools closed for his funeral in respect.

He was generous in death and as well as family bequests he gave gifts to many local charities, especially ones connected with seafarers and to his local church. Importantly he left money to fund a cottage hospital for the town.

There were many delays in this being built but in June 1925 it was opened by his sister-in-law Jessie Shaw and remained as a hospital until 1979. The building was known as the McPherson Centre, which was a facility for those with special needs. Following the demolition of the building in 2021, the site is set to be transformed into a new housing development by Globe Homes.

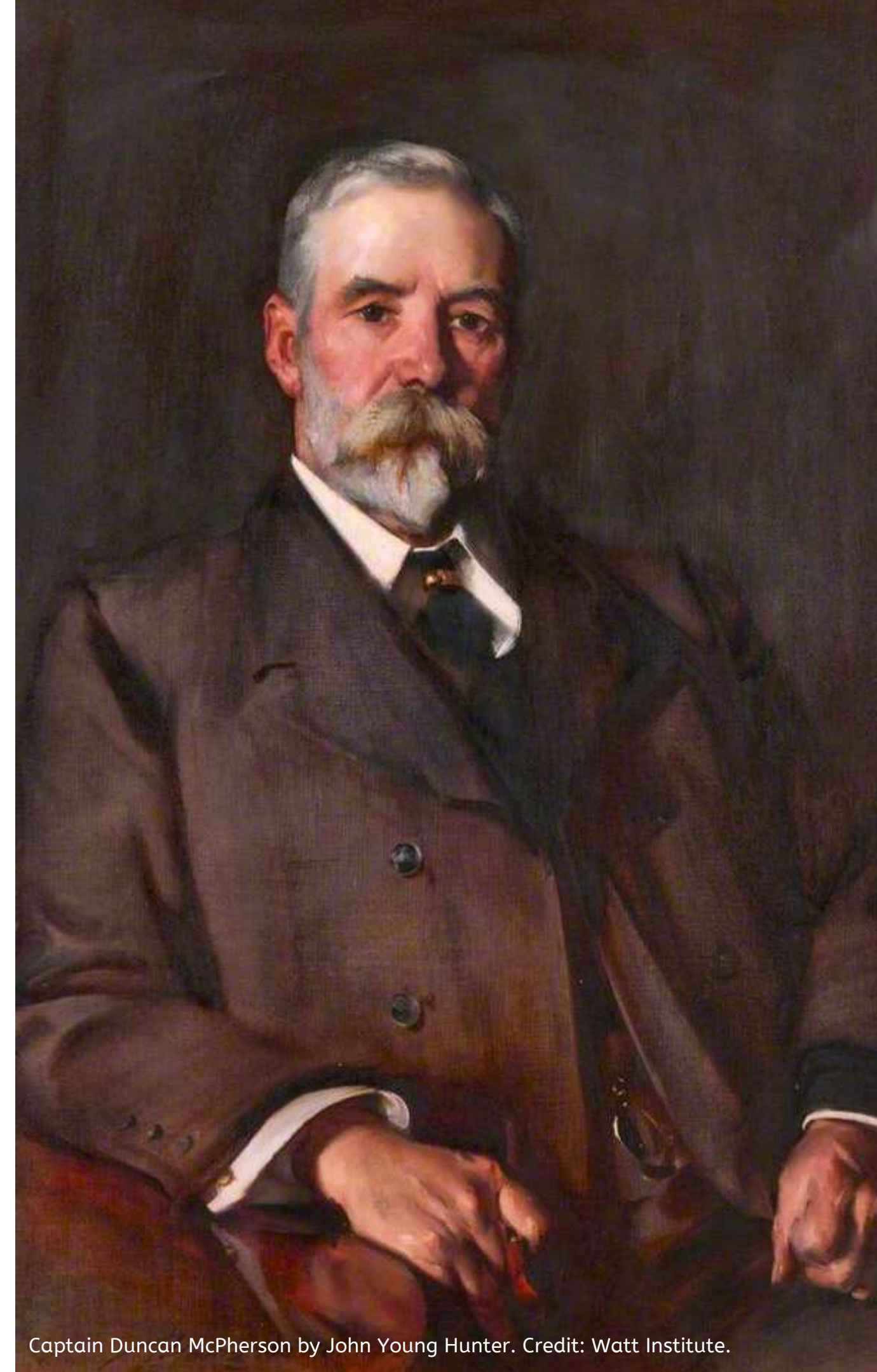

Captain Duncan McPherson by John Young Hunter. Credit: Watt Institute.

Celebrating Captain Duncan McPherson

McPherson Development Masthead

The McPherson Development logo is based on one of the ships that McPherson is believed to have sailed during his illustrious career, where he grew from master mariner to marine superintendent.

A water fountain - donated to the town by McPherson - is still situated at Gourock Gardens at the Pierhead, where the ship can be viewed on the side of the memorial which was re-erected in 2005.

While the ship cannot be verified, it is believed to be part of the Gem Shipping Line fleet, for whom McPherson worked for over a number of years.

Our special thanks go to Paul Dickson for his support in creating this fitting tribute and to The Watt Institute in Greenock for its support in confirming the historical accuracy of Captain McPherson's life.

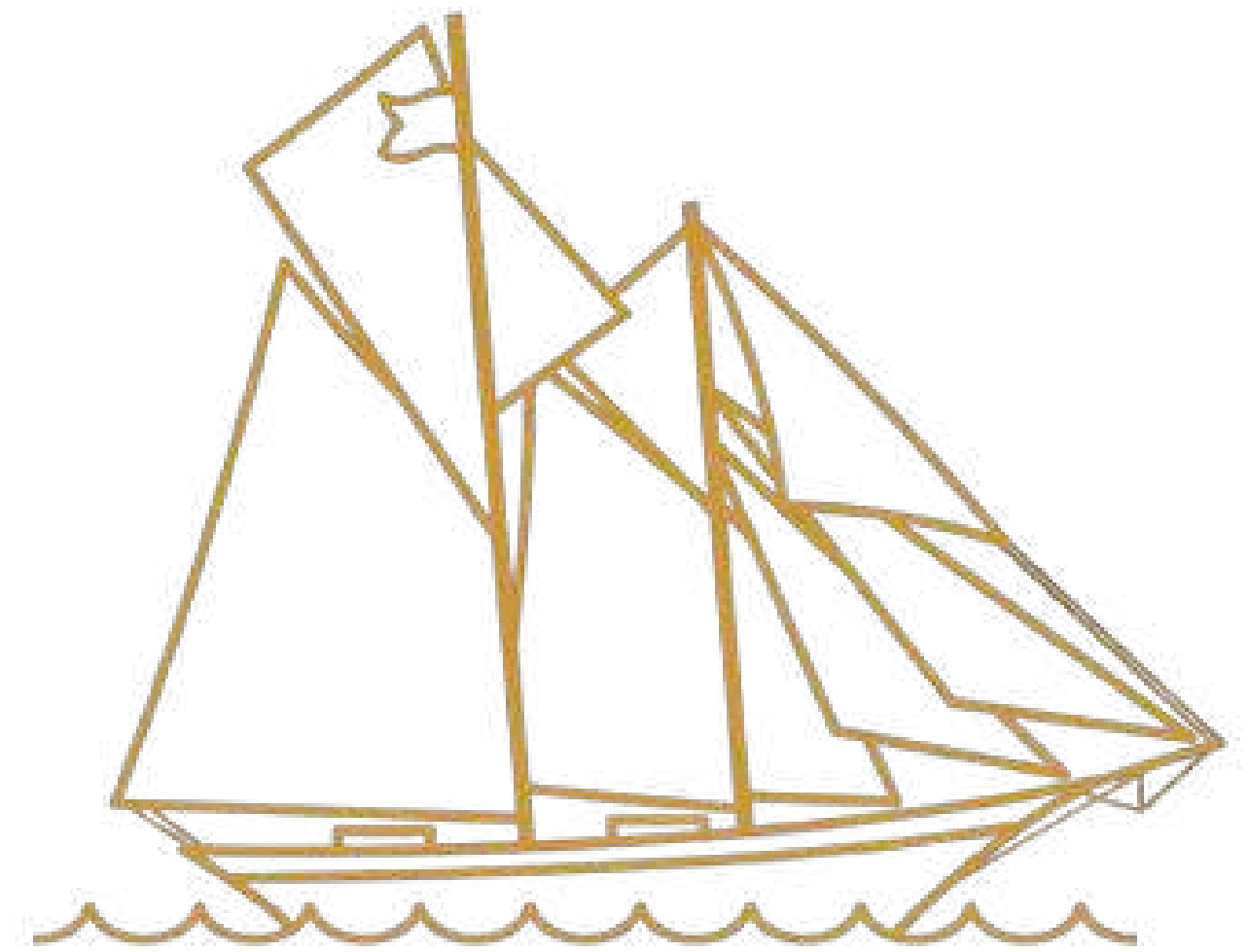





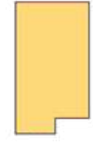

THE MCPHERSON
DEVELOPMENT
— GOUROCK —

Site Layout | Location

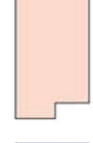

-  The Alexander
-  The Bailie
-  The Duncan
-  The Mavis
-  The Shaw



Development Plan

The Alexander

- Plots 5 & 6.

The Bailie

- Plots 3, 4, 7, 8, 13, 14, 15 & 16.

The Duncan

- Plots 1, 2, 17, 18, 19 & 20.

The Mavis

- Plots 9, 10, 21 & 22.

The Shaw

- Plots 11 & 12.



The Perfect Family Location

McPherson Development, McPherson Drive, Gourock, PA19 1LJ



Local Area

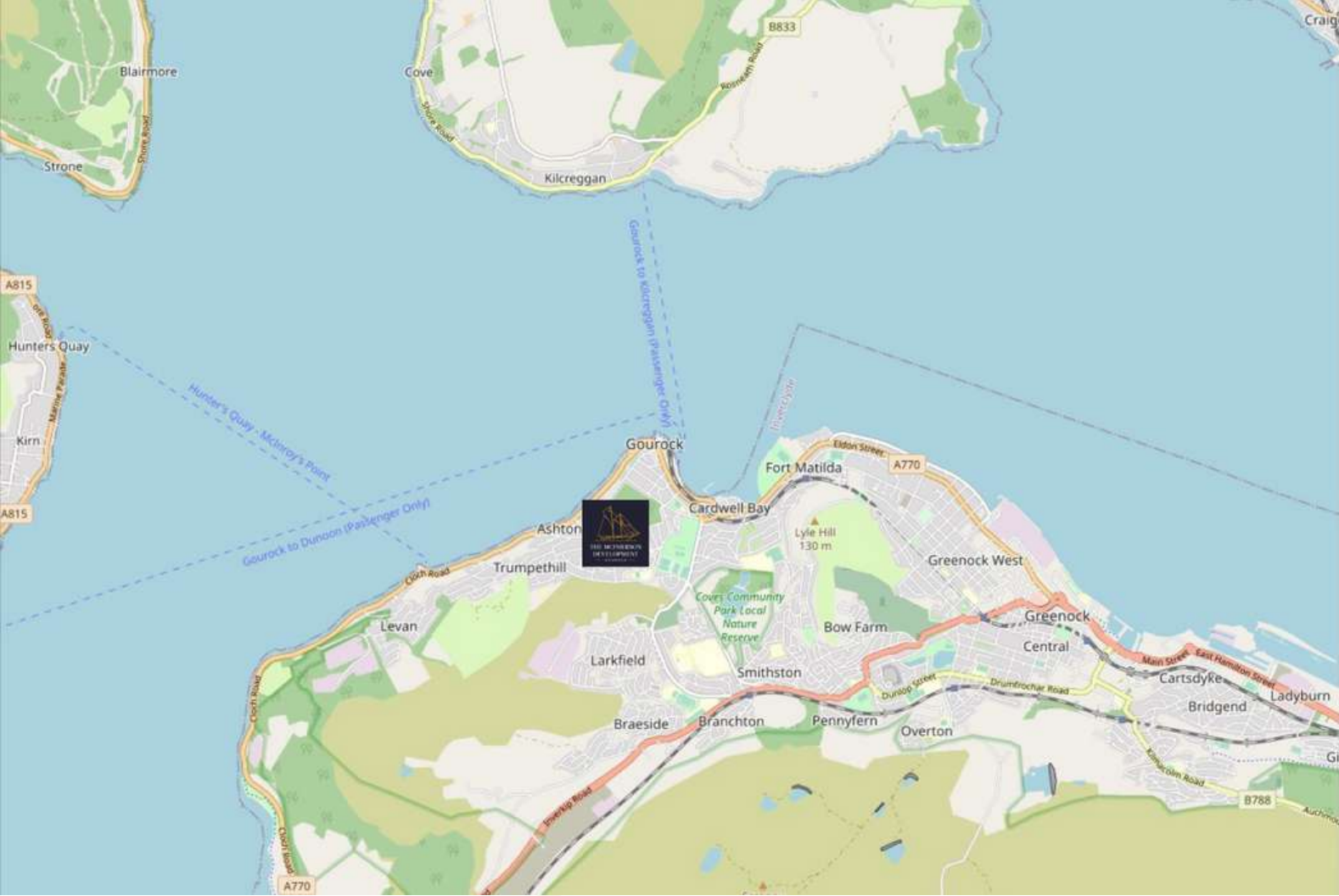

Regional Map

THE MCPHERSON

[View Online](#)





THE MCPHERSON
DEVELOPMENT
— GOUROCK —

Specification | House Types

Property Specification

External Finishes

- Low-maintenance uPVC windows
- Low-maintenance soffit and fascia panels
- Designated parking areas - McPherson Drive
- Private Driveway
- Facing brick and render
- Facing brick retaining walls - McPherson Drive

Kitchen

- Prestigious kitchen supplier
- Each contemporary designed kitchen is fully integrated offering a choice of stylish high-quality fittings
- Splashback to hob

High-Quality Appliances

- Integrated Stainless steel single oven
- Gas hob - 4 zones
- Integrated Fridge/freezer
- Integrated Dishwasher
- Integrated Washer Dryer
- Stainless steel extractor over the hob

Wardrobes

- Contemporary designed sliding wardrobes
- Fitted with internal shelf and hanging rail

Bathroom & En-Suite

- Prestigious Sanitaryware
- Contemporary chrome taps
- Contemporary shower enclosure to ensuite (electric shower)

Tiling

- Walls - Porcelanosa tiling to WHB splashback
- Walls - Porcelanosa half height around bath
- Walls - Porcelanosa tiling to shower enclosure

Electrical

- Ample power points throughout
- TV points - lounge
- Telephone point
- Recessed downlights to the hallway, kitchen, bathroom, and en-suite
- Energy-saving pendant light fittings elsewhere

Plumbing & Heating

- Gas central heating
- High-efficiency combination boiler
- Thermostatic control radiators fitted throughout
- Temperature Control both levels
- Chrome heated towel rail to bathroom and en-suite

Internal Doors

- Contemporary white doors
- Contemporary chrome/satin handles

Decoration

- Walls emulsion finish - sail white
- Ceilings emulsion finish - white
- Woodwork satin finish - sail white

Safety/Security

- Smoke and heat detector alarms - mains connected
- Co2 detectors - mains connected
- All alarms are to be interlinked

External

- Common landscaped public green spaces
- Gardens levelled to maximise surrounding views
- Topsoil to rear gardens
- Turf to front gardens
- Paving slabs side and rear
- 1.8m timber fencing
- EV Charging Point for each property

Property Management

- A property company shall be appointed as Managing Agent for the development.

Warranty

- Each property will be covered by a 10-year fully insured warranty.



THE MCPHERSON
DEVELOPMENT
— GOUROCK —

The Alexander

3 Bedroom
Semi-Detached
Home



View Online

Computer Generated Image



THE MCPHERSON
DEVELOPMENT
— GOUROCK —

The Alexander

3 Bedroom
Semi-Detached
Home

Plots 5 & 6



View Online

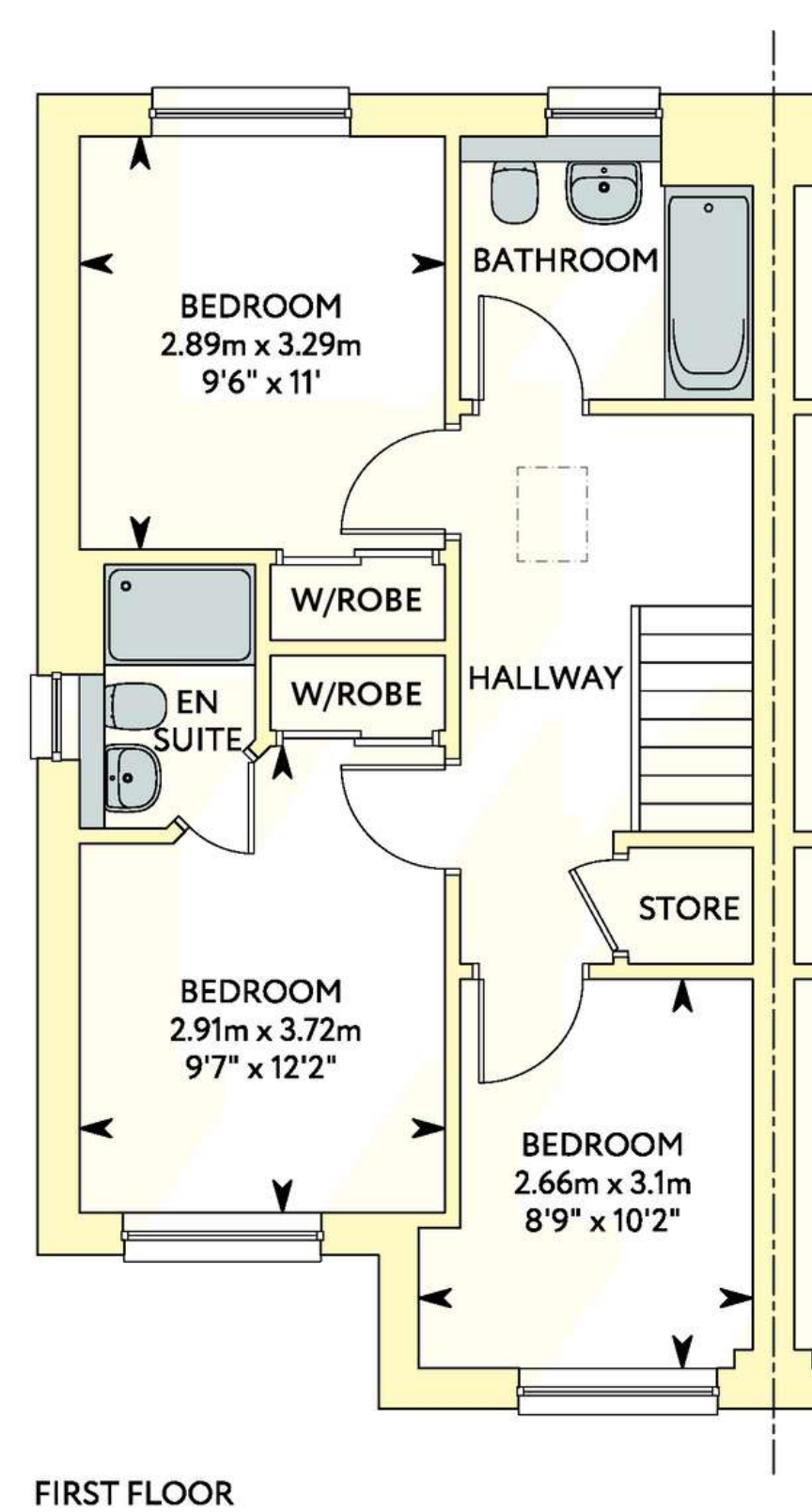
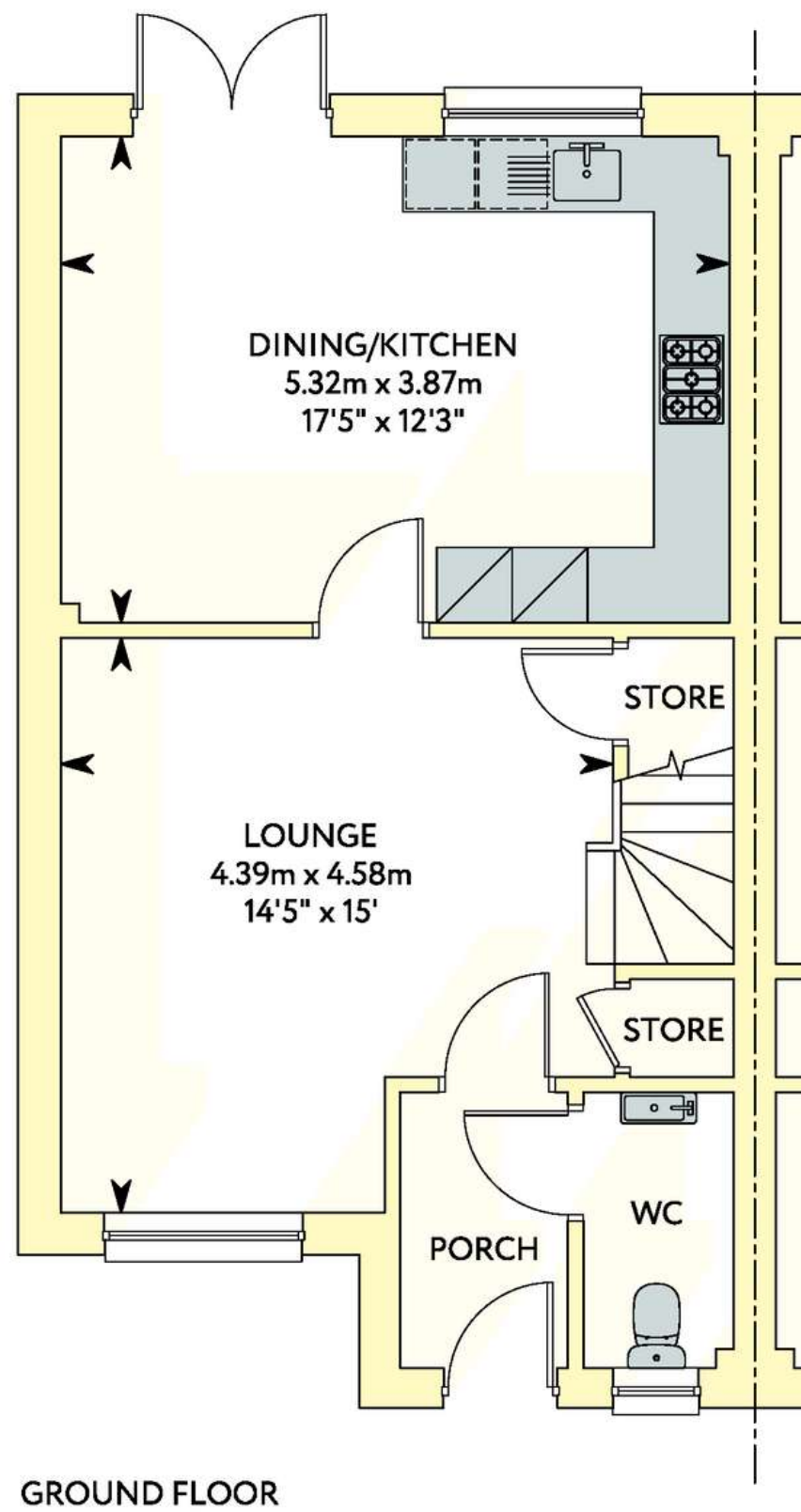

PLEASE NOTE - The Consumer Protection from Unfair Trading Regulations 2008. Bowman Rebecchi Residential Sales Limited, t/a Bowman Rebecchi Estate Agents (BREA), operates a policy of continual product development and the specifications outlined in this brochure are indicative only. The shadows outline the natural sunlight and for any clarity please contact BREA for further details.

BREA reserve the right to implement minor changes to the sizes and specifications shown on any plans or drawings in this brochure without warning. Where alterations to the design, construction or materials to be used in the construction of the property would materially alter the internal floor space, appearance, or market value of the property, we will ensure that these changes are communicated to potential purchasers.

While these particulars are prepared with all due care for the convenience of intending purchasers, the information is intended as a guide. The computer-generated images and photographs do not necessarily represent the actual finishings/elevation or treatments, landscaping, furnishings, and fittings at this development.

Floor plans, dimensions, and specifications are correct at the time of print. The illustrated location map is a general guide only. Nothing contained in this brochure shall constitute or form part of any contract. Information contained in this brochure is accurate at the time of going to press on 09.05.23. Bowman Rebecchi Residential Sales Limited is a limited company registered in Scotland. Registration number: SC723481.



THE MCPHERSON
DEVELOPMENT
— GOUROCK —

The Bailie

3 Bedroom
Semi-Detached
Home



[View Online](#)



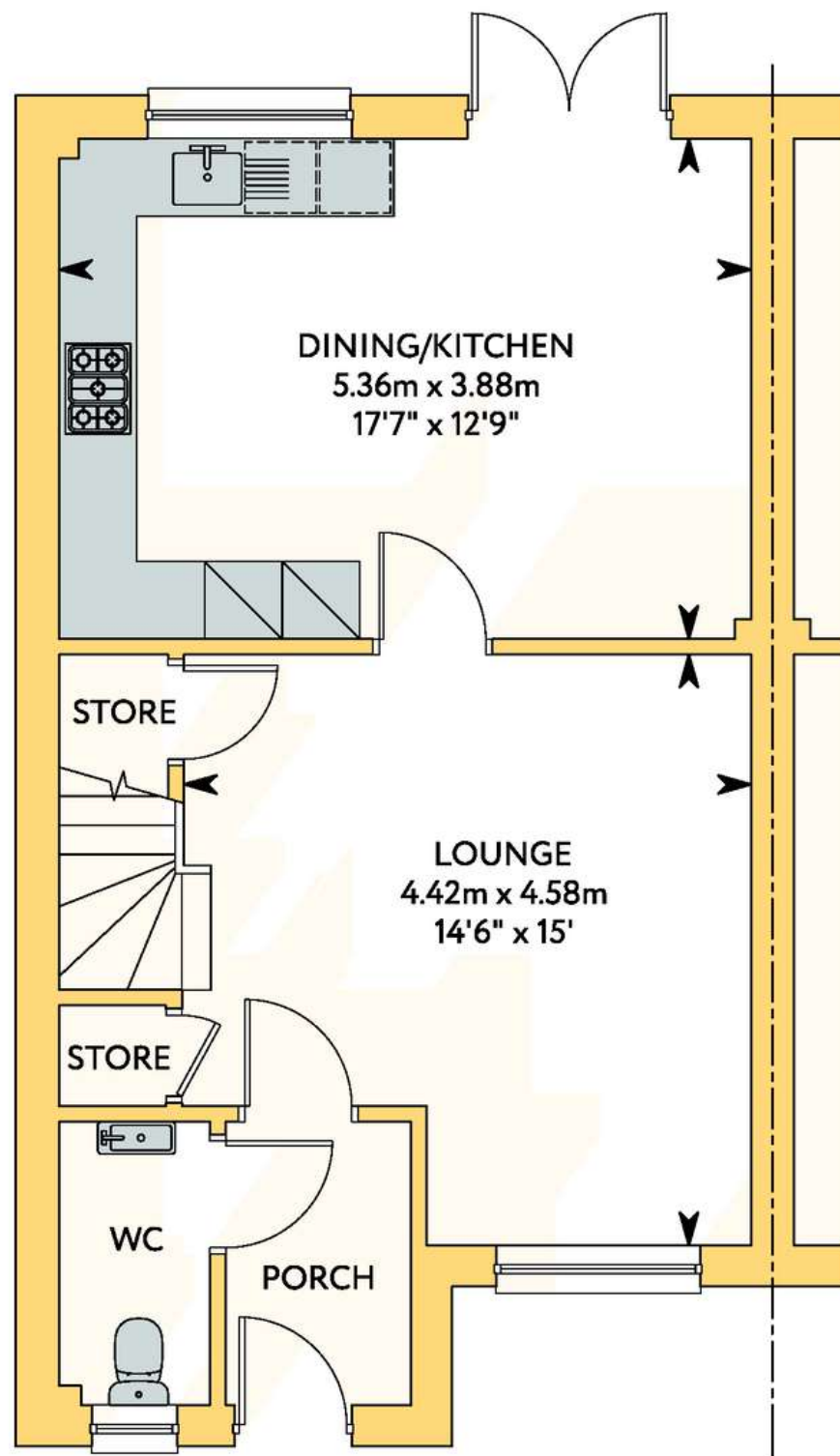

GROUND FLOOR

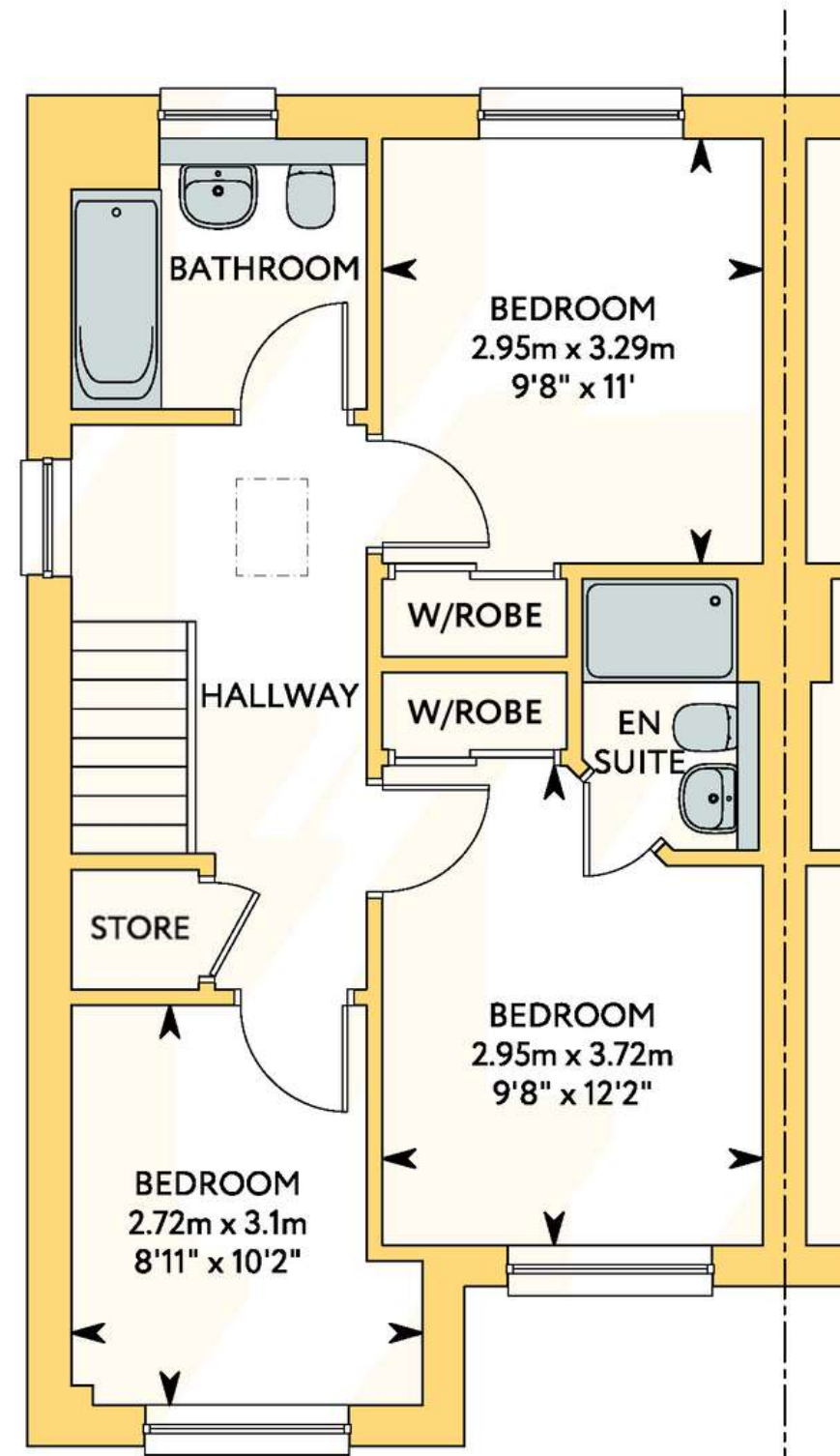

FIRST FLOOR



THE MCPHERSON DEVELOPMENT
— GOUROCK —

The Bailie

3 Bedroom
Semi-Detached
Home

Plots 3, 4, 7, 8, 13, 14,
15 & 16



[View Online](#)

PLEASE NOTE - The Consumer Protection from Unfair Trading Regulations 2008. Bowman Rebecchi Residential Sales Limited, t/a Bowman Rebecchi Estate Agents (BREA), operates a policy of continual product development and the specifications outlined in this brochure are indicative only. The shadows outline the natural sunlight and for any clarity please contact BREA for further details.

BREA reserve the right to implement minor changes to the sizes and specifications shown on any plans or drawings in this brochure without warning. Where alterations to the design, construction or materials to be used in the construction of the property would materially alter the internal floor space, appearance, or market value of the property, we will ensure that these changes are communicated to potential purchasers.

While these particulars are prepared with all due care for the convenience of intending purchasers, the information is intended as a guide. The computer-generated images and photographs do not necessarily represent the actual finishings/elevation or treatments, landscaping, furnishings, and fittings at this development.

Floor plans, dimensions, and specifications are correct at the time of print. The illustrated location map is a general guide only. Nothing contained in this brochure shall constitute or form part of any contract. Information contained in this brochure is accurate at the time of going to press on 09.05.23. Bowman Rebecchi Residential Sales Limited is a limited company registered in Scotland. Registration number: SC723481.



THE MCPHERSON
DEVELOPMENT
— GOUROCK —

The Duncan

3 Bedroom
Semi-Detached
Home



[View Online](#)



THE MCPHERSON
DEVELOPMENT
— GOUROCK —

The Duncan

3 Bedroom
Semi-Detached
Home

Plots 1, 2, 17, 18, 19 &
20



[View Online](#)

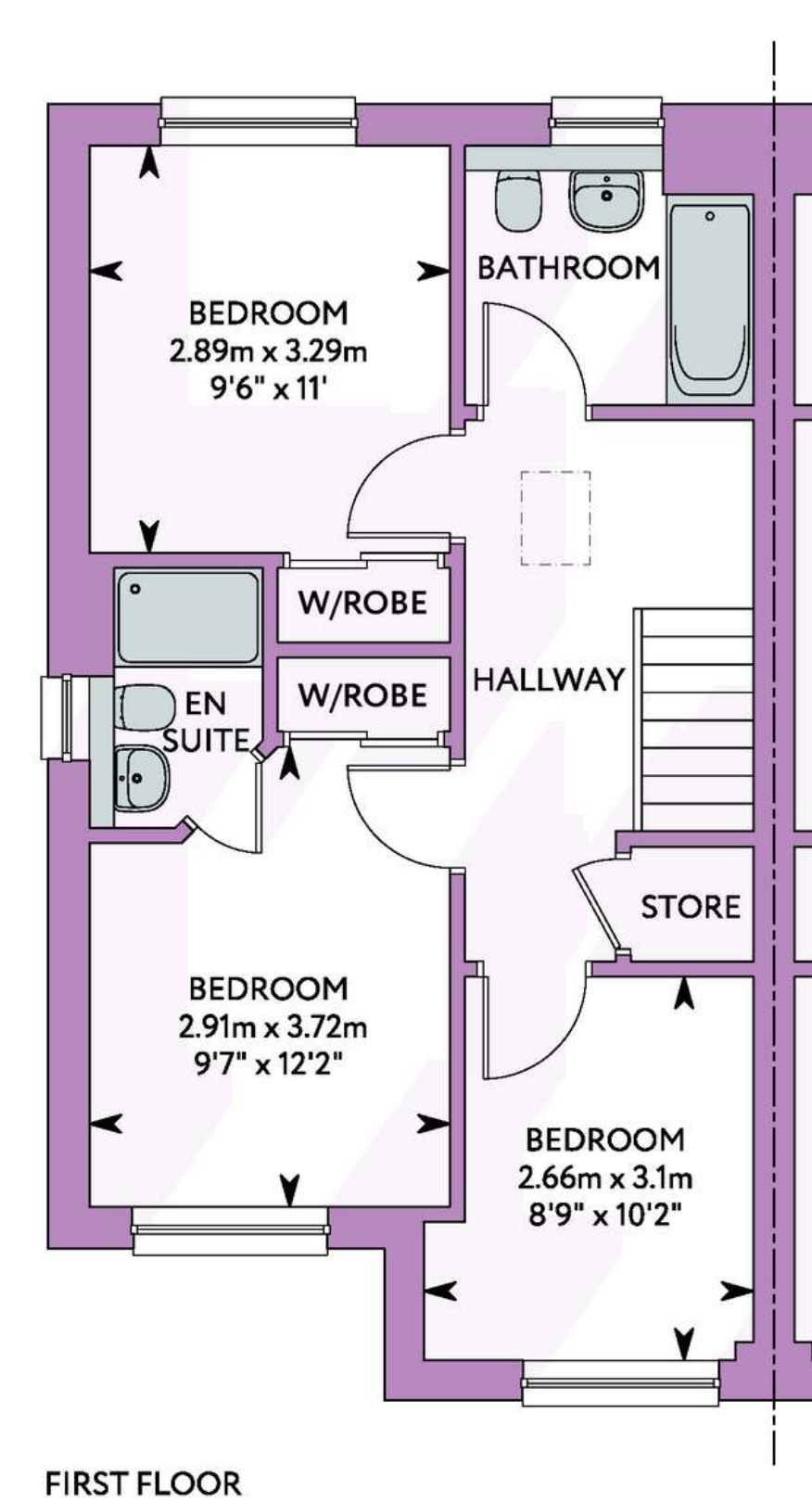
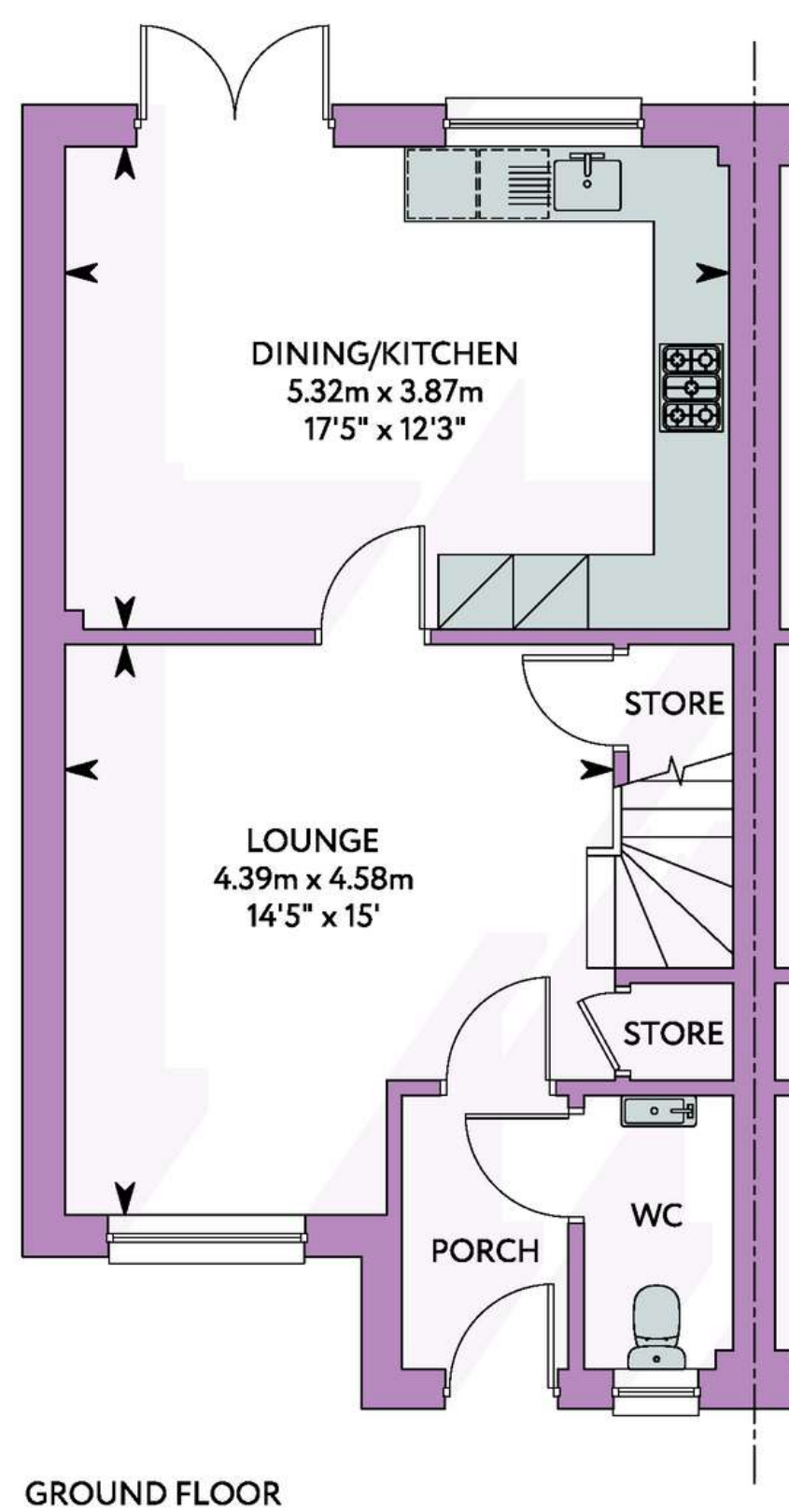

PLEASE NOTE - The Consumer Protection from Unfair Trading Regulations 2008. Bowman Rebecchi Residential Sales Limited, t/a Bowman Rebecchi Estate Agents (BREA), operates a policy of continual product development and the specifications outlined in this brochure are indicative only. The shadows outline the natural sunlight and for any clarity please contact BREA for further details.

BREA reserve the right to implement minor changes to the sizes and specifications shown on any plans or drawings in this brochure without warning. Where alterations to the design, construction or materials to be used in the construction of the property would materially alter the internal floor space, appearance, or market value of the property, we will ensure that these changes are communicated to potential purchasers.

While these particulars are prepared with all due care for the convenience of intending purchasers, the information is intended as a guide. The computer-generated images and photographs do not necessarily represent the actual finishings/elevation or treatments, landscaping, furnishings, and fittings at this development.

Floor plans, dimensions, and specifications are correct at the time of print. The illustrated location map is a general guide only. Nothing contained in this brochure shall constitute or form part of any contract. Information contained in this brochure is accurate at the time of going to press on 09.05.23. Bowman Rebecchi Residential Sales Limited is a limited company registered in Scotland. Registration number: SC723481.



THE MCPHERSON
DEVELOPMENT
— GOUROCK —

The Mavis

3 Bedroom
Semi-Detached
Home



View Online



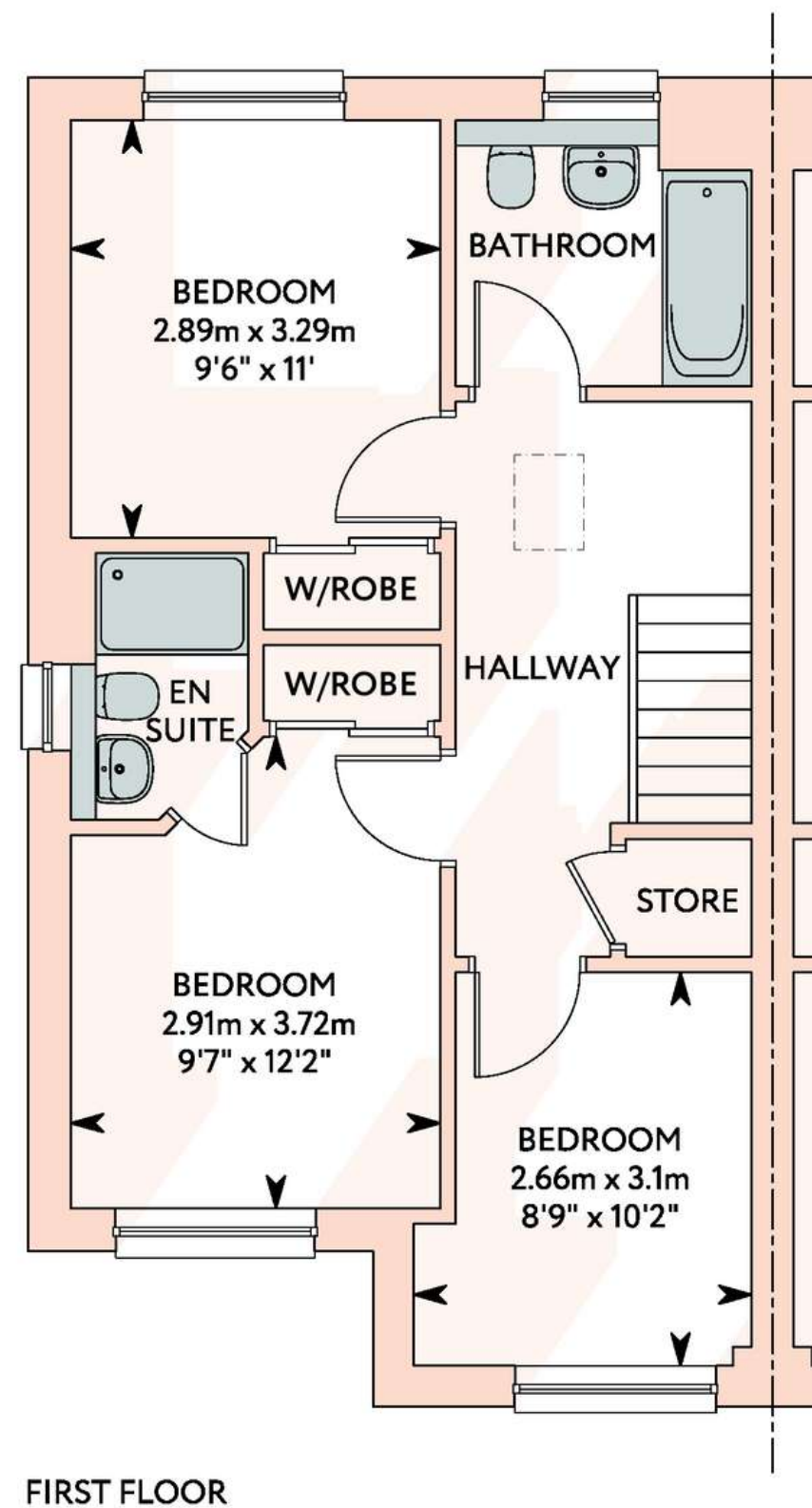
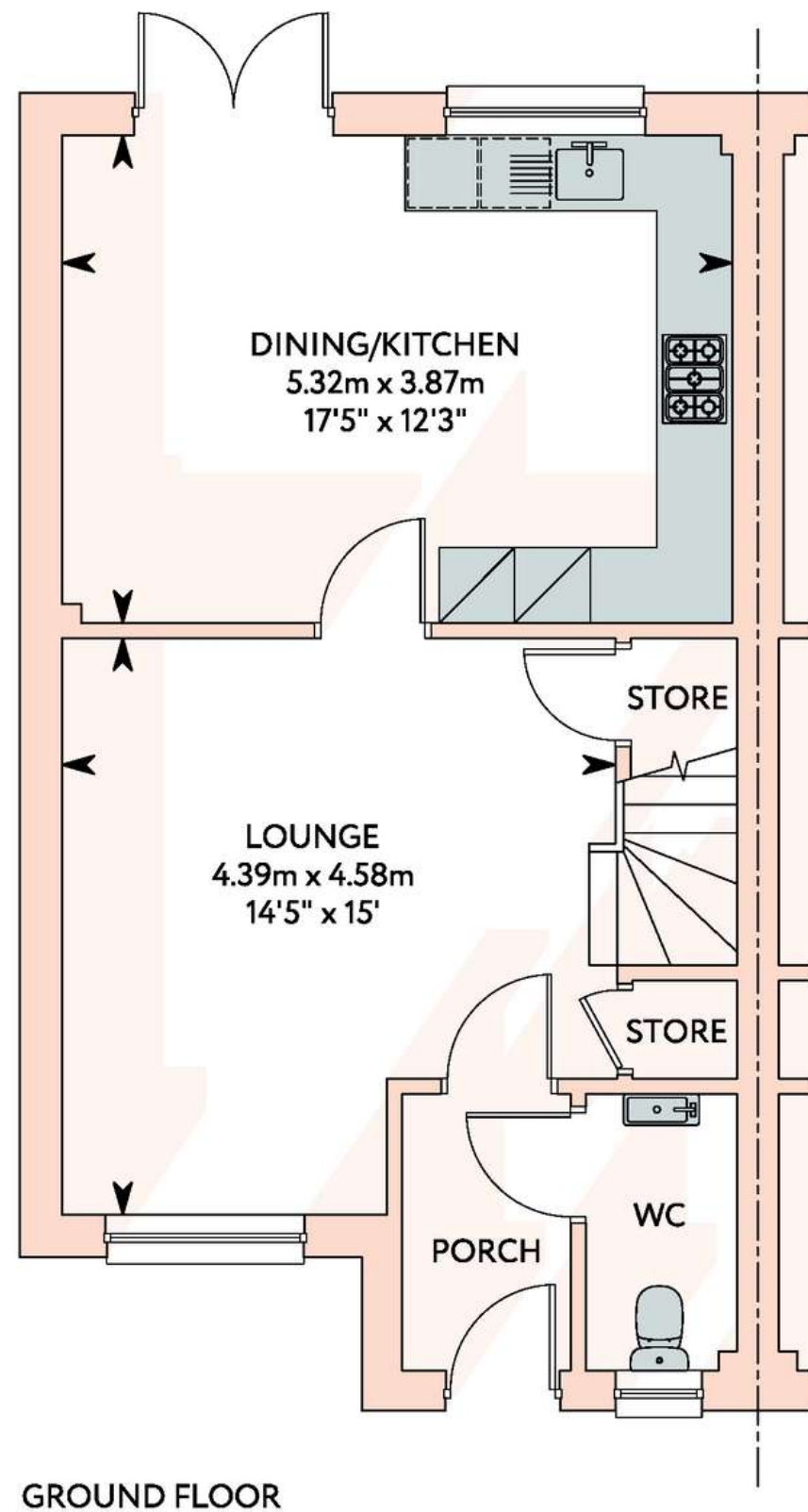

THE MCPHERSON DEVELOPMENT
 — GOUROCK —

The Mavis

3 Bedroom
 Semi-Detached
 Home

Plots 9, 10, 21 & 22

PLEASE NOTE - The Consumer Protection from Unfair Trading Regulations 2008. Bowman Rebecchi Residential Sales Limited, t/a Bowman Rebecchi Estate Agents (BREA), operates a policy of continual product development and the specifications outlined in this brochure are indicative only. The shadows outline the natural sunlight and for any clarity please contact BREA for further details.

BREA reserve the right to implement minor changes to the sizes and specifications shown on any plans or drawings in this brochure without warning. Where alterations to the design, construction or materials to be used in the construction of the property would materially alter the internal floor space, appearance, or market value of the property, we will ensure that these changes are communicated to potential purchasers.

While these particulars are prepared with all due care for the convenience of intending purchasers, the information is intended as a guide. The computer-generated images and photographs do not necessarily represent the actual finishings/elevation or treatments, landscaping, furnishings, and fittings at this development.

Floor plans, dimensions, and specifications are correct at the time of print. The illustrated location map is a general guide only. Nothing contained in this brochure shall constitute or form part of any contract. Information contained in this brochure is accurate at the time of going to press on 09.05.23. Bowman Rebecchi Residential Sales Limited is a limited company registered in Scotland. Registration number: SC723481.



[View Online](#)



THE MCPHERSON
DEVELOPMENT
— GOUROCK —

The Shaw

3 Bedroom
Semi-Detached
Home



[View Online](#)



THE MCPHERSON
DEVELOPMENT
— GOUROCK —

The Shaw

3 Bedroom
Semi-Detached
Home

Plots 11 & 12



[View Online](#)

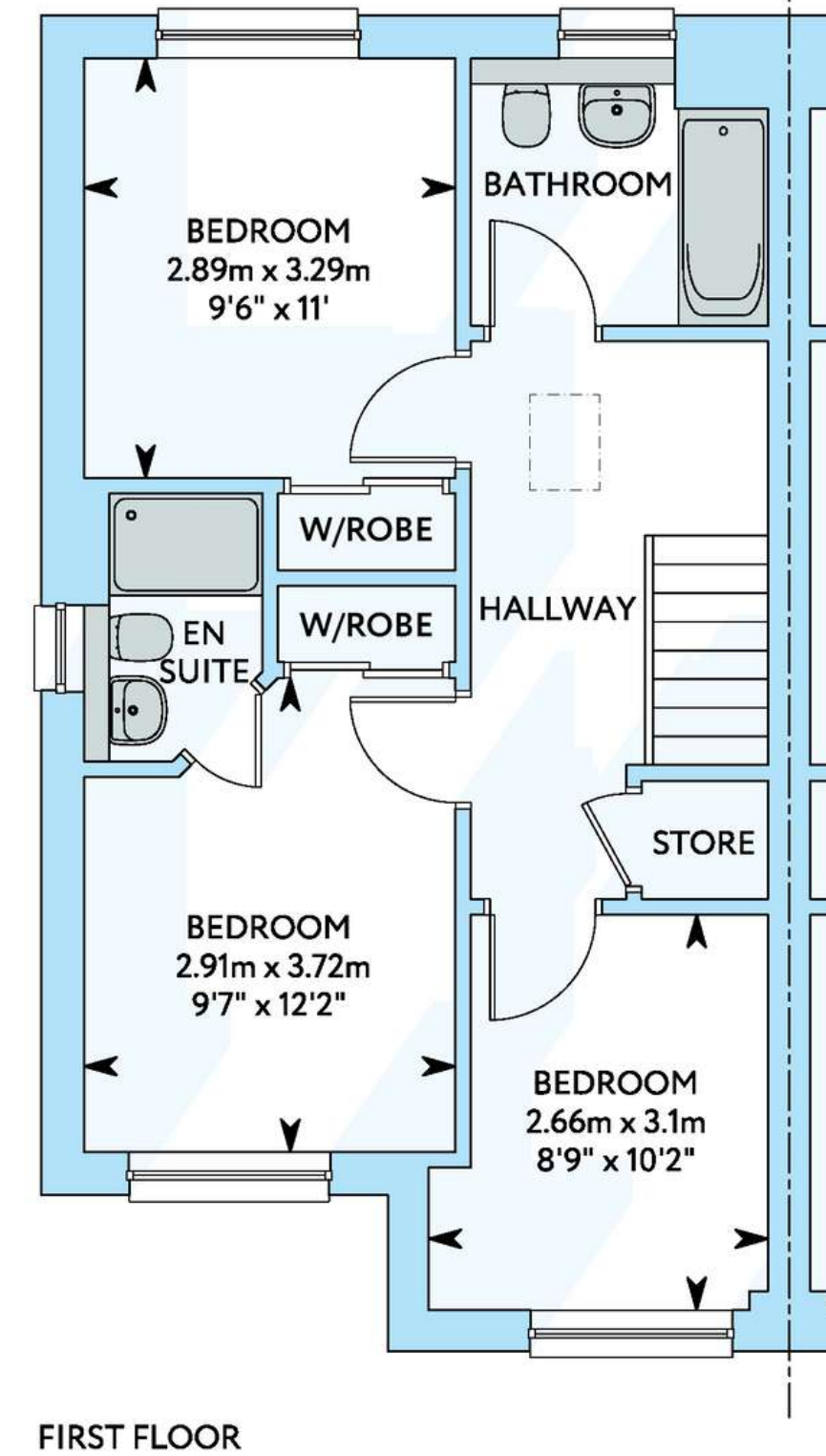
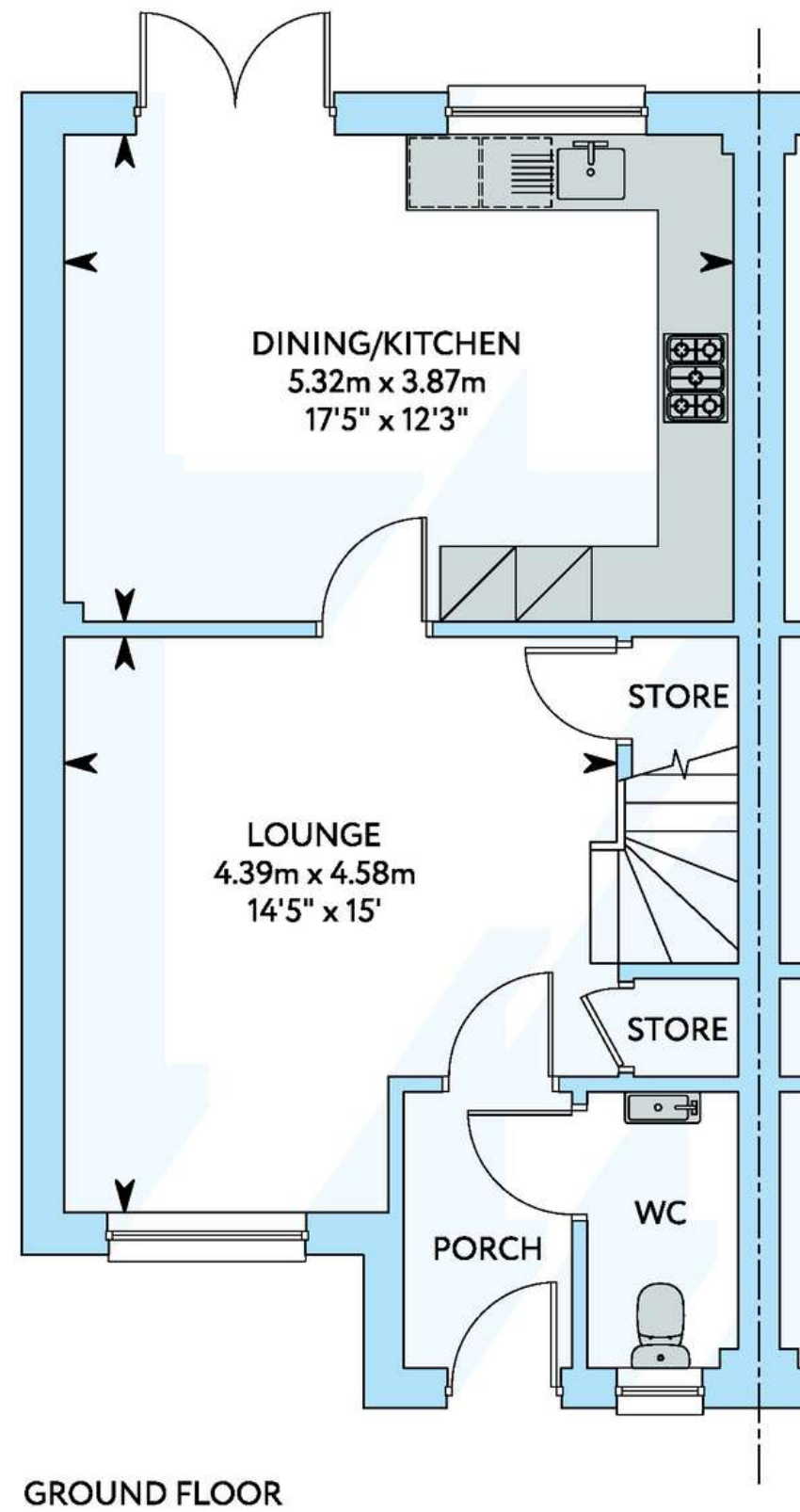

PLEASE NOTE - The Consumer Protection from Unfair Trading Regulations 2008. Bowman Rebecchi Residential Sales Limited, t/a Bowman Rebecchi Estate Agents (BREA), operates a policy of continual product development and the specifications outlined in this brochure are indicative only. The shadows outline the natural sunlight and for any clarity please contact BREA for further details.

BREA reserve the right to implement minor changes to the sizes and specifications shown on any plans or drawings in this brochure without warning. Where alterations to the design, construction or materials to be used in the construction of the property would materially alter the internal floor space, appearance, or market value of the property, we will ensure that these changes are communicated to potential purchasers.

While these particulars are prepared with all due care for the convenience of intending purchasers, the information is intended as a guide. The computer-generated images and photographs do not necessarily represent the actual finishings/elevation or treatments, landscaping, furnishings, and fittings at this development.

Floor plans, dimensions, and specifications are correct at the time of print. The illustrated location map is a general guide only. Nothing contained in this brochure shall constitute or form part of any contract. Information contained in this brochure is accurate at the time of going to press on 09.05.23. Bowman Rebecchi Residential Sales Limited is a limited company registered in Scotland. Registration number: SC723481.





BOWMAN REBECCHI

— ESTATE AGENTS —

Reserve Your New Home Today

www.bowmanrebecchi.com

01475 639000 | sales@bowreb.com

Suite 2, 32-36 Kempock Street, Gourock, PA19 1NA

Tile Selection - Ceramic Wall Tiles



PARK GRIS
25 x 44.3 cm
Grout: Gris



PARK BLANCO
25 x 44.3 cm
Grout: Blanco



BALI NIEVE
25 x 44.3 cm
Grout: Blanco



SHINE PLATINO
25 x 44.3 cm
Grout: Blanco



BOTTEGA CALIZA
25 x 44.3 cm
Grout: Gris

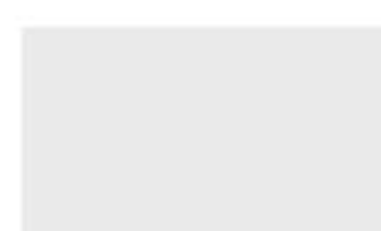

CRYSTAL WHITE (gloss)
25 x 44.3 cm
Grout: Blanco



FONTANA BLANCO (gloss)
25 x 44.3 cm
Grout: Blanco



JAPAN BLANCO
25 x 44.3 cm
Grout Blanco



JAPAN MARINE
25 x 44.3 cm
Grout: Cemento



INDIC (matte)
25 x 44.3 cm
Grout: Gris



SHINE NIQUEL
25 x 44.3 cm
Grout: Blanco



BOTTEGA ACERO
25 x 44.3 cm
Grout: Manhattan



GLACIER BLANCO (matte)
25 x 44.3 cm
Grout: Blanco



IMAGE SILVER
25 x 44.3 cm
Grout: Gris



MADAGASCAR BLANCO
25 x 44.3 cm
Grout: Blanco



MADAGASCAR NATURAL
25 x 44.3 cm
Grout: Gris



SHINE ALUMINIO
25 x 44.3 cm
Grout: Manhattan



SHINE DARK
25 x 44.3 cm
Grout: Antracita



IMAGE WHITE
25 x 44.3 cm
Grout: Blanco



RIVOLI BLANCO (matte)
25 x 44.3 cm
Grout: Blanco



Tile Selection – Ceramic Floor Tiles



NAST BLANCO
44.3 x 44.3 cm
Grout: Gris



NAST GREY
44.3 x 44.3 cm
Grout: Gris



NANTES ACERO
44.3 x 44.3 cm
Grout: Manhattan



PARK GRIS
44.3 x 44.3 cm
Grout: Cemento



PARK BLANCO
44.3 x 44.3 cm
Grout: Gris



FERROKER DARK
44.3 x 44.3 cm
Grout: Antracita



FERROKER PLATINO
44.3 x 44.3 cm
Grout: Gris



MADAGASCAR BLANCO
44.3 x 44.3 cm
Grout: Gris



RIVOLI BLANCO (matte)
44.3 x 44.3 cm
Grout: Gris



BALI NIEVE
44.3 x 44.3 cm
Grout: Gris



NOVA BLANCO
44.3 x 44.3 cm
Grout: Gris



BOTTEGA WHITE
44.3 x 44.3 cm
Grout: Gris



BUTAN BONE
44.3 x 44.3 cm
Grout: Gris



DOVER CALIZA
44.3 x 44.3 cm
Grout: Gris



FERROKER ALUMINIO
44.3 x 44.3 cm
Grout: Manhattan



FERROKER NIQUEL
44.3 x 44.3 cm
Grout: Gris



RODANO ACERO
44.3 x 44.3 cm
Grout: Manhattan



MARMOL GRIS
44.3 x 44.3 cm
Grout: Cemento



ALMERIA BLANCO
44.3 x 44.3 cm
Grout: Gris



JAPAN BLANCO
44.3 x 44.3 cm
Grout: Gris



BOTTEGA CALIZA
44.3 x 44.3 cm
Grout: Gris



DOVER ACERO
44.3 x 44.3 cm
Grout: Cemento



IMAGE SILVER
44.3 x 44.3 cm
Grout: Gris



CARRARA BLANCO BRILLO
44.3 x 44.3 cm
Grout: Gris



INDIC (matte)
44.3 x 44.3 cm
Grout: Gris



RODANO CALIZA
44.3 x 44.3 cm
Grout: Gris



BRINDISI
44.3 x 44.3 cm
Grout: Gris



JAPAN MARINE
44.3 x 44.3 cm
Grout: Cemento



NANTES CALIZA
44.3 x 44.3 cm
Grout: Gris



BOTTEGA ACERO
44.3 x 44.3 cm
Grout: Cemento



IMAGE WHITE
44.3 x 44.3 cm
Grout: Gris



IMAGE DARK
44.3 x 44.3 cm
Grout: Antracita



FONTANA BLANCO
44.3 x 44.3 cm
Grout: Gris



MADAGASCAR NATURAL
44.3 x 44.3 cm
Grout: Gris



RODANO TAUPE
44.3 x 44.3 cm
Grout: Gris



The McPherson Development - Tile Selection



Ceramic Floor Tiles

Ceramic Wall Tiles



NAST BLANCO
44.3 x 44.3 cm
Grout: Gris



NANTES ACERO
44.3 x 44.3 cm
Grout: Manhattan



DOVER ACERO
44.3 x 44.3 cm
Grout: Cemento



FERROKER ALUMINIO
44.3 x 44.3 cm
Grout: Manhattan



MADAGASCAR BLANCO
44.3 x 44.3 cm
Grout: Gris



JAPAN BLANCO
44.3 x 44.3 cm
Grout: Gris



NOVA BLANCO
44.3 x 44.3 cm
Grout: Gris



PARK GRIS
25 x 44.3 cm
Grout: Gris



PARK BLANCO
25 x 44.3 cm
Grout: Blanco



BALI NIEVE
25 x 44.3 cm
Grout: Blanco



SHINE PLATINO
25 x 44.3 cm
Grout: Blanco



BOTTEGA CALIZA
25 x 44.3 cm
Grout: Gris



BALI NIEVE
44.3 x 44.3 cm
Grout: Gris



BOTTEGA WHITE
44.3 x 44.3 cm
Grout: Gris



IMAGE WHITE
44.3 x 44.3 cm
Grout: Gris



CARRARA BLANCO BRILLO
44.3 x 44.3 cm
Grout: Gris



RODANO ACERO
44.3 x 44.3 cm
Grout: Manhattan



BUTAN BONE
44.3 x 44.3 cm
Grout: Gris



PARK GRIS
44.3 x 44.3 cm
Grout: Cemento



JAPAN BLANCO
25 x 44.3 cm
Grout: Blanco



JAPAN MARINE
25 x 44.3 cm
Grout: Cemento



INDIC (matte)
25 x 44.3 cm
Grout: Gris



SHINE NIQUEL
25 x 44.3 cm
Grout: Blanco



BOTTEGA ACERO
25 x 44.3 cm
Grout: Manhattan



ALMERIA BLANCO
44.3 x 44.3 cm
Grout: Gris



BOTTEGA CALIZA
44.3 x 44.3 cm
Grout: Gris



PARK BLANCO
44.3 x 44.3 cm
Grout: Gris



FONTANA BLANCO
44.3 x 44.3 cm
Grout: Gris



RODANO CALIZA
44.3 x 44.3 cm
Grout: Gris



FERROKER DARK
44.3 x 44.3 cm
Grout: Antracita

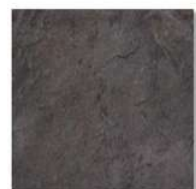

IMAGE DARK
44.3 x 44.3 cm
Grout: Antracita



MADAGASCAR BLANCO
25 x 44.3 cm
Grout: Blanco



MADAGASCAR NATURAL
25 x 44.3 cm
Grout: Gris



SHINE ALUMINIO
25 x 44.3 cm
Grout: Manhattan



SHINE DARK
25 x 44.3 cm
Grout: Antracita



IMAGE WHITE
25 x 44.3 cm
Grout: Blanco



JAPAN MARINE
44.3 x 44.3 cm
Grout: Cemento



BOTTEGA ACERO
44.3 x 44.3 cm
Grout: Cemento



DOVER CALIZA
44.3 x 44.3 cm
Grout: Gris



FERROKER PLATINO
44.3 x 44.3 cm
Grout: Gris



RODANO TAUPE
44.3 x 44.3 cm
Grout: Gris



MADAGASCAR NATURAL
44.3 x 44.3 cm
Grout: Gris



INDIC (matte)
44.3 x 44.3 cm
Grout: Gris



CRYSTAL WHITE (gloss)
25 x 44.3 cm
Grout: Blanco



GLACIER BLANCO (matte)
25 x 44.3 cm
Grout: Blanco



RIVOLI BLANCO (matte)
25 x 44.3 cm
Grout: Blanco



FONTANA BLANCO (gloss)
25 x 44.3 cm
Grout: Blanco



IMAGE SILVER
25 x 44.3 cm
Grout: Gris



NAST GREY
44.3 x 44.3 cm
Grout: Gris



NANTES CALIZA
44.3 x 44.3 cm
Grout: Gris



IMAGE SILVER
44.3 x 44.3 cm
Grout: Gris



FERROKER NIQUEL
44.3 x 44.3 cm
Grout: Gris



RIVOLI BLANCO (matte)
44.3 x 44.3 cm
Grout: Gris



BRINDISI
44.3 x 44.3 cm
Grout: Gris



MARMOL GRIS
44.3 x 44.3 cm
Grout: Cemento