







## PROPERTY DESCRIPTION

				
Living rooms	Bedrooms	Bathrooms	Car Park	Area
1	2	1	N/A	1,201 sq ft

Delightful houseboat located in the Millwall Inner Dock in Canary Wharf offering plenty of natural light as well as stunning views of the Dock and Canary Wharf.



Spanning over 1200 sq ft, the houseboat offers open plan reception and dining area with modern kitchen on the middle deck, two bedrooms (currently used as offices), a bathroom and storage unit. Further benefits are infrared heaters, air conditioning, security system, motion-activated lighting and a hot tub situated on the upper deck.

The boat is fully connected to all services on the dockside and has Dedicated 100Mbps fibre broadband and ethernet cabling.

Ideally located in Canary Wharf, the houseboat is only a short walk from South Quay DLR and Canary Wharf Underground Stations for easy access to West End, Stratford and the City.



## TRANSPORT LINKS & JOURNEY TIMES

South Quay DLR		1 min
Canary Wharf DLR/Underground		7 min

## TERMS

Local Authority:	Tower Hamlets London Borough Council
Tenure:	Commercial lease with Canal & Rivers Trust: Next renewal due on 14/10/2025



Approximate Gross Internal Area  
111.6 sq m / 1201 sq ft

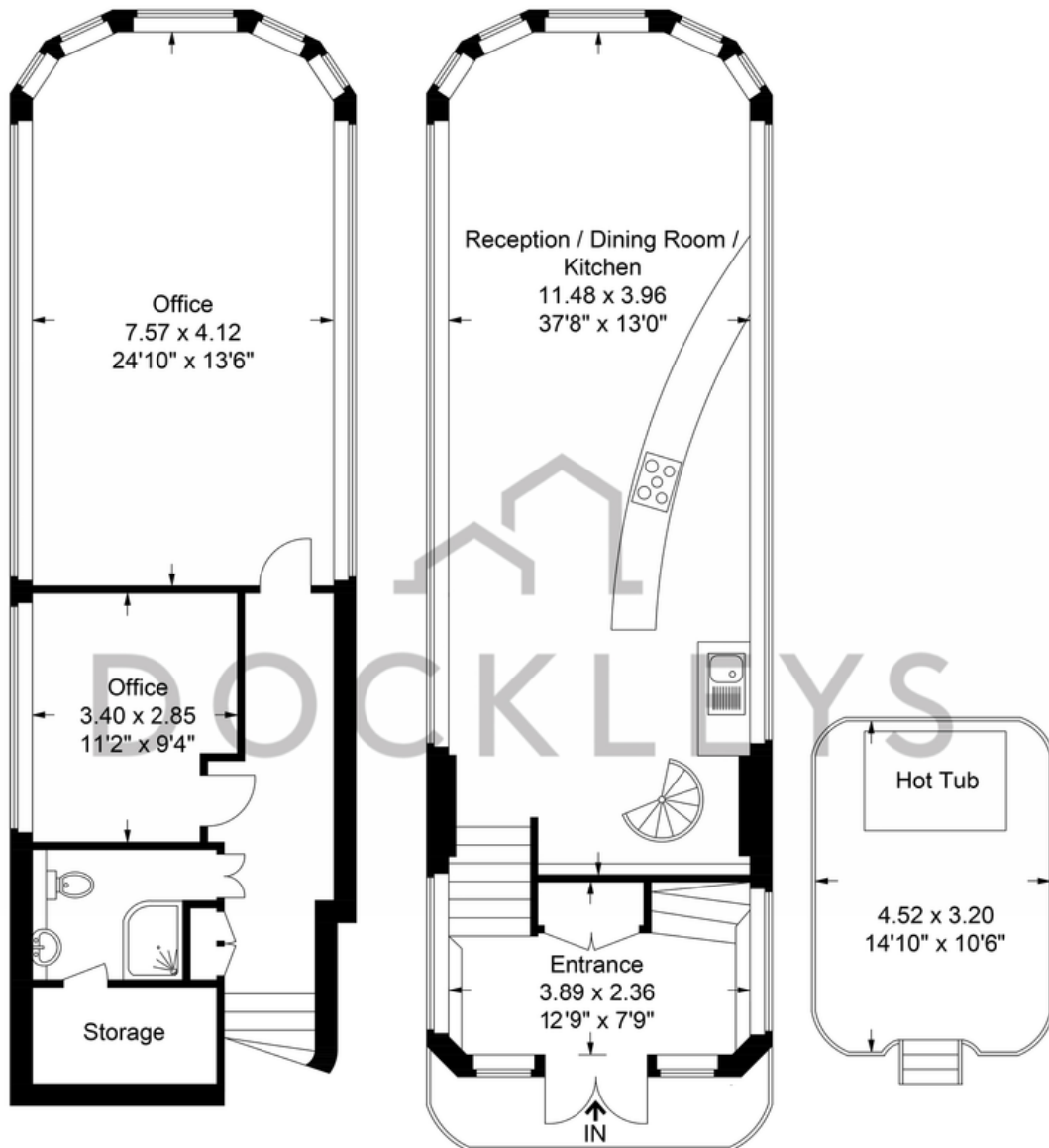

Lower Deck

Middle Deck

Upper Deck

The floor plan is not to scale and measurements and are as shown are approximate and therefore should be used for illustrative purposes only. The plan has been prepared in accordance with the RICS code of measuring practice and whilst we have confidence in the information produced, it must not be relied on.

If there is any aspect of particular importance, you should carry out or commission your inspection of the property.

Copyright of Maison Photography Ltd