

# Milestone

## RESIDENTIAL

CELEBRATING 125 YEARS

22 Church Road, Ashford, TW15 2UY

T: 01784 800322

E: [enquiries@milestone-residential.com](mailto:enquiries@milestone-residential.com)

### **Fleetwood Court, Douglas Road, Staines-Upon-Thames, TW19 7JN**



**Asking Price £120,000 Leasehold**



**An excellent opportunity for the first time buyer or rental investor to purchase this large ground floor studio flat with lounge/bedroom , separate kitchen and bathroom just moments from both Heathrow airport and Ashford hospital. No forward chain.**

## FOR SALE

This pleasant and large ground floor studio flat is set in delightful, landscaped grounds features an entrance hall with generous storage cupboards leading into the spacious lounge/bedroom and separate kitchen and bathroom. Residents parking and No Forward Chain.

## LOCATION

Perfect location for the first time buyer or investor on the edge of attractive Stanwell Village and close proximity to Heathrow and Ashford Hospital. The M25 is close by as is Staines shopping centre.

Approximate Gross Internal Area 349 sq ft – 32 sq m

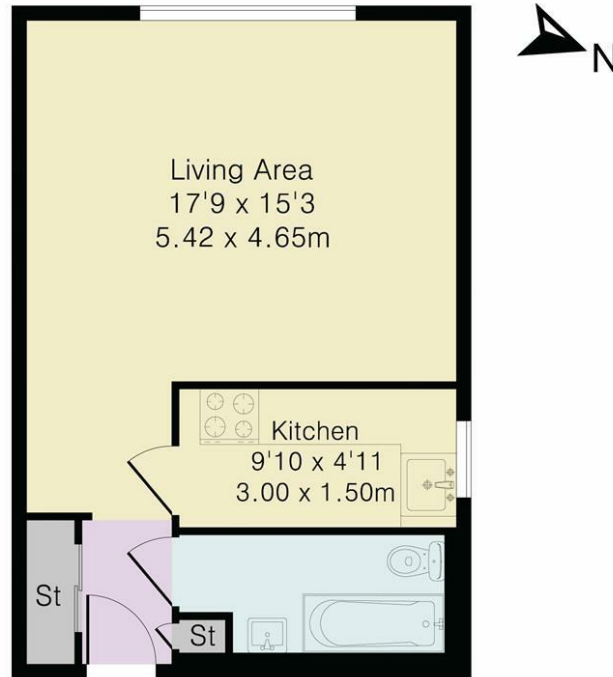

Ground Floor



Although Pink Plan Ltd ensures the highest level of accuracy, measurements of doors, windows and rooms are approximate and no responsibility is taken for error, omission or misstatement. These plans are for representation purposes only as defined by RICS code of measuring practise. No guarantee is given on total square footage of the property within this plan. The figure icon is for initial guidance only and should not be relied on as a basis of valuation.



ESTABLISHED 1890

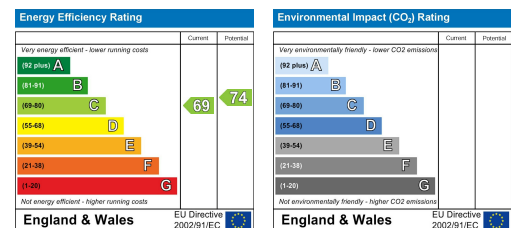

It is our aim to provide particulars that are both accurate and reliable but they are not guaranteed and would not form part of any offer or contract. Please contact us if you require clarification and we would be happy to assist. Please also note that the appliances and heating system have not been tested and therefore, no warranties can be given as to their condition.