







Adam Hayes - Finchley Central Office - Lettings 348 Regents Park Road, Finchley Central, London, N3 2LJ  
Tel: 0208 189 6333 Email: [info@adam-hayes.co.uk](mailto:info@adam-hayes.co.uk) Web: [www.adam-hayes.co.uk](http://www.adam-hayes.co.uk)

Cyprus Road, Finchley Central, N3 3RY

£1,550 PCM

 1 Bedrooms  1 Bathrooms  1 Receptions

## Key Features

- One Bedroom Conversion
- Modern Kitchen and Bathroom
- Approx. 19ft Lounge
- Easy Access to Tube
- Close To Shops

## Other Information

Council Tax Band: B  
Length of Tenancy: Long Let  
Deposit: £1,785

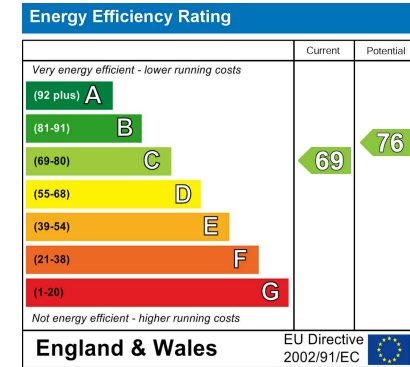

## Nearest Stations

- Finchley Central

## Property Description

This stylish and modern one-bedroom first-floor conversion is ideally located in a highly sought-after area, providing convenient access to local shops, amenities, and Finchley Central Tube Station (Northern Line). The property features a generous 19ft lounge with a chic open-plan fitted kitchen, a contemporary bathroom, gas central heating, and double glazing throughout. Residents will also enjoy the close proximity to an array of restaurants, cafes, shopping facilities, and beautiful open spaces. An internal viewing is highly recommended to fully appreciate the fantastic location and exceptional condition of this property!

Adam Hayes - Finchley Central Office - Lettings 348 Regents Park Road, Finchley Central, London, N3 2LJ

Tel: 0208 189 6333 Email: [info@adam-hayes.co.uk](mailto:info@adam-hayes.co.uk) Web: [www.adam-hayes.co.uk](http://www.adam-hayes.co.uk)

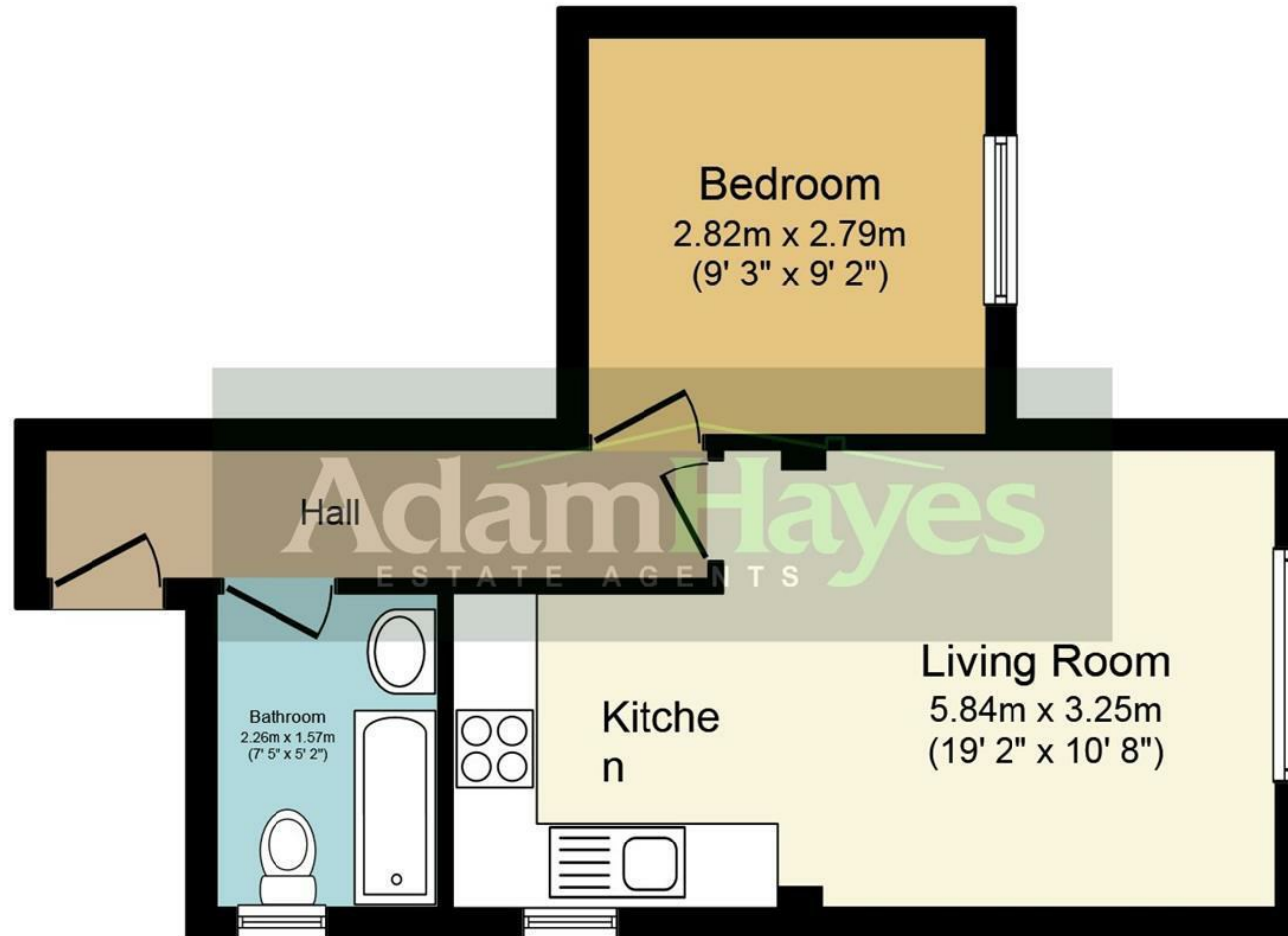

## Floor Plan

Total floor area 34.0 sq. m. (366 sq. ft.) approx

This plan is for illustration purposes only and may not be representative of the property. Plan not to scale.

These particulars, whilst believed to be accurate, are set out as a general outline only for guidance and do not constitute any part of an offer or contract. Intending purchasers or prospective tenants should not rely on them as statements or representation of fact, but must satisfy themselves by inspection or otherwise as to their accuracy. We have not carried out a detailed survey, not tested the services, appliances and specific fittings. Room sizes should not be relied upon for carpets and furnishings. The measurements given are approximate. No person in this firm's employment has the authority to make or give any representation or warranty in respect of the property.