

Adam Hayes - Finchley Central Office - Lettings 348 Regents Park Road, Finchley Central, London, N3 2LJ
Tel: 0208 189 6333 Email: info@adam-hayes.co.uk Web: www.adam-hayes.co.uk

Elm Park Road, London, N3 1EB

£1,700 PCM

 1 Bedrooms  1 Bathrooms  1 Receptions

Key Features

- One Bedroom Maisonette
- Ground Floor Flat
- Modern Kitchen
- Great Location
- Excellent Condition
- Direct Access To A Shared Garden

Nearest Stations

- West Finchley
- Finchley Central

Property Description

Conveniently located in a residential turning off Nether Street, this well-presented one-bedroom ground-floor maisonette offers an excellent combination of comfort and convenience. Situated within walking distance of both Finchley Central and West Finchley Tube Stations, this property ensures easy access to the wider area and local amenities. Inside, you'll find a spacious 18ft living room that seamlessly integrates with a modern open-plan kitchen, creating a contemporary and inviting living environment. The design maximizes space and light, providing a welcoming area perfect for relaxation and entertaining. Practical features include double glazing and gas central heating, which together ensure comfort throughout the year. A standout feature of this property is direct access to the shared garden. This delightful maisonette is particularly well-suited for singles or couples seeking a comfortable home with easy access to local shops, services, and transport links. To fully appreciate the size, location, and condition of this property, an internal viewing is highly recommended. Viewings can be arranged through the landlord's sole agent Adam Hayes Estate Agents.

Other Information

Council Tax Band: C
Length of Tenancy: Long Let
Deposit: £1,960
EPC: TBC

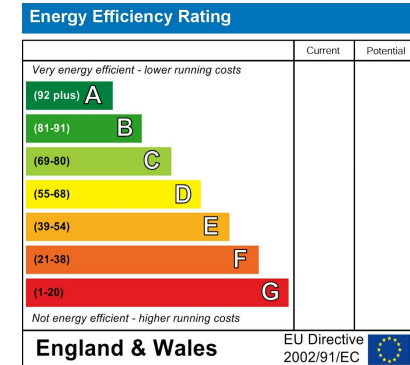

Adam Hayes - Finchley Central Office - Lettings 348 Regents Park Road, Finchley Central, London, N3 2LJ

Tel: 0208 189 6333 Email: info@adam-hayes.co.uk Web: www.adam-hayes.co.uk

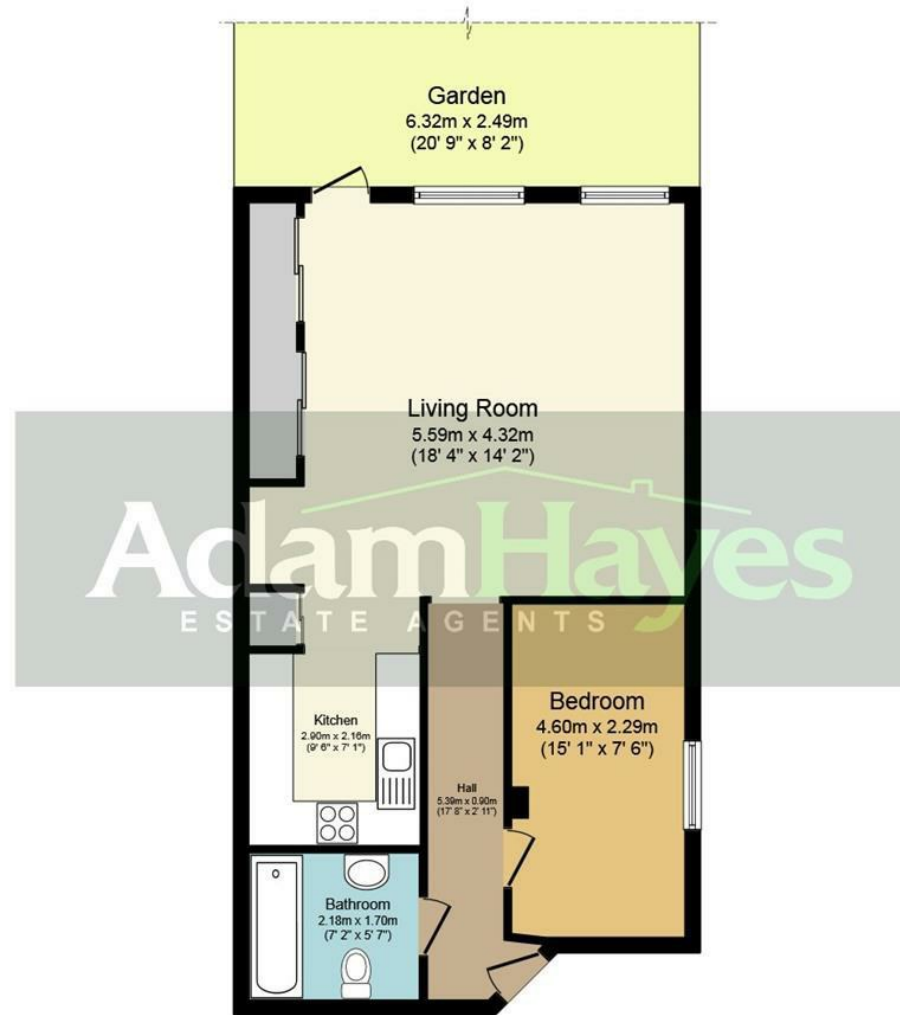

AclamHayes
ESTATE AGENTS

Floor Plan

Total floor area 49.6 sq. m. (533.8 sq. ft.) approx

This plan is for illustration purposes only and may not be representative of the property. Plan not to scale.

These particulars, whilst believed to be accurate, are set out as a general outline only for guidance and do not constitute any part of an offer or contract. Intending purchasers or prospective tenants should not rely on them as statements or representation of fact, but must satisfy themselves by inspection or otherwise as to their accuracy. We have not carried out a detailed survey, not tested the services, appliances and specific fittings. Room sizes should not be relied upon for carpets and furnishings. The measurements given are approximate. No person in this firm's employment has the authority to make or give any representation or warranty in respect of the property.