

705, Tellicherry Court London, E14 0XA

£2,200

- One Double bedroom
- 24 Hour Concierge
- Air conditioning
- 7th Floor with City Views
- Residents Gym
- Fully Furnished
- King Size Bed

Tellicherry Court, E14

Approx. Gross Internal Area 569 Sq Ft - 52.86 Sq M
Approx. Gross Balcony Area 75 Sq Ft - 6.97 Sq M

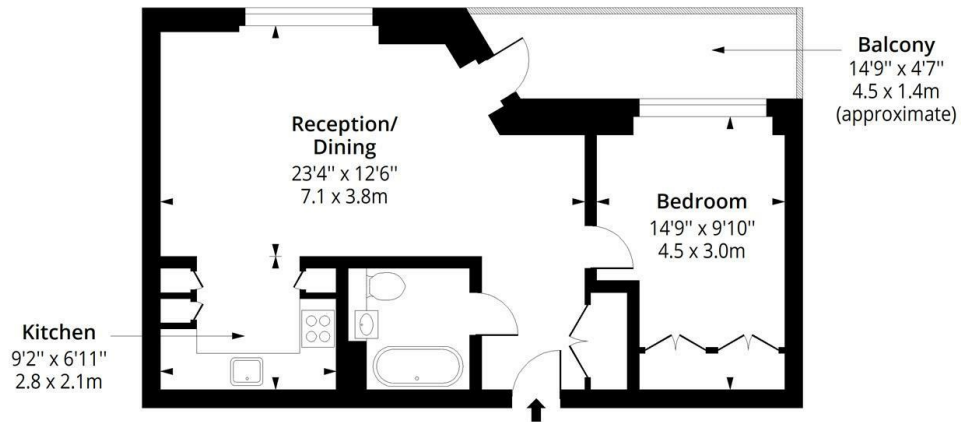

Seventh Floor

Floor Area 569 Sq Ft - 52.86 Sq M



Measured according to RICS IPMS2. Floor plan is for illustrative purposes only and is not to scale. Every attempt has been made to ensure the accuracy of the floor plan shown, however all measurements, fixtures, fittings and data shown are an approximate interpretation for illustrative purposes only. 1 sq m = 10.76 sq feet.

lpaplus.com

Date: 5/9/2025

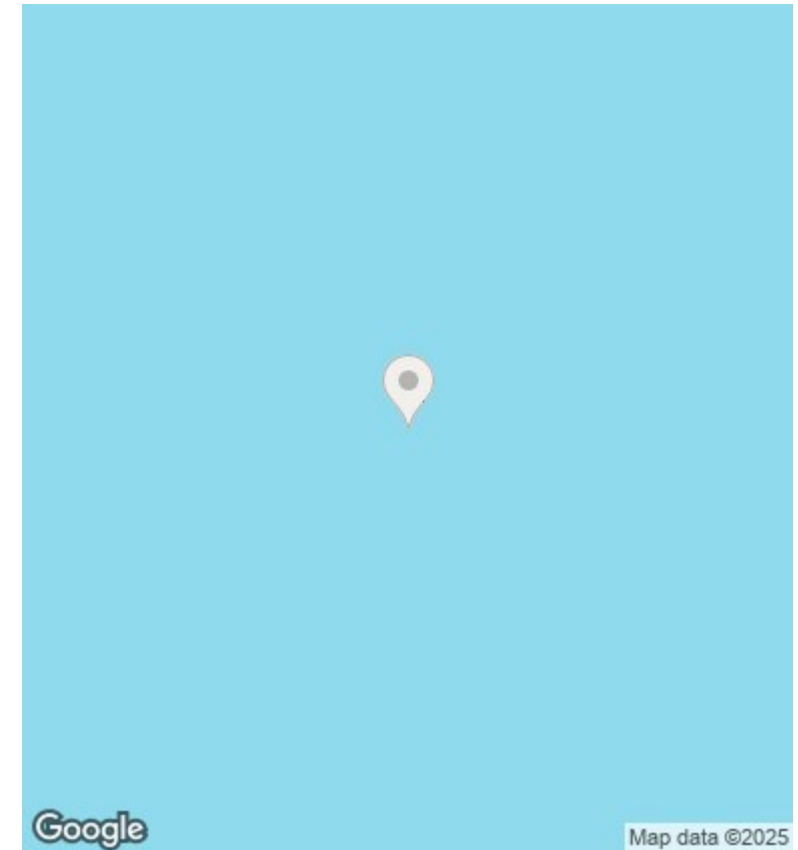

Directions

Viewings

Viewings by arrangement only. Call 0208 075 4927 to make an appointment.

Council Tax Band

EPC Rating:

Energy Efficiency Rating		
	Current	Potential
Very energy efficient - lower running costs		
(92 plus) A		
(81-91) B		
(69-80) C		
(55-68) D		
(39-54) E		
(21-38) F		
(1-20) G		
Not energy efficient - higher running costs		
England & Wales	EU Directive 2002/91/EC	