



PR 
PROPERTY

5 Sorrel Close, Luton, Bedfordshire, LU3 4AE
£1,275 PCM

- PR Property lettings
- Allocated parking space
- Sainsburys & Schools Close By

- Available to Let now
- Gas central heating
- 2 good sized bedrooms

- Private Rear Garden
- Park Views

**** Exclusive to PR Property **** A bright two-bedroom house in Bramingham. Both bedrooms are good sized, making this an ideal rental for a small family or professionals wanting comfortable sleeping space and easy access to local amenities. The property benefits from gas central heating, a private garden and off-street parking, giving everyday convenience and outdoor space to enjoy.

ENTRANCE HALL

LOUNGE 14'11" X 13'5" (4.55M X 4.09M)

KITCHEN/DINER 8'2" X 13'5" (2.50M X 4.09M)

LANDING

BEDROOM 1 11'1" X 13'5" (3.39M X 4.09M)

BEDROOM 2 12'0" X 7'8" (3.66M X 2.34M)

BATHROOM

OUTSIDE

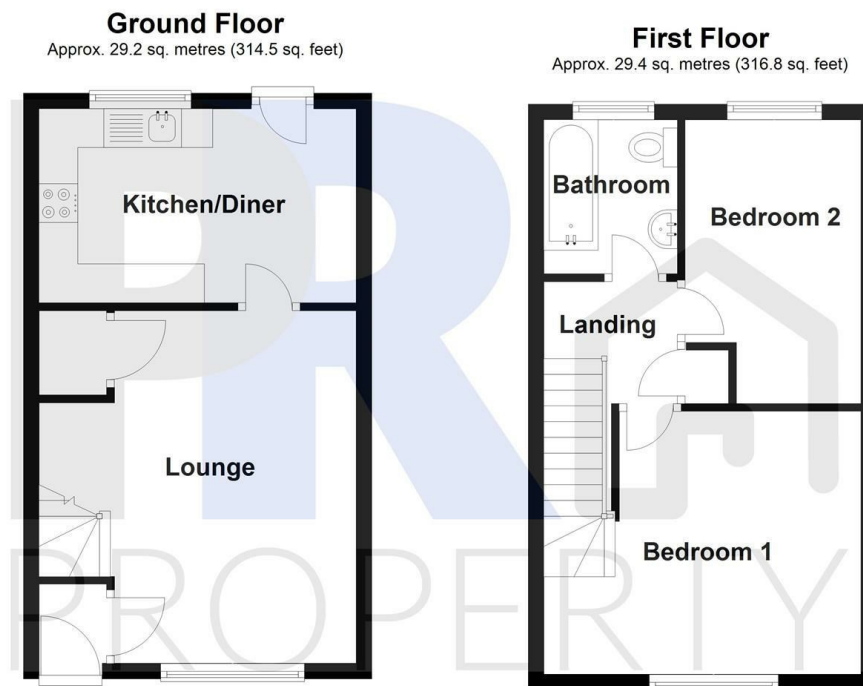

5 SORRELL CLOSE

| Energy Efficiency Rating | | |
|---|---------|-------------------------|
| | Current | Potential |
| Very energy efficient - lower running costs | | |
| (92 plus) A | | |
| (81-91) B | | |
| (69-80) C | | |
| (55-68) D | | |
| (39-54) E | | |
| (21-38) F | | |
| (1-20) G | | |
| Not energy efficient - higher running costs | | |
| England & Wales | | EU Directive 2002/91/EC |