

50 Ridgway Road, Luton, LU2 7RR
£1,500 PCM

- PR Property lettings
- Lovely garden area
- Easy commuting options

- Available Now
- Modern living spaces
- Great EPC Rating C

- 3 spacious bedrooms
- New Bathroom
- Close to train station

Exclusive to PR Property is this newly refurbished three-bedroom home which is available now to let. Ideally situated close to the train station and town centre, it offers excellent convenience for commuting and access to local amenities. The property benefits from a fresh, modern interior and a lovely garden, providing a pleasant outdoor space to relax or entertain. Perfect for families or professionals seeking comfortable living in a well-connected location.

LIVING ROOM 10'9" X 10'10" (3.27M X 3.30M)

DINING ROOM 13'5" X 10'10" (4.09M X 3.30M)

KITCHEN 13'11" X 6'5" (4.25M X 1.96M)

LANDING

BEDROOM 1 10'9" X 14'0" (3.27M X 4.26M)

BEDROOM 2 10'7" X 10'10" (3.23M X 3.30M)

BEDROOM 3 6'7" X 9'3" (2.00M X 2.82M)

BATHROOM

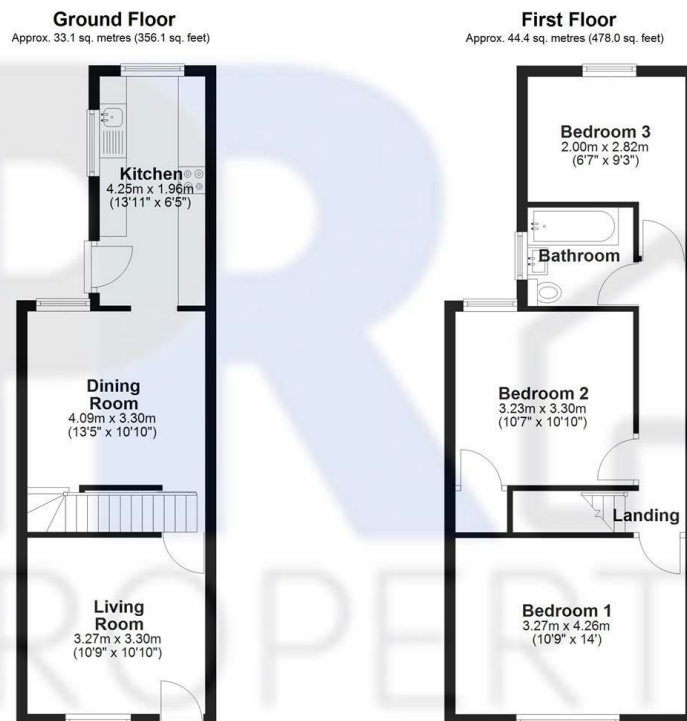

Total area: approx. 77.5 sq. metres (834.2 sq. feet)
50 Ridgeway Road

Energy Efficiency Rating		
	Current	Potential
Very energy efficient - lower running costs		
(92 plus) A		89
(81-91) B		
(69-80) C		59
(55-68) D		
(39-54) E		
(21-38) F		
(1-20) G		
Not energy efficient - higher running costs		
England & Wales		EU Directive 2002/91/EC