



- EXCLUSIVE TO PR PROPERTY LETTINGS
- ALL BILLS INCLUDED
- ANNEX TO MAIN HOUSE
- STUDIO APARTMENT
- AVAILABLE NOW
- MUST BE VIEWED
- BRAND NEW
- STOPSLEY LOCATION

\*\*\* EXCLUSIVE TO PR PROPERTY LETTINGS \*\*\* STUDIO APARTMENT \*\*\* ANNEX NEXT TO MAIN PROPERTY \*\*\* BRAND NEW MODERN FINISH \*\*\* ALL BILLS INCLUDED \*\*\* WIFI INTERNET INCLUDED \*\*\* KITCHENETTE INCLUDING FRIDGE FREEZER AND HOB \*\*\* AVAILABLE NOW \*\*\* MUST BE VIEWED \*\*\* STOPSLEY LOCATION \*\*\*

**STUDIO ROOM 13'00 X 7'04 (3.96M X 2.24M)**

**SHOWER ROOM**

### Ground Floor

Approx. 11.0 sq. metres (118.4 sq. feet)

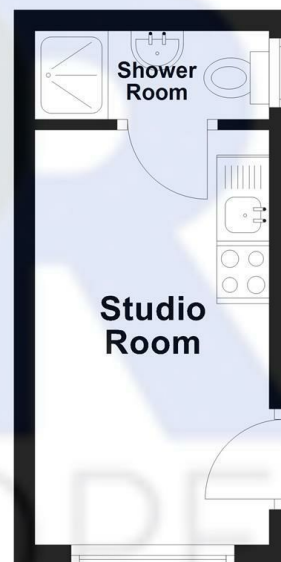

Total area: approx. 11.0 sq. metres (118.4 sq. feet)

**Annex 65 Stopsley Way, Luton**

Energy Efficiency Rating		
	Current	Potential
Very energy efficient - lower running costs		
(92 plus) <b>A</b>		
(81-91) <b>B</b>		
(69-80) <b>C</b>		
(55-68) <b>D</b>		
(39-54) <b>E</b>		
(21-38) <b>F</b>		
(1-20) <b>G</b>		
Not energy efficient - higher running costs		
England & Wales		EU Directive 2002/91/EC