



PR 
PROPERTY

Flat 3, 27 Downs Road, Luton, Bedfordshire, LU1 1QP
£900

- EXCLUSIVE TO PR PROPERTY LETTINGS
- CLOSE TO TOWN CENTRE
- MUST BE VIEWED

- ONE BEDROOM
- PARKING AVAILABLE
- AVAILABLE APRIL 2025

- GAS CH & DG WINDOWS
- COMMUNAL GARDENS

**** EXCLUSIVE TO P&R PROPERTY LETTINGS *** ONE BEDROOM APARTMENT *** TOWN CENTER LOCATION *** PARKING AVAILABLE *** NEWLY REDECORATED *** AVAILABLE APRIL 2025 *** USE OF SHARED GARDEN *** CLOSE TO SHOPS AND STATION *** MUST BE VIEWED ***

ENTRANCE HALL

LOUNGE 16'7" X 11'7" (5.05M X 3.53M)

KITCHEN 6'10" X 6'5" (2.09M X 1.95M)

BEDROOM 1 6'7" X 13'11" (2.00M X 4.25M)

BATHROOM

Second Floor

Approx. 40.6 sq. metres (437.3 sq. feet)

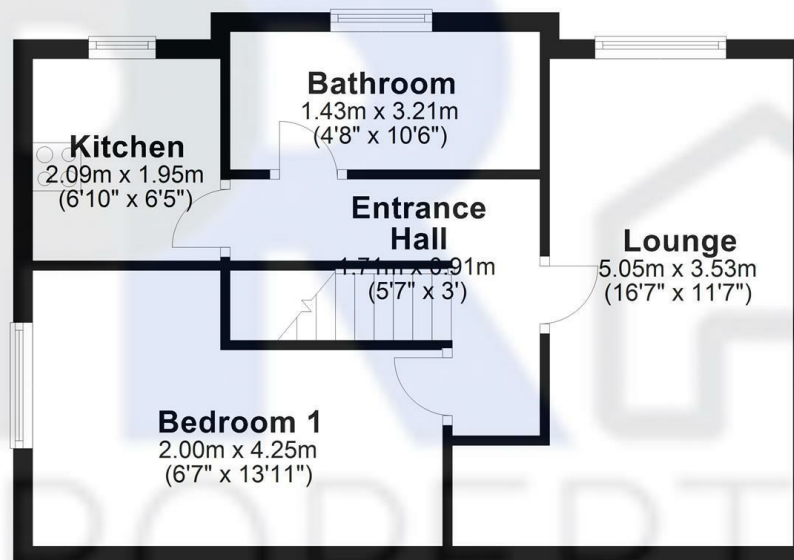

Total area: approx. 40.6 sq. metres (437.3 sq. feet)

Flat 3 27 downs road

Energy Efficiency Rating		
	Current	Potential
Very energy efficient - lower running costs		
(92 plus) A		
(81-91) B		
(69-80) C		
(55-68) D	56	61
(39-54) E		
(21-38) F		
(1-20) G		
Not energy efficient - higher running costs		
England & Wales		EU Directive 2002/91/EC