



PR 
PROPERTY

Flat 37, Arrowhead House Laporte Way, Luton, Bedfordshire, LU4 8FF
£1,200 PCM

- EXCLUSIVE TO PR PROPERTY LETTINGS
- WHITE GOODS INCLUDED
- CLOSE TO M1 AND TRANSPORT LINKS

- AVAILABLE SEPTEMBER 2024
- LIFT ACCESS TO ALL FLOORS
- MUST BE VIEWED

- MODERN FINISH
- LOCATED ON FIRST FLOOR
- OPEN PLAN LIVING SPACE

***EXCLUSIVE TO P&R PROPERTY LETTINGS *** MODERN TWO BEDROOM APARTMENT *** LARGE OPEN PLAN LIVING AND DINING SPACE *** FITTED KITCHEN WITH BUILT IN WHITE GOODS - INCLUDING DISHWASHER *** AVAILABLE SEPTEMBER 2024 *** LUXURY MODERN BUILDING *** LOBBY AREA WITH LIFT ACCESS TO ALL FLOORS *** CLOSE TO M1 AND L&D HOSPITAL *** CLOSE TO BUSWAY AND TRANSPORT LINKS *** MUST BE VIEWED ***

KITCHEN/LIVING AREA 14'09 X 9'10 (4.50M X 3.00M)

BEDROOM ONE 9'10 X 8'02 (3.00M X 2.49M)

BEDROOM TWO 9'10 X 8'08 (3.00M X 2.64M)

BATHROOM 6'03 X 5'07 (1.91M X 1.70M)

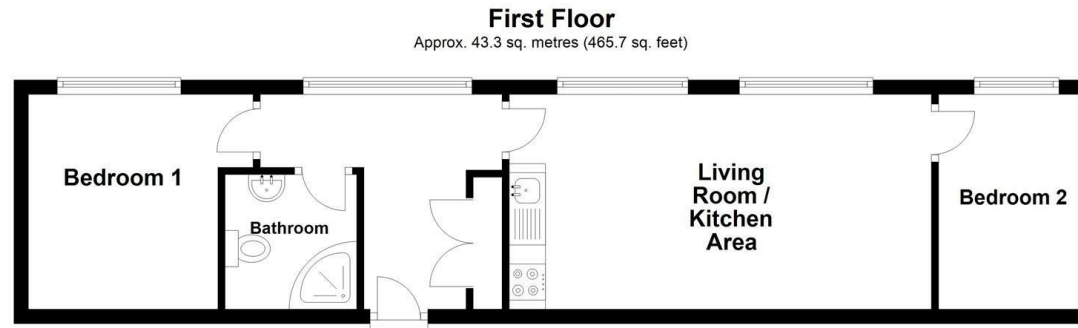

Total area: approx. 43.3 sq. metres (465.7 sq. feet)

Energy Efficiency Rating		Current	Potential
Very energy efficient - lower running costs			
(92 plus)	A		
(81-91)	B		
(69-80)	C		
(55-68)	D	52	52
(39-54)	E		
(21-38)	F		
(1-20)	G		
Not energy efficient - higher running costs			
England & Wales		EU Directive 2002/91/EC	