



64 Dunstable Road, Toddington, Bedfordshire, LU5 6DR
£1,000 PCM

- CHARACTER COTTAGE
- MUST BE VIEWED
- LOCATED IN VILLAGE OF TODDINGTON

- TWO DOUBLE BEDROOMS
- EASY PARKING AVAILABLE

- PRIVATE REAR GARDEN
- AVAILABLE JULY 2024

**** P&R PROPERTY LETTINGS **** AN ATTRACTIVE TWO BEDROOM COTTAGE *** VILLAGE OF TODDINGTON *** AVAILABLE JULY 2024 *** PRIVATE REAR GARDEN *** CLOSE TO M1 *** GOOD CONDITION *** TWO DOUBLE BEDROOMS *** MUST BE VIEWED ***

GROUND FLOOR

LOUNGE 11'7" X 10'8" (3.54 X 3.25)

KITCHEN/DINER 11'7" X 10'0" (3.54 X 3.05)

REAR ENTRANCE

BATHROOM

FIRST FLOOR

LANDING

BEDROOM 1 11'7" X 10'8" (3.54 X 3.25)

BEDROOM 2 10'0" X 8'8" (3.05 X 2.64)

OUTSIDE

REAR GARDEN

Ground Floor
Approx. 28.2 sq. metres (303.5 sq. feet)

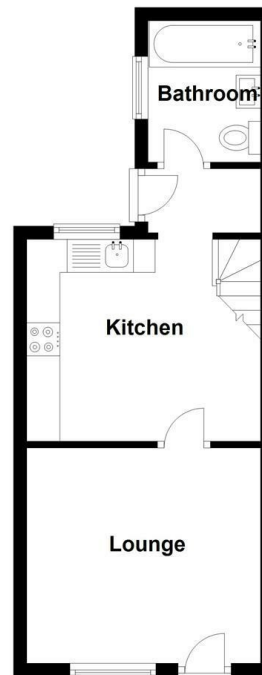

First Floor
Approx. 22.6 sq. metres (243.1 sq. feet)

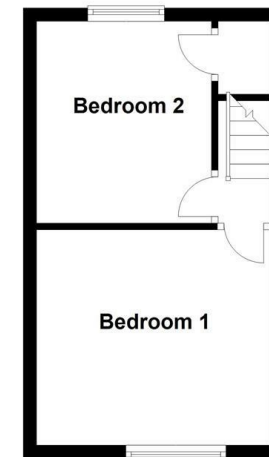

Total area: approx. 50.8 sq. metres (546.6 sq. feet)

Energy Efficiency Rating		
	Current	Potential
Very energy efficient - lower running costs		
(92 plus) A		
(81-91) B		
(69-80) C		
(55-68) D	68	69
(39-54) E		
(21-38) F		
(1-20) G		
Not energy efficient - higher running costs		
England & Wales	EU Directive 2002/91/EC	