



65 Malvern Road, Luton, LU1 1LG
£200,000



65 Malvern Road, Luton, LU1 1LG

**** EXCLUSIVE TO PR PROPERTY SALES **** Located in a popular area of Luton is this well maintained 2 bedroom home. This traditional terraced house benefits from accommodation including 2 double bedrooms, 2 reception rooms, kitchen, bathroom and gas central heating. Outside you have a private rear garden.

LIVING ROOM 10'11" X 10'9"
(3.33M X 3.28M)

DINING ROOM 11'1" X 10'9"
(3.39M X 3.28M)

KITCHEN 10'6" X 6'6" (3.20M X 1.99M)

BATHROOM

BEDROOM 1 11'1" X 12'0"
(3.39M X 3.66M)

BEDROOM 2 10'11" X 12'0"
(3.33M X 3.66M)

OUTSIDE

PRIVATE REAR GARDEN



Ground Floor

Approx. 34.3 sq. metres (369.1 sq. feet)



First Floor

Approx. 28.1 sq. metres (302.3 sq. feet)

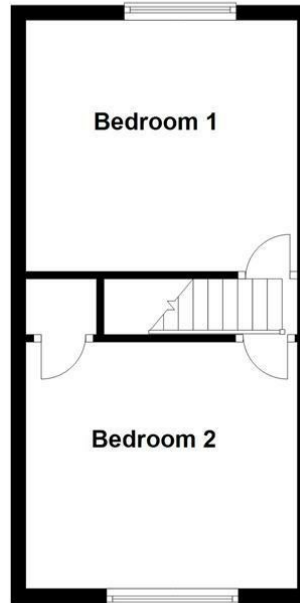

Total area: approx. 62.4 sq. metres (671.4 sq. feet)

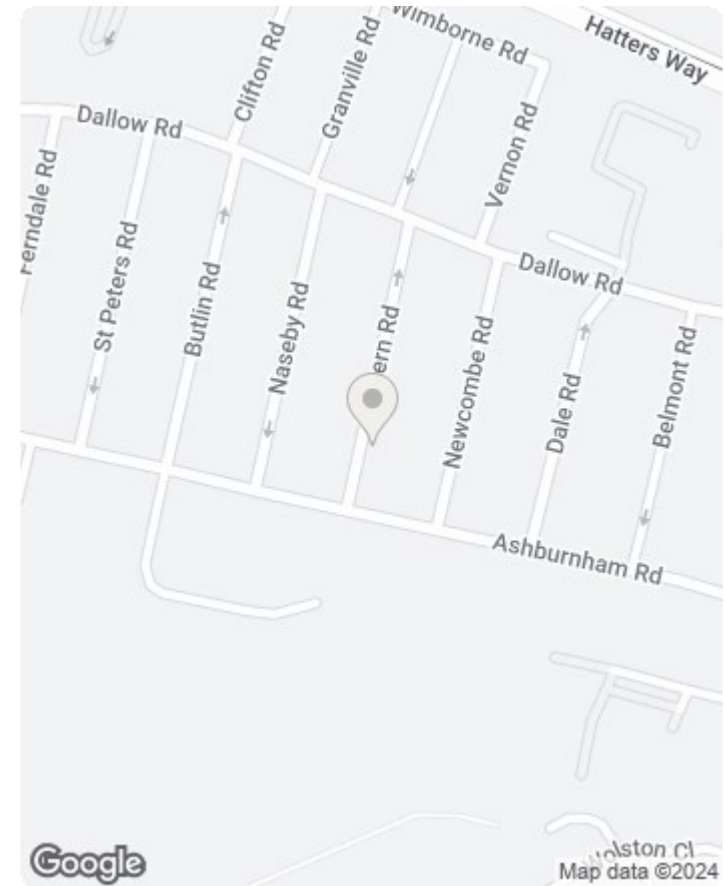

Energy Efficiency Rating		
	Current	Potential
Very energy efficient - lower running costs		
(92 plus) A		
(81-91) B		
(69-80) C		
(55-68) D		
(39-54) E		
(21-38) F		
(1-20) G		
Not energy efficient - higher running costs		
England & Wales	EU Directive 2002/91/EC	

