



13 Burfield Court Handcross Road, Luton, Bedfordshire, LU2 8JY  
£900 PCM



- EXCLUSIVE TO PR PROPERTY LETTINGS
- CLOSE TO AIRPORT
- GOOD CONDITION

- NEWLY REFURBISHED
- GOOD TRANSPORT LINKS
- CLOSE TO SHOPS AND SUPER MARKET

- PERMIT PARKING ON SITE
- AVAILABLE NOW
- ONE BEDROOM

**\*\* EXCLUSIVE TO PR PROPERTY LETTINGS \*\* NEWLY REFURBISHED \*\* AVAILABLE NOW \*\* ONE BEDROOM \*\* PERMIT PARKING ON SITE INCLUDED \*\* CLOSE TO AIRPORT AND M1 \*\*\* CLOSE TO SUPERMARKET \*\* MUST BE VIEWED \*\* This lovely apartment has been completely refurbished and benefits from accommodation comprising entrance hall, living room, kitchen, bedroom and bathroom.**

**ENTRANCE HALL**

**LIVING ROOM 10'1" X 6'7" (3.08M X 2.00M)**

**KITCHEN 6'8" X 5'2" (2.04M X 1.58M)**

**BEDROOM 1 10'4" X 7'6" (3.14M X 2.29M)**

**BATHROOM**

**Ground Floor**

Approx. 30.7 sq. metres (330.1 sq. feet)

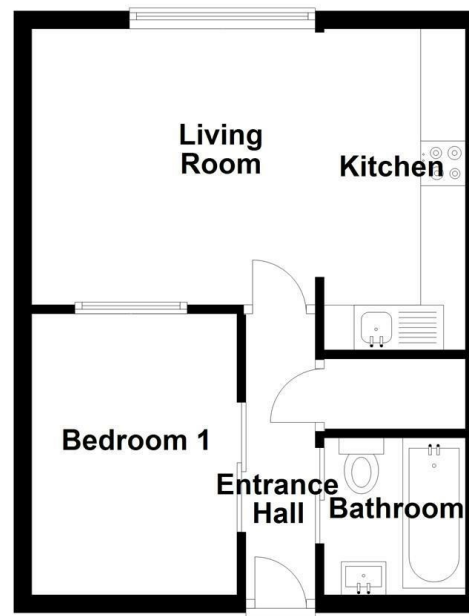

Total area: approx. 30.7 sq. metres (330.1 sq. feet)

Energy Efficiency Rating		Current	Potential
Very energy efficient - lower running costs			
(92 plus)	A		
(81-91)	B		
(69-80)	C		78
(55-68)	D	58	
(39-54)	E		
(21-38)	F		
(1-20)	G		
Not energy efficient - higher running costs			
England & Wales			EU Directive 2002/91/EC