



14 William Street, Luton, Bedfordshire, LU2 7RF
£235,000



14 William Street, Luton, Bedfordshire, LU2 7RF

** Exclusive to PR Property Sales ** No Upper Chain **** A well presented house that boasts two double bedrooms, two reception rooms and is located within easy walking distance to the two centre and train in station. The property benefits from accommodation comprising living room, dining room, kitchen, two double bedrooms, bathroom, gas central heating, double glazed windows and private garden.

LIVING ROOM 10'10" X 12'0"
(3.30M X 3.65M)

DINING ROOM 10'7" X 12'0"
(3.22M X 3.65M)

KITCHEN 9'3" X 7'4" (2.83M X 2.23M)

REAR LOBBY

BATHROOM

LANDING

BEDROOM 1 10'9" X 13'7"
(3.28M X 4.15M)

BEDROOM 2 10'8" X 13'7"
(3.25M X 4.15M)

OUTSIDE

REAR GARDEN



Ground Floor



First Floor

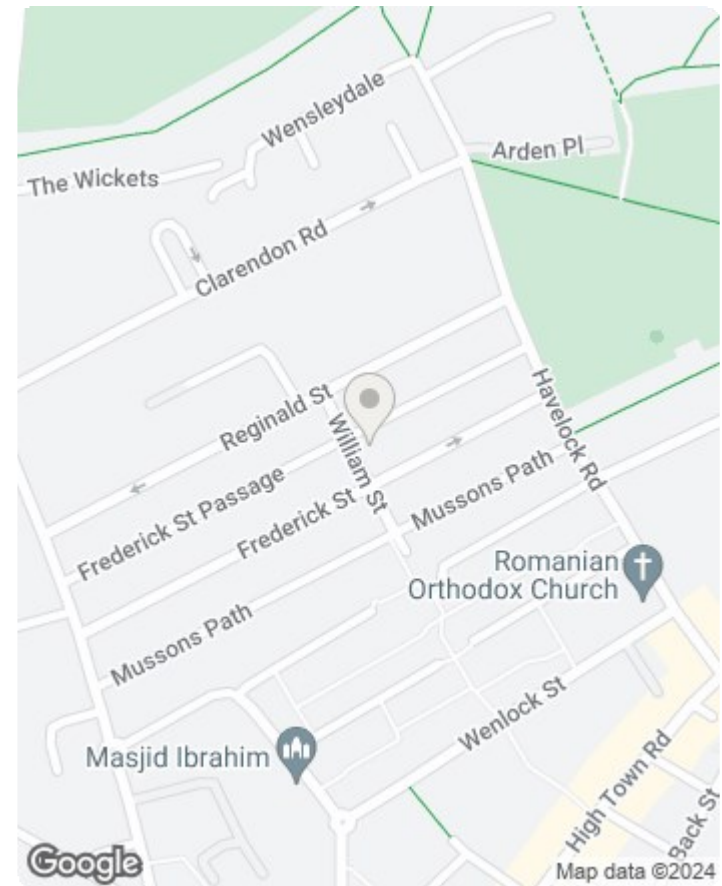
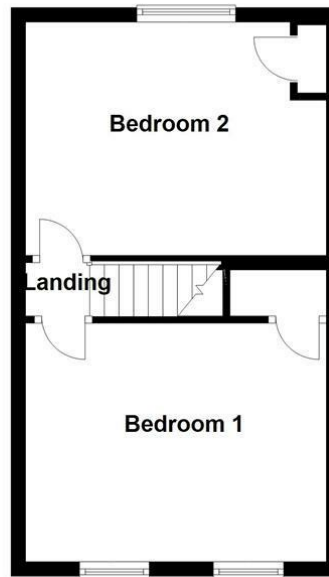

Energy Efficiency Rating		
	Current	Potential
Very energy efficient - lower running costs		
(92 plus) A		
(81-91) B		
(69-80) C		
(55-68) D		
(39-54) E		
(21-38) F		
(1-20) G		
Not energy efficient - higher running costs		
England & Wales		EU Directive 2002/91/EC

Current: 60
Potential: 82

