



73, Hawthorne Crescent, Greenwich, London, SE10 9GA
£2,850 Per month



73, Hawthorne Crescent, Greenwich, London, SE10 9GA

£2,850 Per month

This superb three bedroom, one bathroom maisonette offers a great amount of space inside and out with a private patio garden.

Greenwich Square is around a vibrant public square which includes leisure facilities, a range of convenience amenities and provides an exciting mix of apartments.

(Please note that currently the building is scaffolded - the rear garden is not usable until the scaffolding is removed. This date set for scaffolding removal is Q1 2026).

Description

With 3 bedrooms, an open plan kitchen and living room, 1 bathroom and is situated on the ground and lower ground floor.

Offered unfurnished, with parking for one car and its own private rear garden patio.

Available now.

(Please note that currently the building is scaffolded - the rear garden is not usable until the scaffolding is removed. This date set for scaffolding removal is Q1 2026).

Situation

Located in Greenwich, is this split level three bedroom, one bathroom, one WC maisonette apartment in the Greenwich Square development in SE10.

Unfurnished

Council Tax Band: E

Available: 13th November 2025



Floor Plans

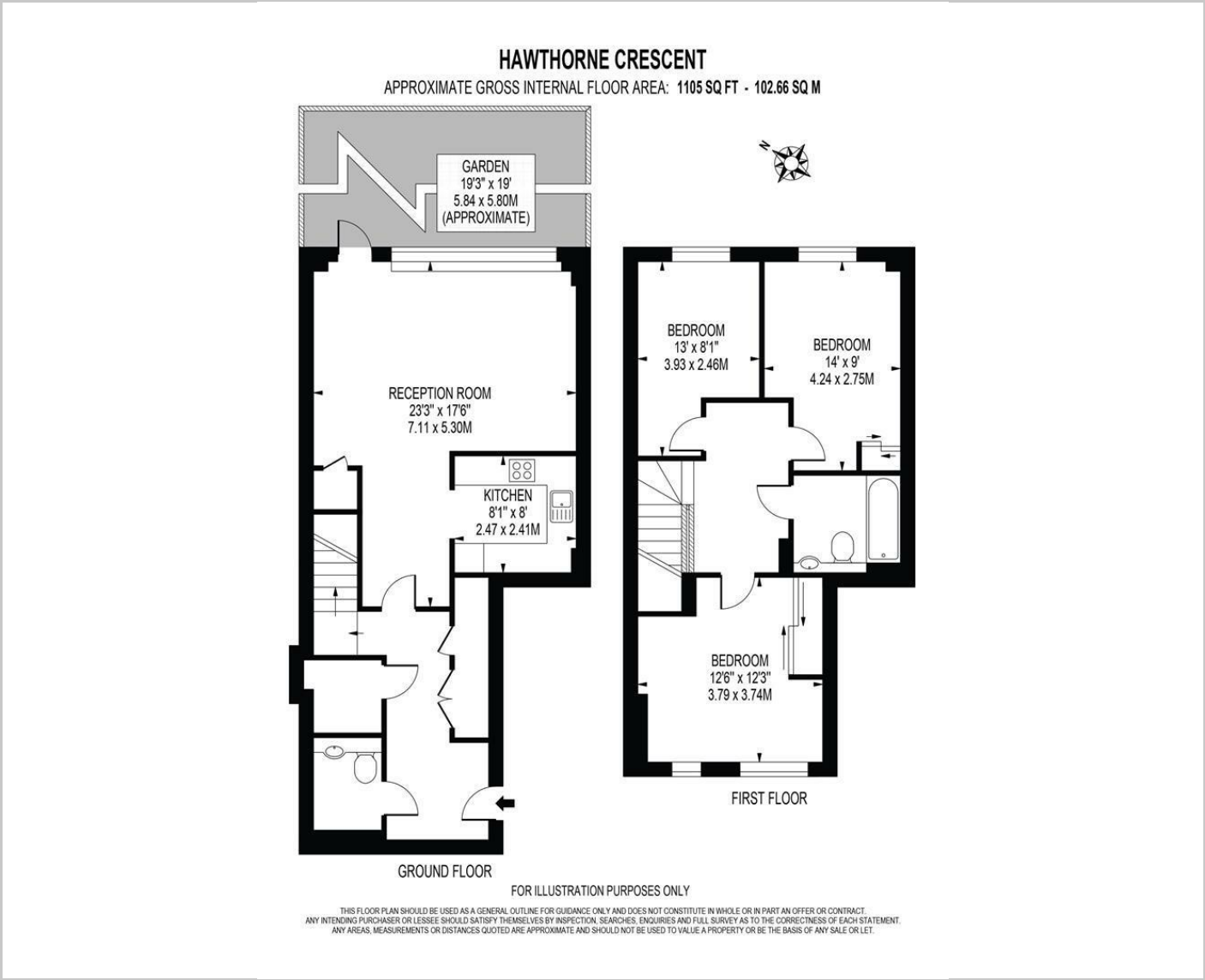

Area Map

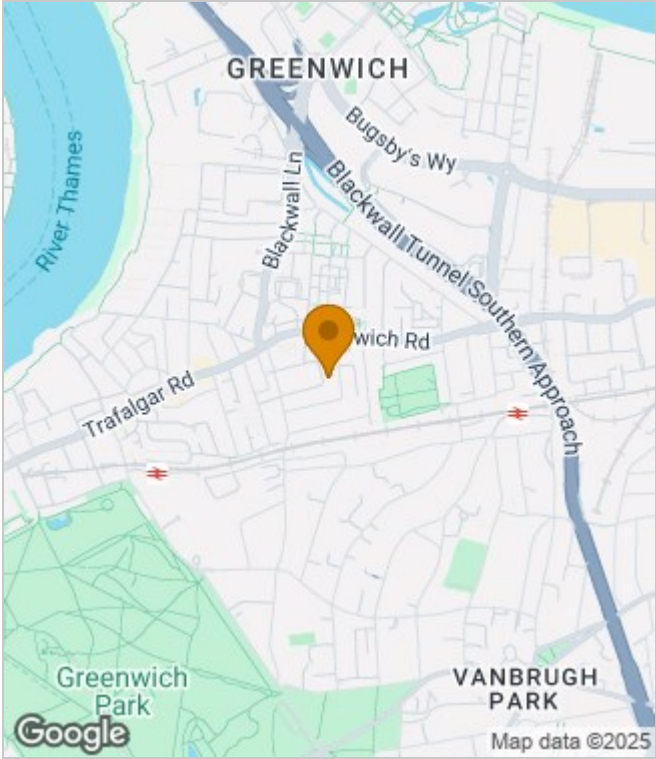

Energy Performance Graph

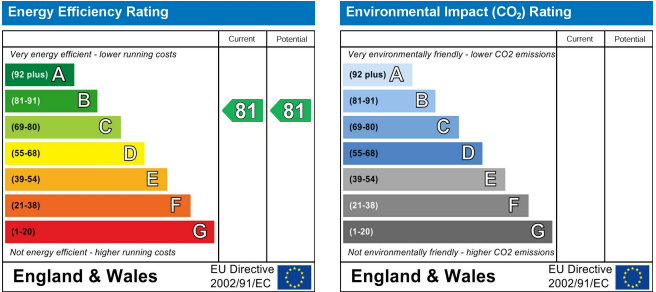

These particulars, whilst believed to be accurate are set out as a general outline only for guidance and do not constitute any part of an offer or contract. Intending purchasers should not rely on them as statements of representation of fact, but must satisfy themselves by inspection or otherwise as to their accuracy. No person in this firms employment has the authority to make or give any representation or warranty in respect of the property.