



46 Rosebery House, 41 Springfield Road, Chelmsford, CM2 6ZP
£210,000



46 Rosebery House, 41 Springfield Road, Chelmsford, CM2 6ZP

£210,000

Welcome to this charming apartment located on Springfield Road in the heart of Chelmsford! This property boasts a cosy reception room, perfect for relaxing or entertaining guests. With one bathroom, convenience is at your fingertips.

Situated in a prime location, this apartment offers easy access to all the amenities Chelmsford has to offer. Whether you're looking to enjoy the local cafes, shops, or parks, everything is just a stone's throw away.

Don't miss out on the opportunity to make this lovely property your new home sweet home in Chelmsford!

Description

With an open plan kitchen and living room/bedroom room, 1 bathroom and is situated on the 5th floor with views of the local area.

Currently let. Perfect for a buy to let purchase.

Situation

Located in Chelmsford, is this amazing and modern open plan studio apartment with one bathroom in the Rosebery House development in CM2.

null

Council Tax Band: B

Available:



Floor Plans

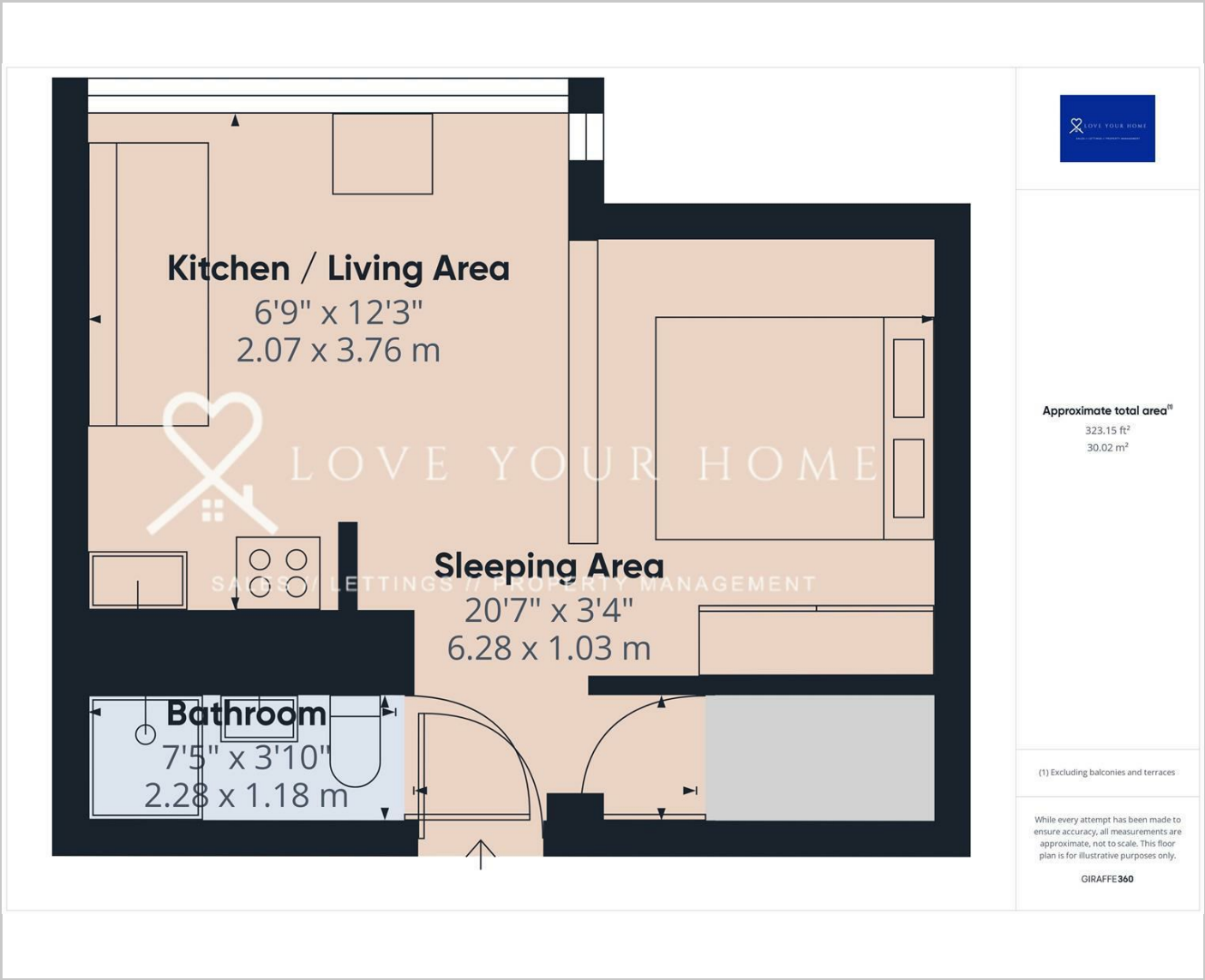

Area Map

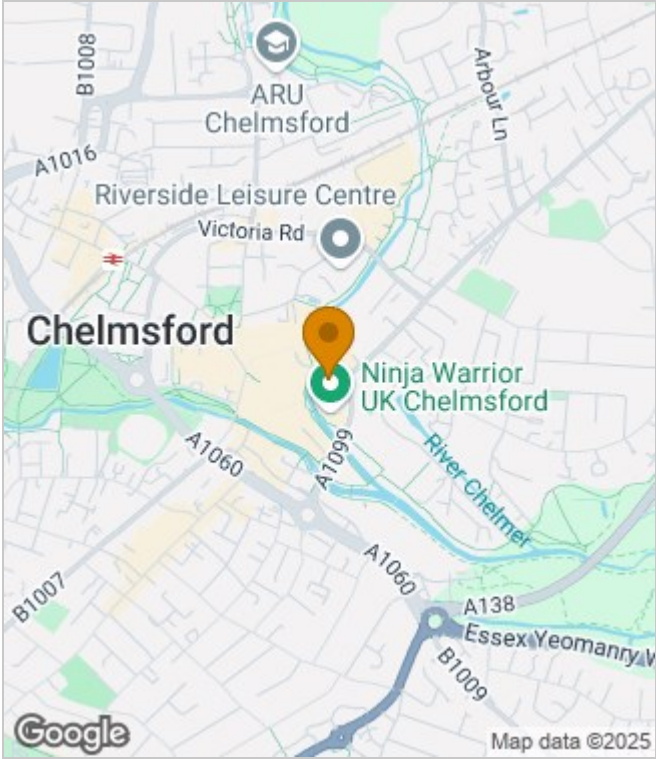

Energy Performance Graph

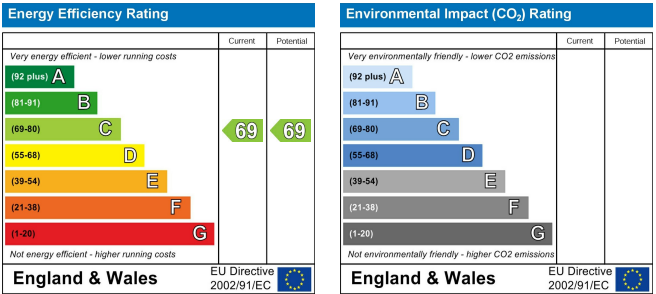

These particulars, whilst believed to be accurate are set out as a general outline only for guidance and do not constitute any part of an offer or contract. Intending purchasers should not rely on them as statements of representation of fact, but must satisfy themselves by inspection or otherwise as to their accuracy. No person in this firms employment has the authority to make or give any representation or warranty in respect of the property.