



LOVE YOUR HOME

SALES // LETTINGS // PROPERTY MANAGEMENT



310 25 Indecon Square, Canary Wharf, London, E14 9DG  
**£2,500 Per month**



310 25 Indecon Square, Canary Wharf, London, E14 9DG

**£2,500 Per month**

Modern two bedroom, two bathroom apartment on the 3rd floor of Indecon Square, E14.

With an open plan living room and kitchen with access to a private balcony. two great sized bedrooms (one with an en-suite), and a master bathroom.,

The development benefits from a 24hr concierge and is close to a huge array of local amenities,

Located near to South Quay DLR in Canary Wharf, and within walking distance to the Canary Wharf Estate, Jubilee Line underground station and the newly opened Canary Wharf Crossrail Elizabeth Line station.



## Description

Modern two bedroom, two bathroom apartment on the 3rd floor of Indescon Square, E14.

With an open plan living room and kitchen with access to a private balcony. two great sized bedrooms (one with an en-suite), and a master bathroom.,

The development benefits from a 24hr concierge and is close to a huge array of local amenities,

## Situation

Located near to South Quay DLR in Canary Wharf, and within walking distance to the Canary Wharf Estate, Jubilee Line underground station and the newly opened Canary Wharf Crossrail Elizabeth Line station.



Furnished

Council Tax Band: E

Available: 7th June 2024

## Floor Plans

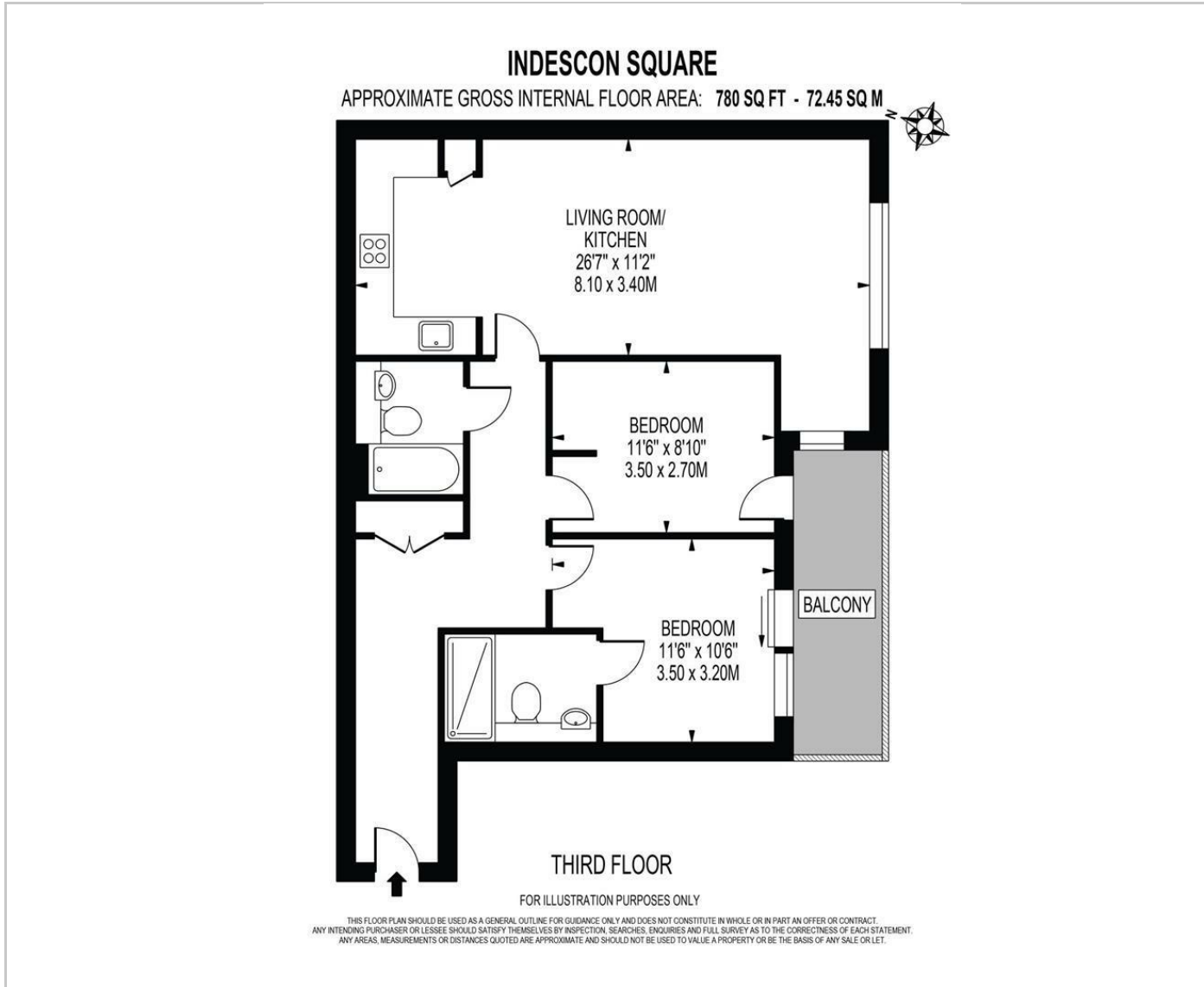

## Area Map

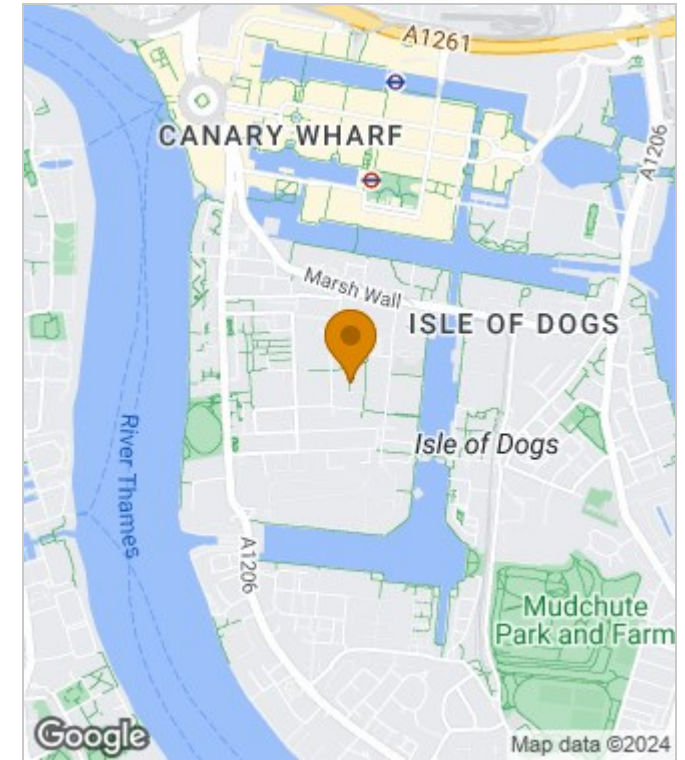

## Energy Performance Graph

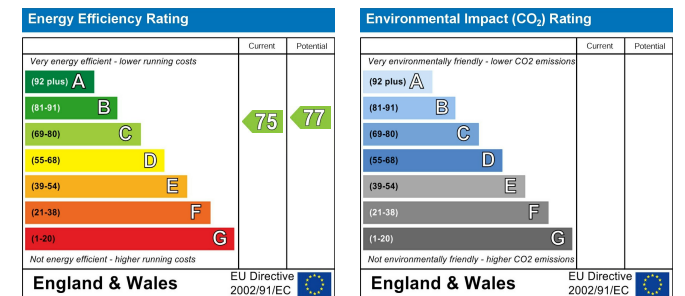

These particulars, whilst believed to be accurate are set out as a general outline only for guidance and do not constitute any part of an offer or contract. Intending purchasers should not rely on them as statements of representation of fact, but must satisfy themselves by inspection or otherwise as to their accuracy. No person in this firm's employment has the authority to make or give any representation or warranty in respect of the property.

The Nucleus Brunel Way, Dartford, Kent, DA1 5GA

Tel: 02081758868 Email: [property@loveyourhomeonline.com](mailto:property@loveyourhomeonline.com) <http://www.loveyourhomeonline.com>