



LOVE YOUR HOME

SALES // LETTINGS // PROPERTY MANAGEMENT



52 1 Grove Place, Eltham, London, SE9 5AA
£305,000



52 1 Grove Place, Eltham, London, SE9 5AA

£305,000

Modern build development in a great location in Eltham, walking distance to the main line station and Eltham High Street.

Description

A fully furnished spacious apartment available now.

Modern build one bedroom penthouse apartment in Grove Place, Eltham.

Open plan living room/kitchen, tiled bathroom and spacious bedroom with built in storage.

Penthouse apartment with views from the 6th floor towards the communal courtyard.

Situation

In the heart of Eltham, it is a short journey to the main line train station.

All of the shops, restaurants and bars on Eltham High Street are only a couple of minutes away from the development.



null

Council Tax Band: B

Available:

Floor Plans

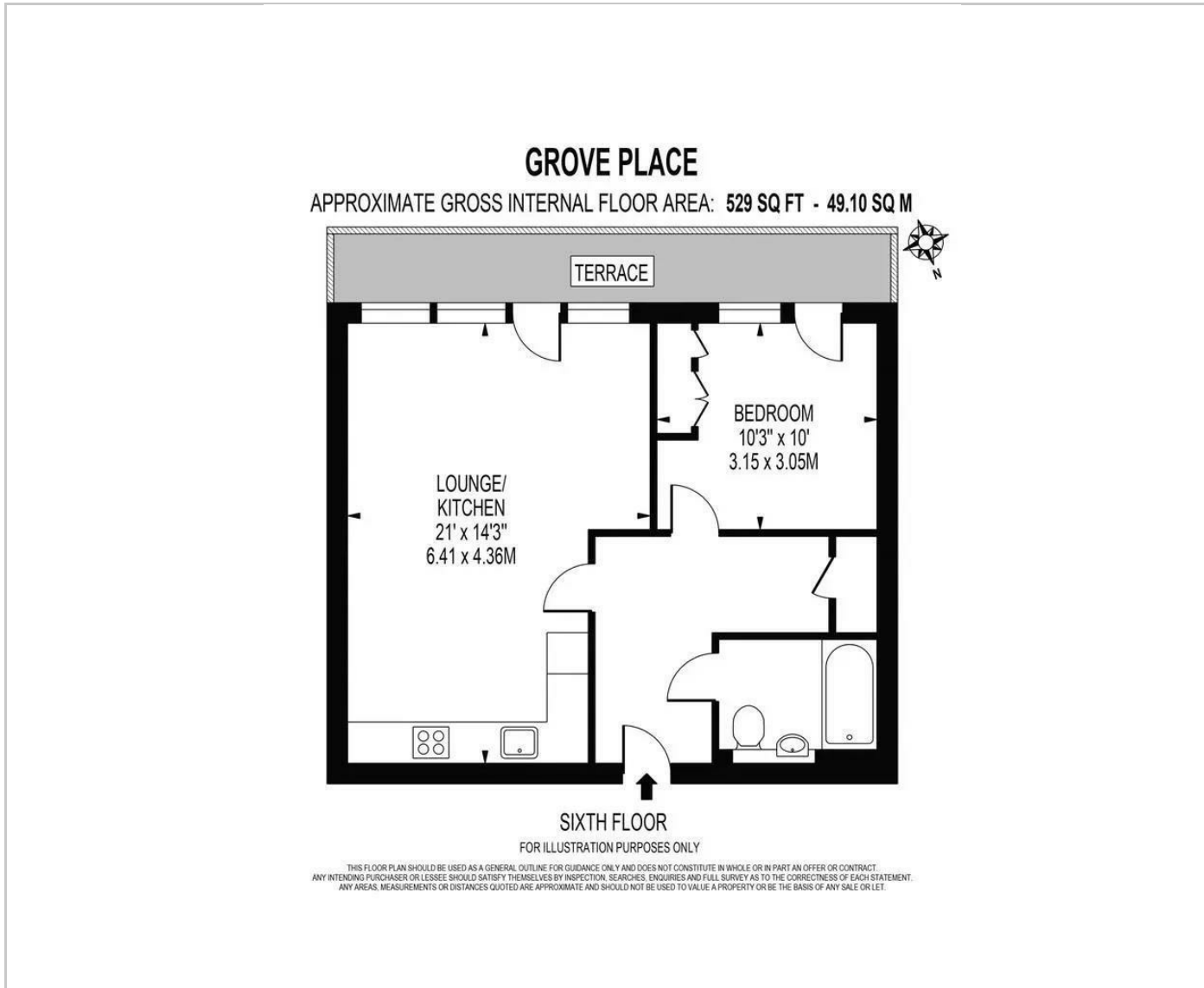

Area Map

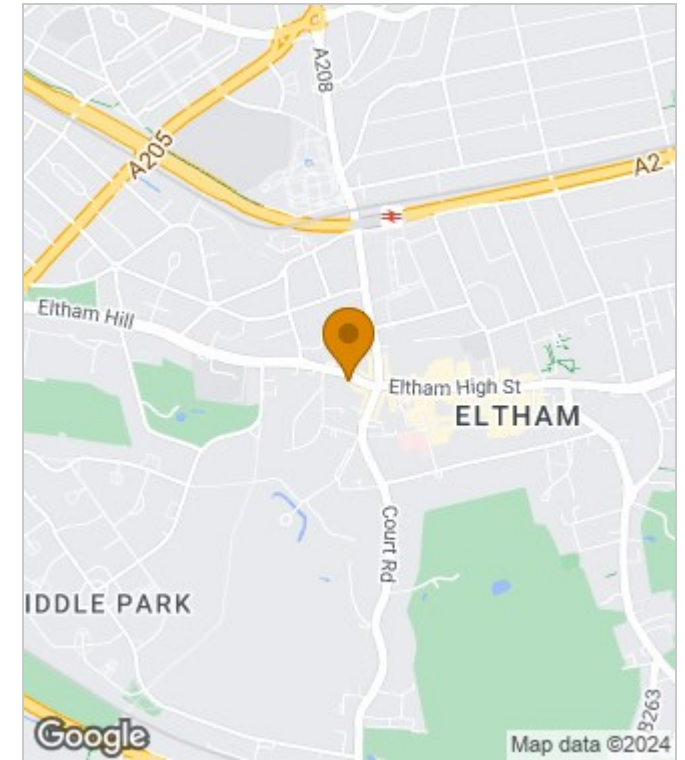

Energy Performance Graph

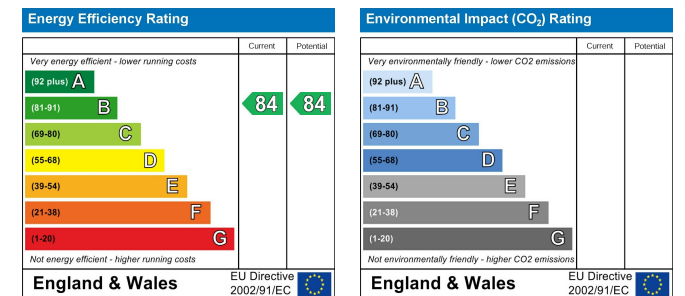

These particulars, whilst believed to be accurate are set out as a general outline only for guidance and do not constitute any part of an offer or contract. Intending purchasers should not rely on them as statements of representation of fact, but must satisfy themselves by inspection or otherwise as to their accuracy. No person in this firm's employment has the authority to make or give any representation or warranty in respect of the property.