



off Chorley New Road

Bolton, BL1 5BB

£900,000



Peacefulness, privacy, practicality, and prestige... A few of the notable aspects of this individually built, premium property in Heaton. High Trees is tucked away amidst a sea of green on its super generous plot within a highly sought after neighbourhood situated off Chorley New Road. This detached four bedroom family home is presented in great condition, while providing a wonderful opportunity for both modernisation and extension (STP).

There is potential to create what undoubtedly could be one of the most beautiful properties in the vicinity with an equally beautiful plot to boot. The house has approximately 3,500 sq ft of internal accommodation which sits in the middle of lush gardens totalling around three quarters of an acre, all of which offers an abundance of potential waiting to be explored.

A brief overview of the downstairs accommodation includes an entrance hall, lounge, dining room, kitchen, snug, utility, downstairs WC, boot room, and integral double garage. Upstairs are four bedrooms with an en-suite and dressing room/walk-in wardrobe to the master, as well as a dressing room/walk-in wardrobe to the second bedroom, plus a family bathroom, and a great amount of storage space.





### The Approach

High Trees is situated on The Clough, a quiet cul-de-sac you probably wouldn't know existed unless somebody told you about it... The leafy green, tree lined lane is tucked away yet perpendicular to Chorley New Road, offering a particularly tranquil setting that's very quiet yet practical and ideally located for family life, or for those simply looking to be away from the hustle and bustle without being out in the sticks. Turn up the lane and this property is hidden on the left within its mature plot, set back from the cul-de-sac behind its large lawn and private driveway.

### The Living Space

Step inside and an open aspect feature staircase sits within the double height entrance hall which gives you the first glimpse of the spacious proportions found throughout, while a huge window streams in plenty of natural light creating an incredibly bright and airy feel.

Stroll across the spacious entrance hall through to an equally spacious lounge with a high ceiling and large glass sliding doors, opening onto a garden patio and framing the greenery of the garden while affording plenty of light to pour in here too. High Trees is believed to have been erected by an architect who custom built the property for themselves in the 1970s, hence a distinctive 70s design with custom features including unique shaped rooms, large windows and split level, roomy living spaces which could be made extremely stylish when brought up to today's interior design standards.

From the lounge, an open aspect dining room creates a flow between rooms akin to that of today's open plan living trend, again where a substantial window brings the outside in and allows you to really appreciate the gorgeous garden – the immediate surroundings are teeming with greenery, so much that you could be mistaken for being on a secluded, rural plot!

Conveniently adjacent to the dining room is the kitchen, which has received the utmost love and care over the years from its current owners, and also provides a great opportunity to knock through into the dining room to create that sought-after open plan kitchen-dining arrangement if desired. In addition to lots of storage space and handy larder cupboards, the kitchen features a range of integrated appliances including a microwave oven, contemporary Belling range cooker with ovens and induction hobs, fridge, freezer, dishwasher, plus a stainless-steel basin with drainer and mixer tap.

Continuing on a practical note, on the other side of the entrance hall is a large utility room with plumbing for the washer/dryer, a laundry drying closet with warm air ventilation, plus an extra basin and more cabinetry providing ample storage. The downstairs WC is presented to modern standards and is also found in this part of the home, next to the boot room and handy internal access to the double garage.

High Trees also benefits from a second lounge-style room which is as cosy as can be, a subtle contrast to the larger, brighter, and airier main lounge. This snug offers a lovely spot to sink into the sofa and unwind with a good book or enjoy a lazy Sunday afternoon with your feet up, while providing versatility in function and would alternatively make an ideal home office or study.

For those with the appetite to reconfigure, the double garage provides an easy option to add a substantial amount of floor space to the accommodation... Perhaps a second lounge? Play room or games room for the kids? Or maybe a home gym? And the large plot with plenty of space to play with would still easily accommodate a large shed or garage style storage building if needed.

### Bedrooms & Bathrooms

From the double height entrance hall, the feature staircase leads to a large galleried landing with views through the great window down the tree lined driveway...

The master bedroom features another big window which again frames the lovely garden and takes centre stage as a main feature in the room. Like many other parts of this home, the master boasts a generous footprint, and benefits from a dressing room/walk-in wardrobe, plus a four-piece en-suite comprising bath with shower, wash basin, WC, and bidet.

The second bedroom is also a very good sized double, also with the benefit of a dressing room and walk-in wardrobe, and a vanity unit with basin and dressing table situated in the bedroom – there is great scope to add an en-suite here if desired too! The two other bedrooms are doubles well proportioned for family life, and the family bathroom is a great size as well, providing an opportunity for modernisation.

In addition to the bedrooms and bathrooms on offer, the first floor also benefits from a substantial storage room which would suit alternative uses, plus access to a large loft.

### Extension & Modernisation Potential

One of the most attractive features of High Trees is the potential that it holds. Whether you would like to take advantage of the large plot and further develop the property via extension (STP), or perhaps simply reconfigure or modernise the existing footprint, there's a great amount of potential.

### The Outside Space

In addition to the large sweeping driveway, High Trees boasts beautiful mature gardens with extensive lawns and mature borders and beds – a gardener's paradise. The plot at High Trees is like its own little green oasis where you can rest assured it is quiet, calm, and undisturbed – the type of setting that's good for the soul!

## Area Map

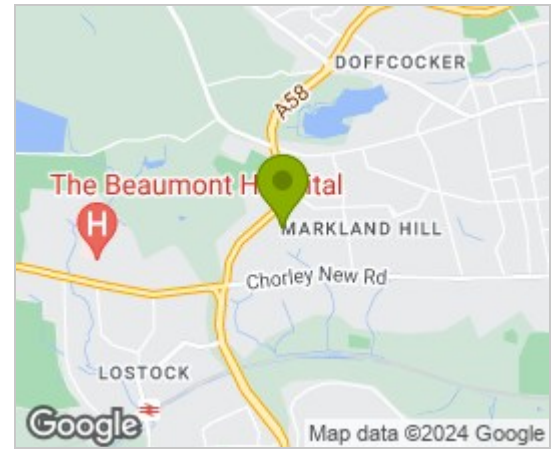

## Floor Plans

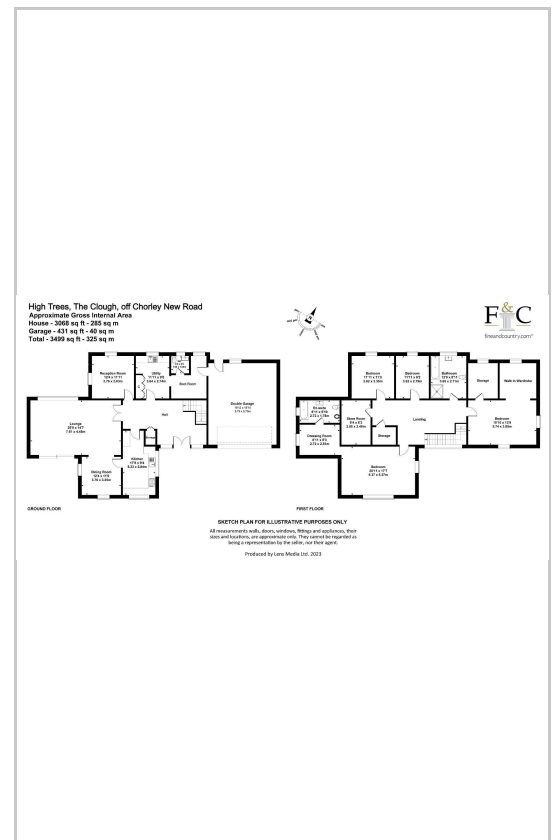

## Energy Efficiency Graph

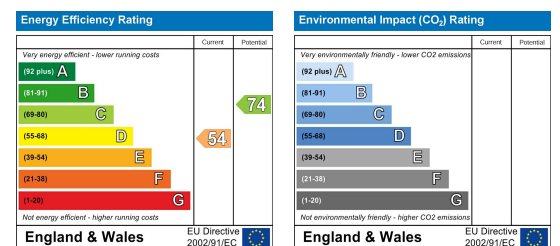

These particulars, whilst believed to be accurate are set out as a general outline only for guidance and do not constitute any part of an offer or contract. Intending purchasers should not rely on them as statements of representation of fact, but must satisfy themselves by inspection or otherwise as to their accuracy. No person in this firm's employment has the authority to make or give any representation or warranty in respect of the property.