



Barmskin Lane

Chorley, PR7 5PZ

£1,950,000



No chain! Brook House is an idyllic, one of a kind home where no detail has been overlooked and no expense has been spared. The property showcases over 5,000 sq ft of luxurious accommodation, situated on a gated 1.1 acre plot amidst the peaceful Lancashire countryside. Despite its tranquil countryside setting, it's a well-connected location, with the national motorway network accessible in only 5 to 10 minutes, and plentiful amenities within a short drive.

There are many aspects which make this property one of a kind. The smart-home and eco-home technology... The opulent interior design crafted with the finest materials... The tasteful blend of contemporary and character styling... The generous landscaped grounds with natural garden lake and rockface... The babbling brook flowing by the easterly boundary... The list goes on!



Accommodation Summary

A summary of the ground floor includes a grand entrance hall with porch, principal lounge with home cinema capability, family room, dining area, a fully integrated Siematic kitchen with island and bar, utility, study, boot room, downstairs WC, and two handy storage rooms/closets (one off the dining area, and one off the boot room).

The first floor features a gallery landing with vaulted ceiling, three double en-suite bedrooms, a master suite with private dressing area/boudoir, walk-in wardrobe, and mezzanine master bathroom, plus a balcony spanning the full width of the house with lovely green views.

There is a substantial converted basement consisting of two rooms – a plant/comms room, and a versatile room which would be perfect for use as a wine cellar. Separate from the main house is an additional building consisting of a detached double garage and a large home gym with terrace overlooking the natural garden lake, which holds excellent potential for a variety of uses.

Outstanding Design

Formerly a public house dating back to the early 1800s, this property has undergone significant redevelopment and been transformed into a signature residential property with outstanding design, both inside and out, where interiors have been masterfully crafted by the award-winning interior design and architectural studio 'Design by Uber'. From the polished marble bathrooms and crystal-effect stone feature walls, the stone and oak flooring, to the designer chandeliers and grand vaulted ceilings, every detail contributes to creating a true wow-factor.

The house has also been designed with practicality in mind, benefitting from a floor plan that flows perfectly for both everyday life and when entertaining family and friends, while taking full advantage of the landscaped grounds through an abundance of glass.

Additionally, there are plenty of smart-home features that give convenience for daily life, such as underfloor heating throughout with independent control for every room, an integrated indoor and outdoor sound system, mood lighting, remote controlled black-out curtains and blinds, and a comprehensive security system with CCTV and intercom for the electric gates.

Well prepared for the ongoing transition to green energy, and having the advantage of long-term energy savings, the heating system is powered by two air-source heat pumps, with a heat recovery system which optimises the efficiency of the pumps.

The Approach

On the country lane, a tall hedgerow adjoins a stone wall and two stone pillars set beside the electric gates, creating a beautiful entrance and a great sense of privacy. Beyond the gates a large drive bordered by manicured lawns sits in front of the house, providing lots of space for parking, and continues further to the detached double garage on the left.

An Abundance of Living Space

There are two entrances to the property at the front, one being the main front door, which is ideal for guests, leading through a traditional porch and into the grand entrance hall, and the other being a more practical, daily entrance to the meet the demands of modern family life, leading through the boot room, past the downstairs WC, and into the kitchen.

The principal lounge is super generous in size, spanning the full depth of the property. It's no surprise it is presented to impeccable standards, with a hidden home cinema system including integrated ceiling speakers, and an Epson projector and Sapphire screen that descend from the ceiling... Draw the black-out curtains with a touch of a button on the remote, and you have the complete big screen experience from the comfort of your own home. As well as the home cinema, a set of bifold doors makes the most of the views to the garden, and the chimney breast is home to a log burner and wall-mounted TV point.

The heart of the home is arguably the top of the range Siematic kitchen, grounded by a smart limestone floor. A substantial island with Corian worktop and oak breakfast bar allows the room to be a superb social space, and the comprehensive range of high quality appliances are housed within contemporary two-tone cabinetry. Integrated cooking appliances include a Miele oven, steam oven, combination microwave, and two warming drawers, plus a Siemens induction hob and downdraft extractor. There's also a full length fridge and freezer, Miele wine cooler, Siemens dishwasher, and Caple sink with Quooker tap.

Off the kitchen the spacious Siematic utility room ensures you can keep the kitchen tidy and clutter-free with additional storage cupboards and worktop space, an extra Caple sink, and plenty of room to do the laundry with plumbing for the washer/dryer. Adjacent to here is also a study with a window to the front, which would alternatively be well suited for use as a play room for the little ones.

On the other side of the kitchen, a few steps lead down to the family room, where a vast set of floor to ceiling windows and bifold doors frame expansive views of the lush green grounds and garden lake while providing access to the rear garden terrace and circular walled patio – a perfect setup for garden parties and enjoying the summer weather. The oak floor in this room gives a nod to the cottage character, and the stylish fire set within a media wall adds to the modern design. Due to its great size and convenient position next to the kitchen, it's a versatile room with sufficient space for both a lounge area and an informal dining/breakfast area.

In addition to the principal lounge and family room, there are two further reception rooms... The grand entrance hall is large enough to be another sitting area, with a log burner that's sure to give a warming glow on cold, wintery days. With an open aspect to the entrance hall, the dining room is another delightful space for dinner parties and entertaining, with more bifold doors that 'bring the outside in' and allow you to appreciate the landscaped grounds year-round. A notable aspect of the interior design in this part of the property is the glass floor that displays the wine cellar below.

These particulars, whilst believed to be accurate are set out as a general outline only for guidance and do not constitute any part of an offer or contract. Intending purchasers should not rely on them as statements of representation of fact, but must satisfy themselves by inspection or otherwise as to their accuracy. No person in this firms employment has the authority to make or give any representation or warranty in respect of the property.

Area Map

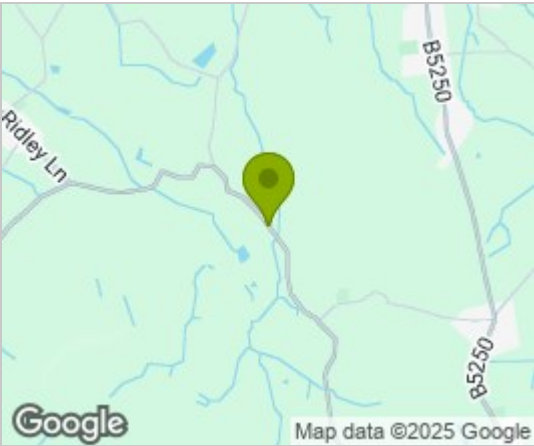

Floor Plans

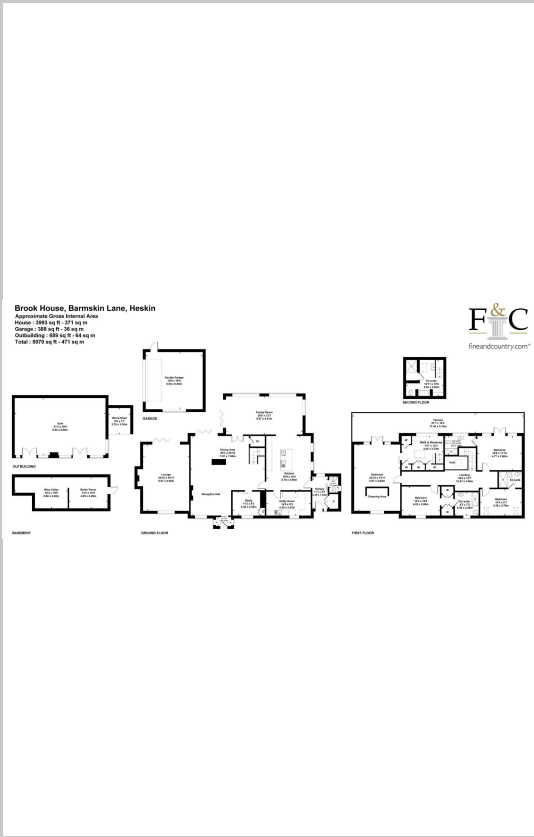

Energy Efficiency Graph

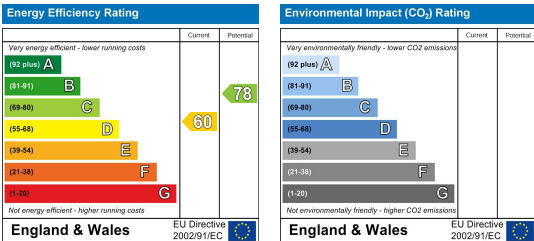

These particulars, whilst believed to be accurate are set out as a general outline only for guidance and do not constitute any part of an offer or contract. Intending purchasers should not rely on them as statements of representation of fact, but must satisfy themselves by inspection or otherwise as to their accuracy. No person in this firms employment has the authority to make or give any representation or warranty in respect of the property.