



## 108 Penshurst Road

Thornton Heath, CR7 7EB

**£2,000 Per month**

Nestled on the charming Penshurst Road in Thornton Heath, this delightful mid-terrace house offers three well-proportioned bedrooms, making it an ideal choice for families or those seeking extra space. The newly decorated interiors are complemented by brand new appliances in the kitchen and the property also features a well-maintained garden, providing a lovely outdoor retreat.

Conveniently located close to Croydon University Hospital, this residence is not only ideal for those working in the healthcare sector but also offers easy access to local amenities and transport links.

\* Tax Band C

### Viewing

Please contact our Birdhouse Surrey Office on 02087737730 if you wish to arrange a viewing appointment for this property or require further information.





Floor Plan

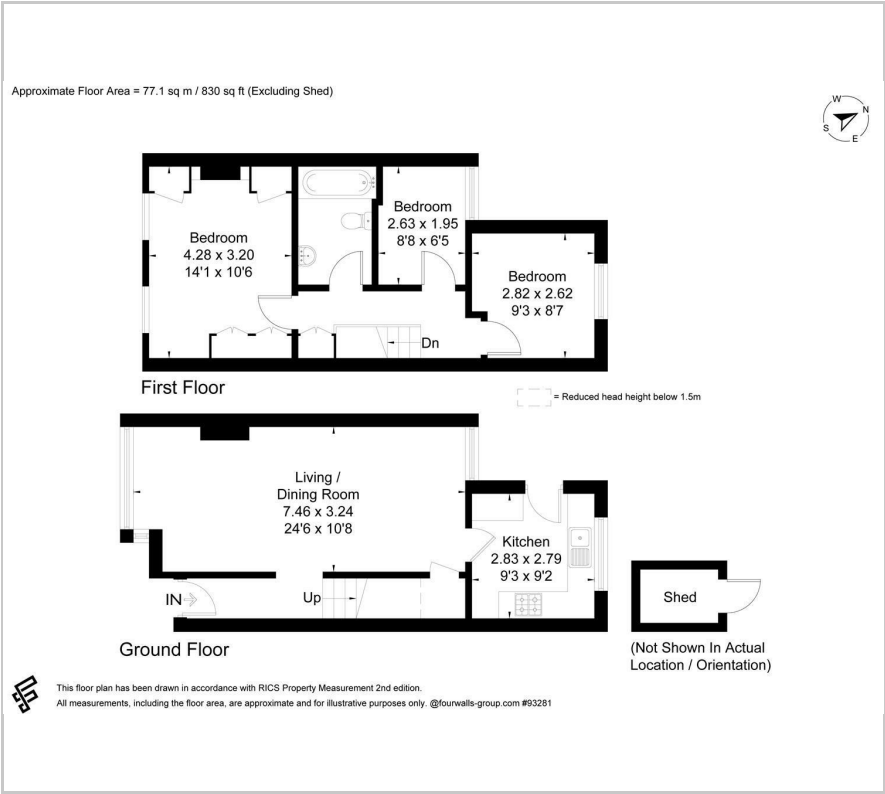

Area Map



Energy Efficiency Graph

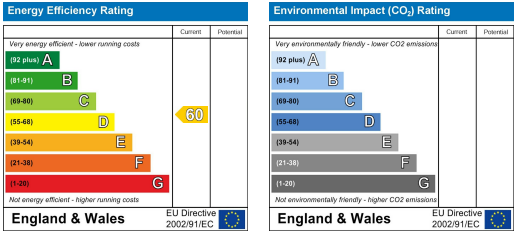

These particulars, whilst believed to be accurate are set out as a general outline only for guidance and do not constitute any part of an offer or contract. Intending purchasers should not rely on them as statements of representation of fact, but must satisfy themselves by inspection or otherwise as to their accuracy. No person in this firms employment has the authority to make or give any representation or warranty in respect of the property.