



2 Bedroom Appealing Mid Terrace House
18 Lea Close
Thurmaston, LE4 8DW

£210,000



18 Lea Close, Leicester, LE4 8DW

Charming Two-Bedroom Mid-Terrace Home with Landscaped Garden and Church Views in Thurmaston

Tucked away in a popular and well-connected Thurmaston location, this well presented two-bedroom mid-terrace home combines period charm with thoughtful modern touches. With its inviting farmhouse-style kitchen-diner, landscaped rear garden, and picturesque church views, the property offers the perfect blend of character and comfort — ideal for first-time buyers, downsizers, or investors alike.

The accommodation begins with an arrival hall leading into a front-facing lounge, featuring a bay window, wood-burning stove, and a useful understairs storage cupboard. This warm and characterful space flows seamlessly through to the kitchen-diner, fitted in a classic farmhouse style with timber-effect units, tiled splash backs, and integrated appliances including an electric oven, gas hob, microwave, and dishwasher.

To the rear there is an impressive landscaped garden, well designed with seating area, mature planting, and two brick-built storage outbuildings. The garden enjoys a peaceful backdrop and a lovely view of the neighbouring church spire, creating sense of tranquillity.

Upstairs, a generous front double bedroom provides ample space for furniture, while the second, smaller double bedroom overlooks the garden to the rear. The first floor also features a modern four-piece bathroom, complete with both a bath and a separate walk-in shower. From the landing, a fitted loft hatch provides access to a boarded loft space offering excellent potential for conversion into a loft room or home office (subject to the necessary consents).

Externally, the property enjoys a neat front garden enclosed by a white picket fence, with on-street parking available. Additional benefits include a newly installed (September 2025) combination boiler supplying gas central heating, and a mixture of double and original glazing that preserves the home's period feel. Buy to let Investors can expect a rental income of £10800 per annum.

23 Meadvale Road Knighton Leicester Leicestershire LE2 3WN

01162214139

hello@homepropertysales.co.uk

www.homepropertysales.co.uk

Energy Efficiency Rating		
	Current	Potential
<i>Very energy efficient - lower running costs</i>		
(92 plus) A		
(81-91) B		
(69-80) C		78
(55-68) D	68	
(39-54) E		
(21-38) F		
(1-20) G		
<i>Not energy efficient - higher running costs</i>		

18 Lea Close, Thurmaston, Leicester, LE4 8DW

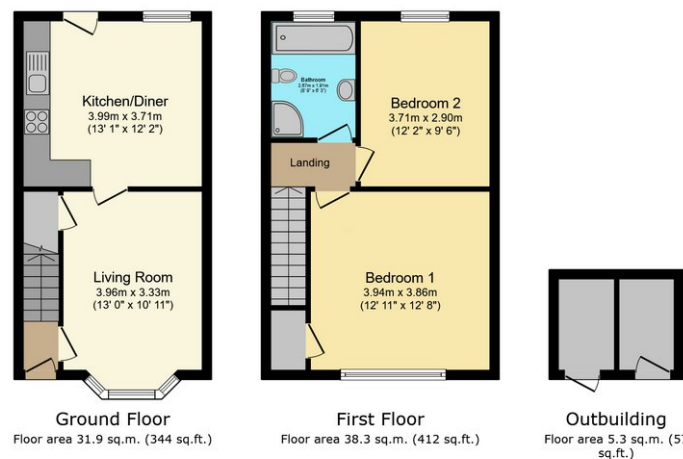

Total floor area: 75.5 sq.m. (813 sq.ft.)

This floor plan is for illustrative purposes only. It is not drawn to scale. Any measurements, floor areas (including any total floor area), openings and orientations are approximate. No details are guaranteed, they cannot be relied upon for any purpose and do not form any part of any agreement. No liability is taken for any error, omission or misstatement. A party must rely upon its own inspection(s). Powered by www.propertybox.co

