



# 16/3 Oxfangs Farm Drive, Edinburgh, EH13 9QQ

*'Excellent sized, dual aspect, 1st floor flat which would now benefit from some upgrading.'*

Hallway with storage cupboards, front facing lounge with sunny aspect and gas fire, kitchen, 3 bedrooms and shower room. Double glazing. Gas central heating. Garden area to rear. On street parking to front. Ideal opportunity to upgrade to own specification.

Oxfangs Farm Drive lies approximately 5 miles south of Princes Street and is well placed for those working within the city centre with a regular bus service available on Oxfangs Road North. Alternatively, a number of major access roads including the A720 Edinburgh City By-Pass allow for ease of commuting out with the city boundaries. Within the vicinity there are amenities to meet every day needs including shops, schools including Firrhill High, health centre, Tesco, Aldi and Morrisons supermarkets. Leisure facilities are well provided for by way of public parks, Braid and Pentland Hills, golf courses and Hillend Snowsports Centre with nearby Morningside having a plethora of specialist shops, restaurants and bars plus the Dominion Cinema and Church Hill Theatre.

## EPC RATING C





# 1ST FLOOR

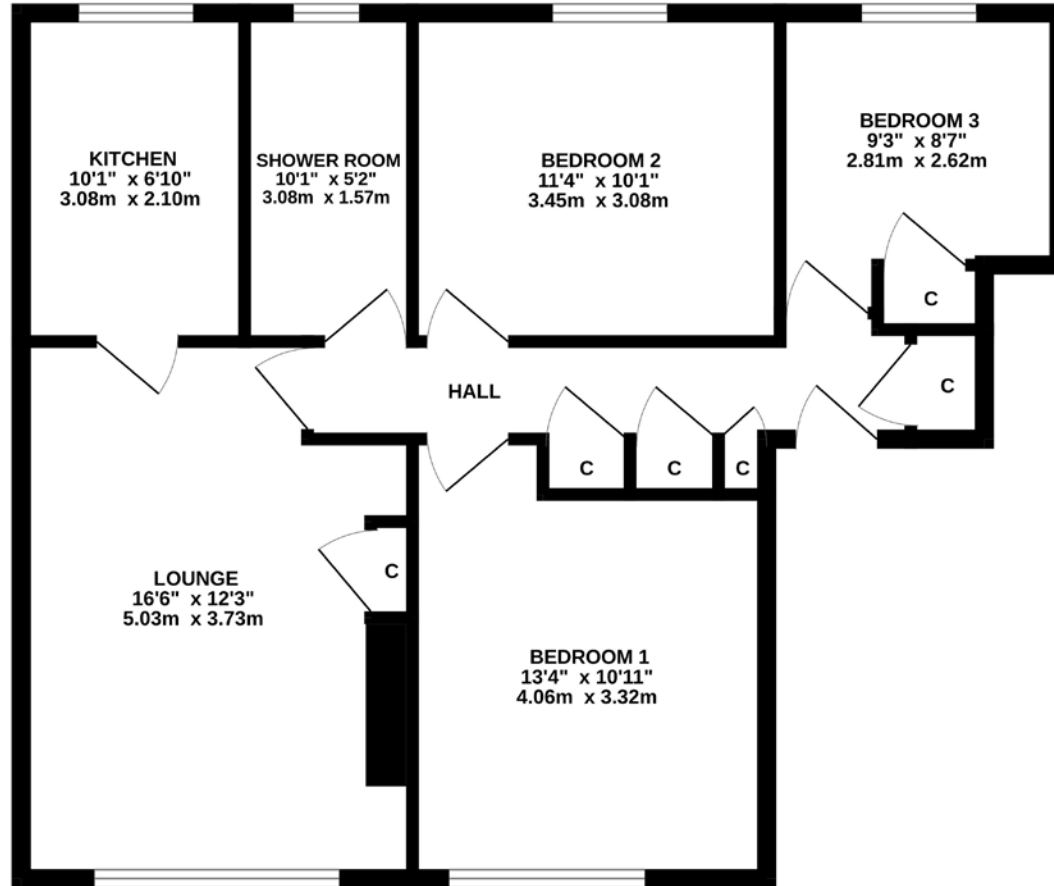

Whilst every attempt has been made to ensure the accuracy of the floorplan contained here, measurements of doors, windows, rooms and any other items are approximate and no responsibility is taken for any error, omission or mis-statement. This plan is for illustrative purposes only and should be used as such by any prospective purchaser. The services, systems and appliances shown have not been tested and no guarantee as to their operability or efficiency can be given.  
Made with Metropix ©2024

Tel: 0131-622 9222  
 Fax: 0131 622 7922  
 Johnson Legal  
 22a Rutland Square  
 Edinburgh, EH1 2BB

These particulars, whilst carefully prepared, are not warranted as accurate and do not form part of any contract of sale.  
 All measurements are approximate and are not warranted.  
 No warranties are given by the seller or the selling agents as regards (a) the state of repair of the property, (b) whether or not the property is affected by any Statutory or other Notice or Planning Proposal, (c) whether or not Building Warrant and other necessary Consents have been obtained for any alterations or additions which may have been carried out to the property, (d) whether or not any replacement windows which may have been fitted comply with Building Regulations and (e) whether or not any Guarantees exist for any Specialist treatment works which may have been carried out at the property. Any purchaser shall require to carry out his own investigations in respect of such matters. Interested parties should have their own Solicitors note interest with ourselves in order that they might be advised of any closing date which may be set for offers. The sellers do not bind themselves to accept the highest or any offer which may be received for the property.

**espc Johnson Legal**

