

93, SPECTRUM APARTMENTS, CENTRAL PROMENADE DOUGLAS, IM2 4LL

£875 PER MONTH

Quiet and peaceful rear facing contemporary studio apartment available immediately and offered to let on an unfurnished basis with secure underground car parking space. Located on Douglas promenade, this fourth floor benefits from being within easy reach of the beach, business district and town centre.



GROUND FLOOR
311 sq.ft. (28.9 sq.m.) approx.

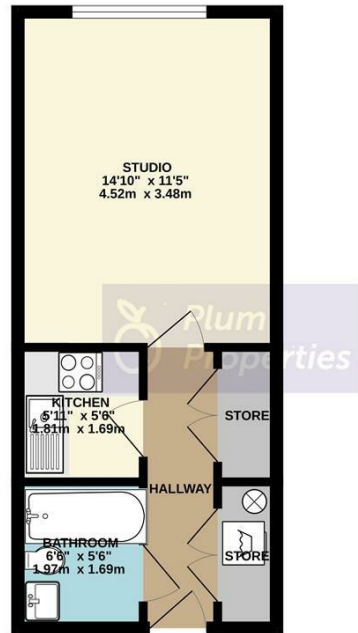

TOTAL FLOOR AREA: 311 sq.ft. (28.9 sq.m.) approx.

Whilst every attempt has been made to ensure the accuracy of the floorplan contained here, measurements of doors, windows, rooms and any other items are approximate and no responsibility is taken for any error, omission or mis-statement. This plan is for illustrative purposes only and should be used as such by any prospective purchaser. The services, systems and appliances shown have not been tested and no guarantee as to their operability or efficiency can be given.
Made with Metaphor 12/23

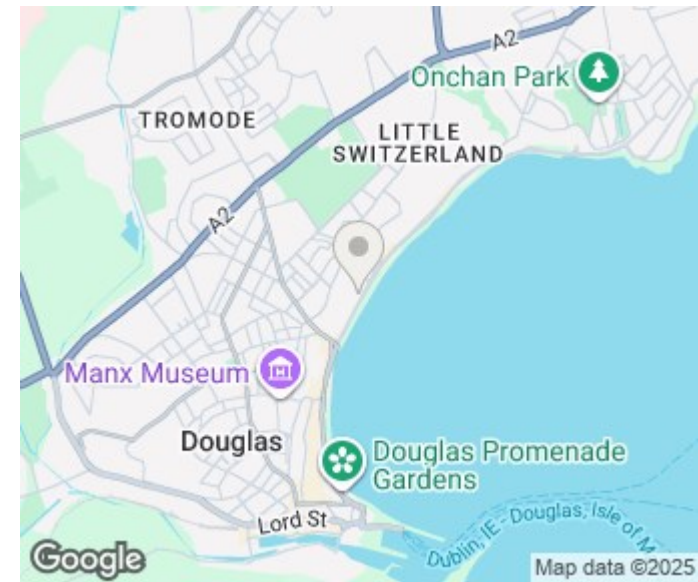

Head Office Lettings
64 Duke Street
Douglas
Isle Of Man
IM1 2AR

01624 777044
hello@partners.co.im
<http://www.partners.co.im>

Agents Note: Whilst every care has been taken to prepare these particulars, they are for guidance purposes only. All measurements are approximate and are for general guidance purposes only and whilst every care has been taken to ensure their accuracy, they should not be relied upon and potential buyers/tenants are advised to recheck the measurements