



## 21 CHRISTIAN ROAD IM1 2QH

£2,200 PER MONTH

Available immediately a 5 double bed period town house offered for rent on a flexible position over furnishings.

Ideally located for Douglas City Centre and all of its amenities, this generously proportioned property is ideal for larger families wish to be located within walking distance of local schools, shops and business district.



T: 01624 820600  
E: [hello@plumproperties.im](mailto:hello@plumproperties.im)  
W: [www.plumproperties.im](http://www.plumproperties.im)

• Available Immediately • Flexibility on Furnishings • 5 Double Bedrooms • 2 Bathrooms, one of which is En Suite • Generous Lounge with Bay Window • Separate Dining Room • Well Equipped Dining Kitchen • Additional Attic Space Ideal for Storage • Low Maintenance External Space • Street Parking with Residents Permit Available



## Overview

Nestled on Christian Road in Douglas, this charming mid-terrace townhouse offers an impressive 2,992 square feet of living space, perfect for families or those seeking a spacious home. Built in 1880, the property beautifully combines period features with modern conveniences, making it a delightful place to reside.

Upon entering, you are welcomed by a traditional vestibule that leads into a hallway with handy understairs storage. The ground floor boasts a generous lounge, complete with a large bay window that floods the room with natural light and a classic fireplace, creating a warm and inviting atmosphere. Adjacent to the lounge is a versatile reception room, which can serve as a dining area, complemented by a well-appointed dining kitchen at the rear. This kitchen is equipped with a free-standing tall fridge freezer, electric oven and hob, and a washing machine, ensuring all your culinary needs are met. The kitchen also provides access to a low-maintenance rear yard, featuring a decked area, ideal for outdoor relaxation.

The first floor comprises three spacious double bedrooms, one of which boasts modern en-suite facilities, including both a bath and a shower cubicle. The upper floor features two additional double bedrooms that share a contemporary family

bathroom, also equipped with a bath and shower cubicle. A staircase leads to the attic room, offering ample storage space.

This property is available immediately on a flexible furnished basis and is conveniently located within walking distance of Douglas city centre, providing easy access to the business district, shops, and various amenities. With its generous proportions and prime location, this townhouse is a rare find in the heart of Douglas.

## Additional Information

- Period Property
- Roadside Permit Parking Available
- Low Maintenance Outside Space
- Sorry, No Pets

## Directions





GROUND FLOOR  
847 sq.ft. (78.7 sq.m.) approx.

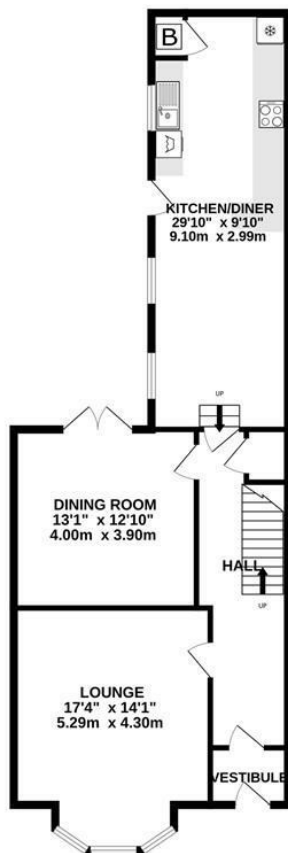

1ST FLOOR  
823 sq.ft. (76.4 sq.m.) approx.

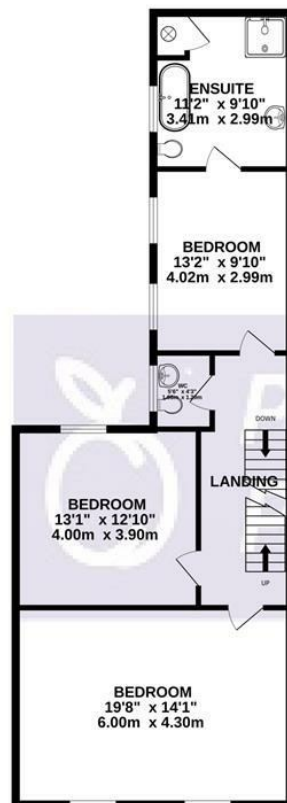

2ND FLOOR  
530 sq.ft. (49.2 sq.m.) approx.

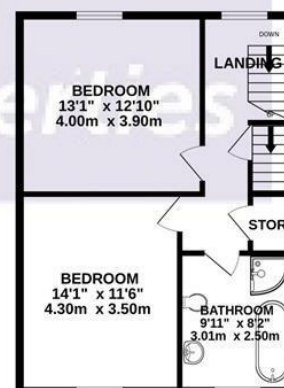

3RD FLOOR  
277 sq.ft. (25.7 sq.m.) approx.

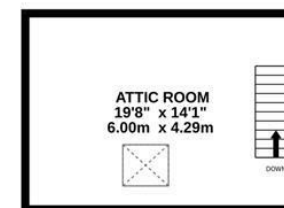

TOTAL FLOOR AREA : 2476 sq.ft. (230.0 sq.m.) approx.

Whilst every attempt has been made to ensure the accuracy of the floorplan contained here, measurements of doors, windows, rooms and any other items are approximate and no responsibility is taken for any error, omission or mis-statement. This plan is for illustrative purposes only and should be used as such by any prospective purchaser. The services, systems and appliances shown have not been tested and no guarantee as to their operability or efficiency can be given.  
Made with Metropix ©2025



Head Office Lettings  
1 Athol Street  
Douglas  
Isle Of Man  
IM1 1LD

T: 01624 820600  
E: [hello@plumproperties.im](mailto:hello@plumproperties.im)  
W: [www.plumproperties.im](http://www.plumproperties.im)

Agents Note: Whilst every care has been taken to prepare these particulars, they are for guidance purposes only. All measurements are approximate and are for general guidance purposes only and whilst every care has been taken to ensure their accuracy, they should not be relied upon and potential buyers/tenants are advised to recheck the measurements