



25 CHRISTIAN ROAD

DOUGLAS, IM1 2QH

£359,950
FREEHOLD

Extremely Well Presented Mid Terraced House. Situated in a Central Convenient Location Within a Stones Throw from City Centre and Amenities. Viewing Highly recommended.

 **Plum
Properties**

T: 01624 820600
E: hello@plumproperties.im
W: www.plumproperties.im

• Extremely Well Presented Mid Terraced House • Large Lounge (With Multi Fuel Burner) • Dining Room, Modern Dining Kitchen • 5 Good Sized Bedrooms (1 with Ensuite and 1 with Large Dressing Room) • Spacious Attic Room • Downstairs and Upstairs WC's • Oil Fired Central Heating and uPVC Double Glazed Throughout (New Composite Front Door) • Yard at Rear Providing Off Road Parking for 1 Car Accessed Via Roller Door (Plus Newly Paved Front) • Viewing Highly Recommended on this Super Value for Money Family Home



Overview

Nestled on the charming Christian Road in Douglas, this delightful mid-terrace house offers a perfect blend of classic character and modern living. Built in 1900, the property boasts a rich history while providing ample space for a growing family or those who enjoy entertaining.

Upon entering, you are welcomed by two inviting reception rooms, ideal for both relaxation and social gatherings. These versatile spaces can be tailored to suit your lifestyle, whether you envision a cosy sitting room or a vibrant family area. The natural light that floods through the windows enhances the warm and welcoming atmosphere throughout the home.

Additional Information

Rateable Value: For latest rateable value please contact the Rates Office on 685661

Inclusions : TBC

School District: HBN Primary School, Ballakermeen High School

Directions

Travelling out of Douglas up Prospect Hill Through the Circular Road Junction on to Bucks Road, Take the 3rd Right (at Islander Chippy) on to Christian Road Where no 25 can be easily Located on the Right Hand Side.



GROUND FLOOR
1138 sq.ft. (105.7 sq.m.) approx.

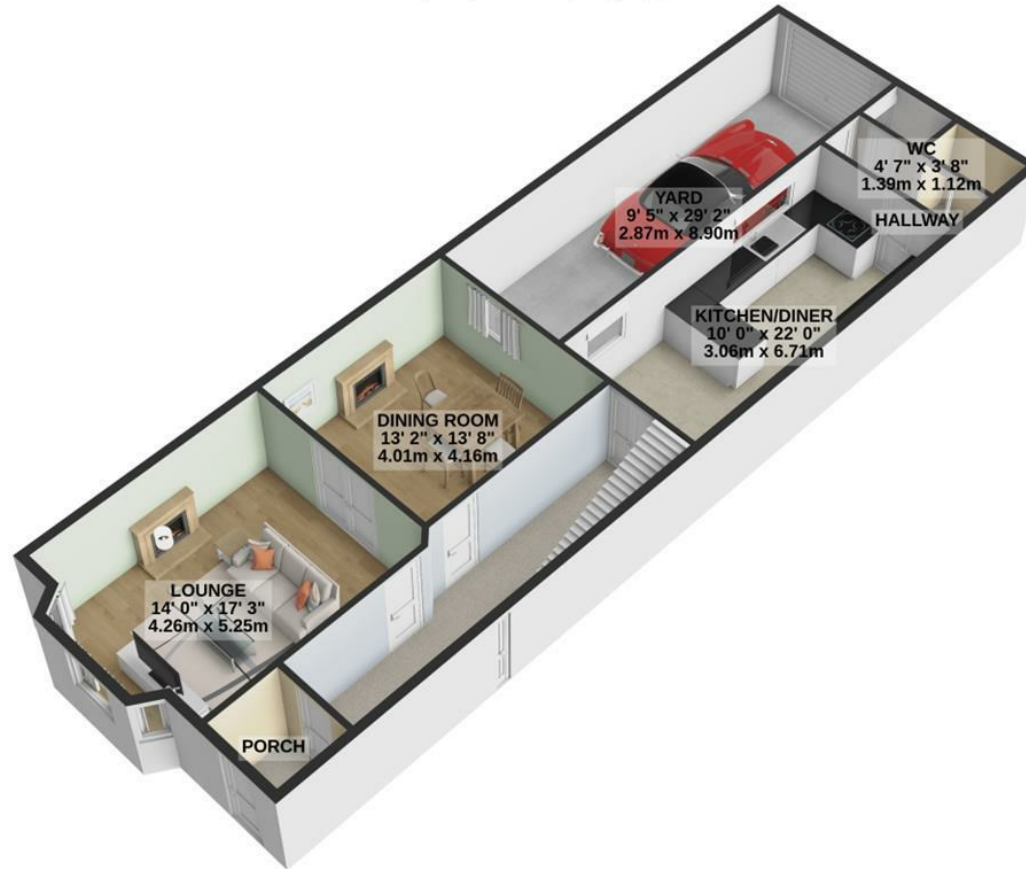

TOTAL FLOOR AREA : 2886 sq.ft. (268.1 sq.m.) approx.

For illustrative purposes only. Decorative finishes, fixtures, fittings and furnishings do not represent the current state of the property. Measurements are approximate. Not to scale.

Made with Metropix © 2024



T: 01624 820600
E: hello@plumproperties.im
W: www.plumproperties.im

Head Office Lettings
1 Athol Street
Douglas
Isle Of Man
IM1 1LD

Agents Note: Whilst every care has been taken to prepare these particulars, they are for guidance purposes only. All measurements are approximate and are for general guidance purposes only and whilst every care has been taken to ensure their accuracy, they should not be relied upon and potential buyers/tenants are advised to recheck the measurements