



32 DERBY ROAD

DOUGLAS, IM2 3ET

£385,000
FREEHOLD

Imposing and Deceptively Spacious End of Terrace Town House Situated in a Convenient Residential Location Close to Douglas Town Centre and Amenities.

The Property has Undergone Substantial Renovations and Refurbishment and is Presented to a Super Standard.



T: 01624 820600
E: hello@plumproperties.im
W: www.plumproperties.im

• Spacious End of Terrace Town House • Large Lounge • Dining Room • Modern Fitted Kitchen • 6 Bedrooms Including Magnificent Top Floor 2nd Master Benefitting from Sea Views • 4 Bathrooms (2 Ensuites plus 1 Shower Room and 1 Bathroom) • Oil Fired Central Heating • Recently Installed uPVC Double Glazed Windows Throughout • Sunny Rear Courtyard



overview

Located on the charming Derby Road in Douglas, this impressive end terrace house offers a splendid opportunity for those seeking a spacious family home. With an expansive layout, the property boasts two inviting reception rooms, perfect for entertaining guests or enjoying quiet family evenings.

The house features six generously sized bedrooms, providing ample space for family members or guests. Each room is designed to offer comfort and privacy, making it an ideal setting for a growing family or those who appreciate having extra space.

additional information

Viewings Highly Recommended

Rateable Value: For latest rateable value please contact the Rates Office on 685661

Inclusions : TBC

directions

Travelling Along Douglas Promenade, turn Left just after Villa Marina on to Broadway then Next Left on to Derby Road. Proceed up Derby Road where the Property can be Located on the Right Making the Corner of Derby Road and Melbourne Street.



GROUND FLOOR
764 sq.ft. (70.9 sq.m.) approx.

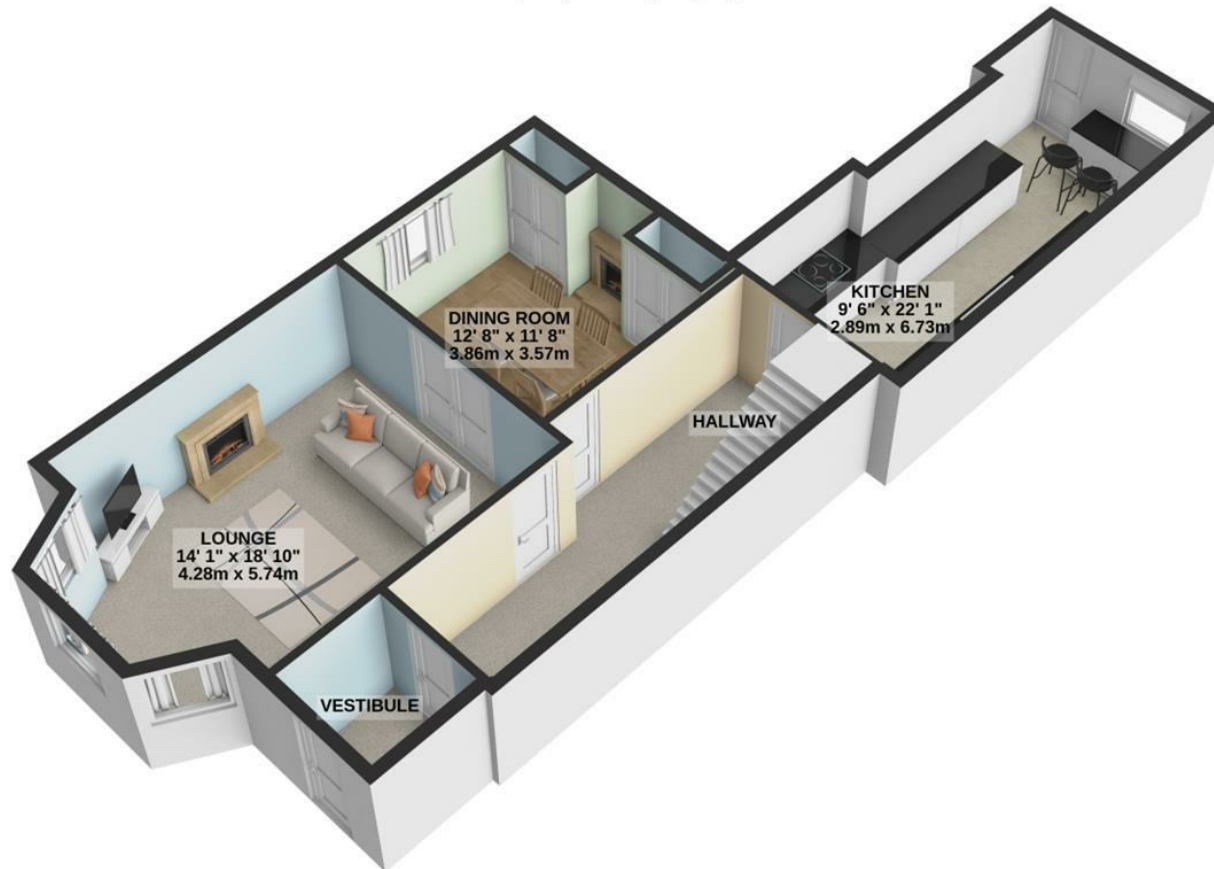

TOTAL FLOOR AREA : 2453 sq.ft. (227.9 sq.m.) approx.

For illustrative purposes only. Decorative finishes, fixtures, fittings and furnishings do not represent the current state of the property. Measurements are approximate. Not to scale.

Made with Metropix © 2024



T: 01624 820600
E: hello@plumproperties.im
W: www.plumproperties.im

Head Office Lettings
1 Athol Street
Douglas
Isle Of Man
IM1 1LD

Agents Note: Whilst every care has been taken to prepare these particulars, they are for guidance purposes only. All measurements are approximate and are for general guidance purposes only and whilst every care has been taken to ensure their accuracy, they should not be relied upon and potential buyers/tenants are advised to recheck the measurements