



South City Court, Peckham Grove, SE15
OIEO £400,000

0208 702 9666
pedderproperty.com

pedder



In general

- Two double bedrooms
- Three meter high ceilings
- Warehouse conversion
- Abundance of natural light

In detail

Elevate your city living experience with this fantastic top-floor gem nestled in the charming South City Court warehouse conversion. Boasting breath taking City Views, soaring ceilings, and an abundance of natural light, this property is a true urban oasis.

Step inside to discover two spacious double rooms, a sleek modern bathroom, and a stylish open plan kitchen/living/dining area. With expansive windows gracing every room, soak in the mesmerising city vistas and bask in the flood of natural light that fills the space.

Conveniently located just a stone's throw away from Burgess Park, this residence offers easy access to an array of transport links. Bus routes along Southampton Way (0.1mi) provide seamless connectivity, while Peckham Rye Railway Station (0.7 miles) and Denmark Hill Railway Station (0.8 miles) offer swift access to various destinations across the city.

Indulge in the epitome of urban living with this exceptional property, where contemporary and industrial design meets unparalleled convenience amidst the vibrant energy of the city.

EPC: D | Council Tax Band: C | Lease: 976 years remaining | SC: £1,619.72 pa | GR: £250.00 pa | Buildings Insurance: £393.74



Floorplan

South City Court, SE15
 Approximate Gross Internal Area
 52.6 sq m / 566 sq ft



CH = Ceiling Height

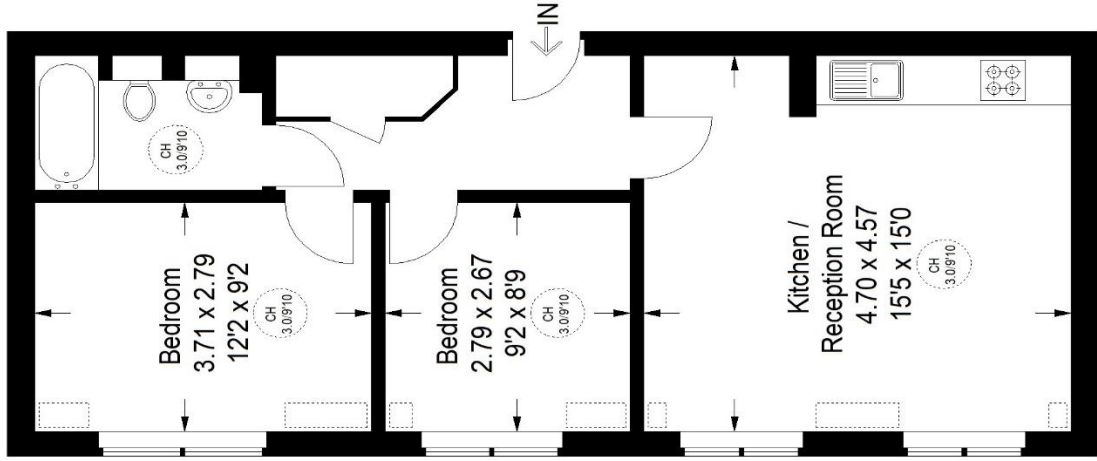

Fourth Floor

= Reduced headroom below 1.5 m / 5'0"

Copyright www.pedderproperty.com © 2024
 These plans are for representation purposes only as defined by RICS - Code of Measuring Practice. Not drawn to Scale. Windows and door openings are approximate. Please check all dimensions, shapes and compass bearings before making any decisions reliant upon them.



Pedder Property Ltd trading as Pedder for themselves and for the vendor/landlord of this property whose agents they are, give notice that (1) these particulars do not constitute any part of an offer or contract, (2) all statements contained within these particulars are made without responsibility on the part of Pedder or the vendor/landlord, (3) whilst made in good faith, none of the statements contained within these particulars are to be relied upon as a statement of representation or fact, (4) any intending purchaser/tenant must satisfy him/herself by inspection or otherwise as to the correctness of each of the statements contained within these particulars, (5) the vendor/landlord does not make or give either Pedder or any person in their employment any authority to make or give representation or warranty whatsoever in relation to this property.