



Alex & Matteo
ESTATE AGENTS



Alex & Matteo
ESTATE AGENTS



Alex & Matteo
ESTATE AGENTS



Alex & Matteo
ESTATE AGENTS

Rotherhithe New Road, London, SE16 3FP

****FURNITURE SHOWN IN THE PHOTOS IS VIRTUALLY STAGED****
**** NO HMO LICENCE - SUITABLE ONLY FOR TWO SHARERS OR A FAMILIES ****

A generous three bedroom, two bathroom, ninth floor apartment; located in Bermondsey and surrounded by plenty of local amenities.

The apartment features a open-plan modern kitchen and reception space completed with a private balcony. Three generous double bedrooms, two with built-in storage, a stylish en-suite bathroom and sleek family bathroom. The property also benefits from a spacious roof terrace with incredible views of the London Skyline.

The apartment is a short walk away from a plethora of local restaurants, cafes, bars, supermarket, and the greenery of both Burgess and Southwark Park.

- Stylish Three Bedroom Apartment
- Surrounded by a plethora of local amenities
- Private Balcony
- Generous Roof Terrace
- Modern Kitchen

Alex & Matteo
ESTATE AGENTS

£2,600 Per month

Chancellor House SE16

Approximate Area = 1066 sq ft / 99.0 sq m

For identification only - Not To Scale

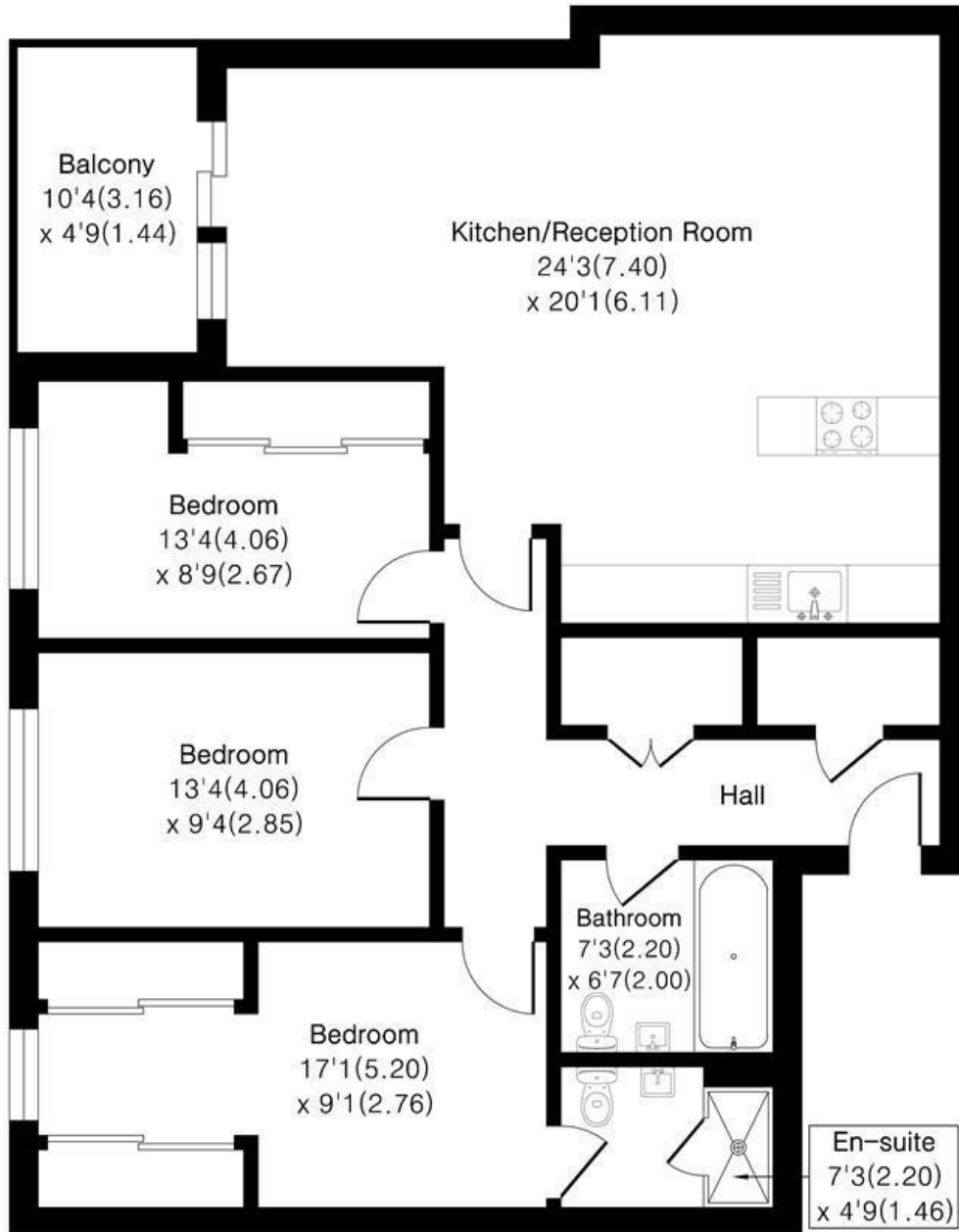

Ninth Floor

Alex & Matteo
ESTATE AGENTS

Floor plan Produced in accordance with RICS Property Measurement 2nd Edition.
Incorporating International Property Measurement Standards (IPMS2 Residential).
Produced for Alex & Matteo Estate Agents.



Energy Efficiency Rating		
	Current	Potential
Very energy efficient - lower running costs		
(92 plus) A		
(81-91) B	86	86
(69-80) C		
(55-68) D		
(39-54) E		
(21-38) F		
(1-20) G		
Not energy efficient - higher running costs		
England & Wales EU Directive 2002/91/EC		