



Southwark Park Road, London, SE16 3RP

Guide Price £400k to £425k. A stylish one-bedroom Victorian conversion garden apartment located in ever so popular Bermondsey. The property boasts a naturally bright reception room, a modern kitchen with quartz worktop and all mod cons, a sleek and cleverly designed bathroom, a good sized double bedroom, access to a very spacious part-communal garden, ideal for alfresco dining and entertainment. Additional storage can be found in the hallway. The surrounding area boasts a plethora of local amenities such as pubs, cafes, supermarkets, restaurants, and iconic markets. A 15 minute walk for Bermondsey Underground station as well as having bus links outside.

Years on Lease - 106
Annual Service Charge - £684.07
Annual Ground Rent - £110
Council Tax Band - B

Council tax and, where applicable, lease information, service charges, ground rent, property size, are given as a guide only and should always be checked and confirmed by your Solicitor prior to exchange of contracts.

- Victorian Conversion Apartment
- Part Communal Garden
- Residents Car Parking Permit Available
- Modern Kitchen
- Stylish Bathroom
- Plenty of Storage
- Featuring Period Wooden Floorboards

Alex & Matteo
ESTATE AGENTS

Guide price £400,000

Southwark Park Road, London, SE16

Approximate Area = 471 sq ft / 43.8 sq m

For identification only - Not to scale

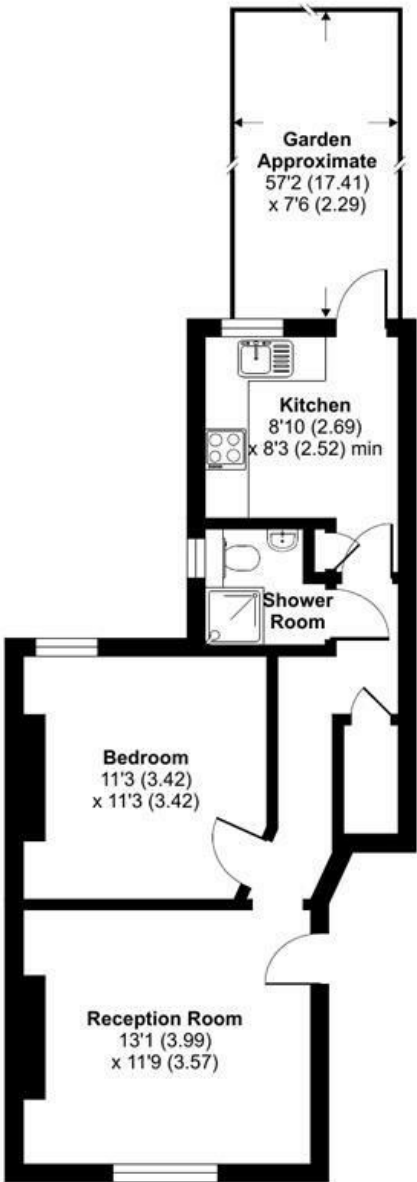

GROUND FLOOR

Alex & Matteo
ESTATE AGENTS



Certified
Property
Measurer

Floor plan produced in accordance with RICS Property Measurement Standards incorporating International Property Measurement Standards (IPMS2 Residential). © nitchcom 2024. Produced for Alex & Matteo Estate Agents. REF: 1174013

