

Arts Lane, London, SE16 3GA

A contemporary apartment with a generous private terrace in one of the most modern portered developments in Bermondsey, by the greenery of Spa Gardens and within easy reach of both Bermondsey and London Bridge underground stations. The property boasts a spacious open plan area with a modern kitchen, a modern vertical foldable bed unit, and a stylish bathroom.

On-site benefits includes concierge and access to the gym. Maltby street market and Bermondsey street with a plethora of independent boutiques, restaurants and coffee shops are nearby

COUNCIL TAX BAND----> D

- Modern Apartment
- Very Generous Private Terrace
- Lift
- Naturally Bright Living Area
- Within Easy Reach of Bermondsey and London Bridge Underground Station
- Concierge and Gym
- Onsite Grocery Store
- Moments from Maltby Street Market and Bermondsey Street

Alex & Matteo
ESTATE AGENTS

£1,600 Per month

Arts Lane, London, SE1

Total = 428 sq ft / 39.8 sq m
For identification only - Not to scale

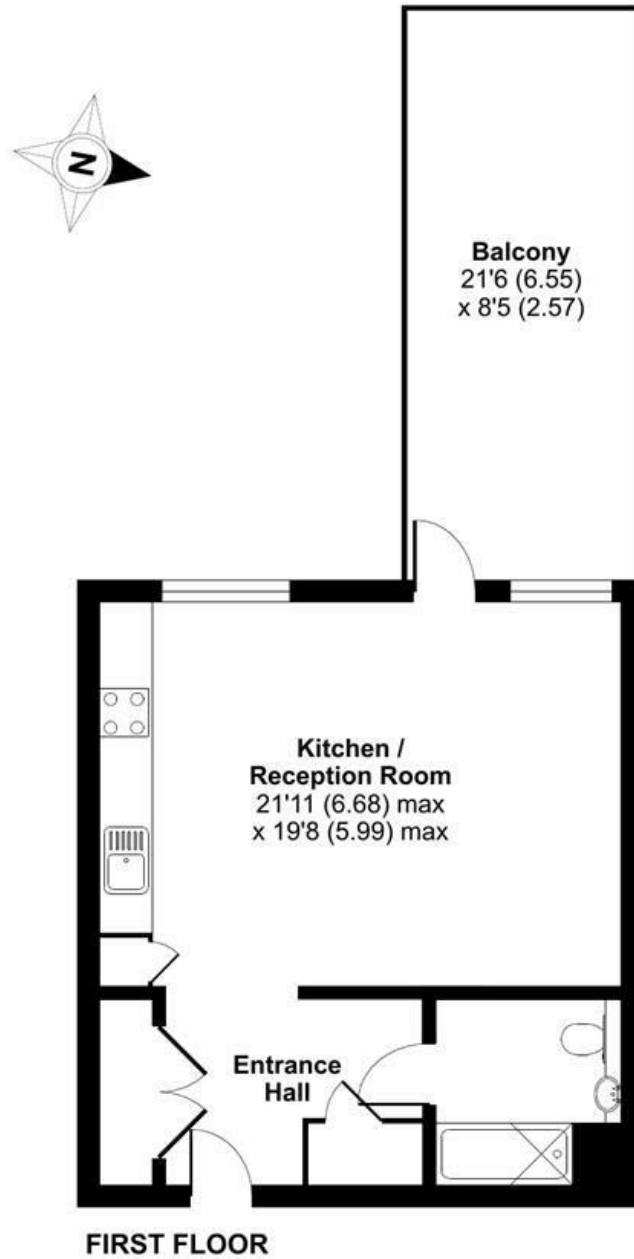

Floor plan produced in accordance with RICS Property Measurement Standards incorporating International Property Measurement Standards (IPMS2 Residential). © nchecon 2022. Produced for Alex & Matteo Estate Agents. REF: 865912.

Energy Efficiency Rating		Current	Potential
Very energy efficient - lower running costs			
(92 plus) A			
(81-91) B		82	82
(69-80) C			
(55-68) D			
(39-54) E			
(21-38) F			
(1-20) G			
Not energy efficient - higher running costs			
England & Wales	EU Directive 2002/91/EC		