



## Culloden Close, London, SE16 3JH

A beautifully presented three bedroom house in the heart of vibrant Bermondsey. Downstairs are the naturally bright living room, a separate kitchen with plenty of storage space, a generous conservatory leading into the spacious garden ideal for alfresco dining, and a guest lavatory. Upstairs are the three double bedrooms with plenty of storage space and a stylish family bathroom. More storage can be found under the stairs and in the loft. Additional benefits include an allocated parking space.

- Immaculately Presented Three Bedroom House
- Naturally Bright Livingroom
- Spacious Kitchen With Plenty of Storage Space
- Generous Conservatory
- Private Garden
- Stylish Family Bathroom
- Allocated Parking Space
- Scope for Extension

**Alex & Matteo**  
ESTATE AGENTS

**£575,000**

# Culloden Close, London, SE16

Approximate Area = 864 sq ft / 80.2 sq m (excludes shed & store)

For identification only - Not to scale

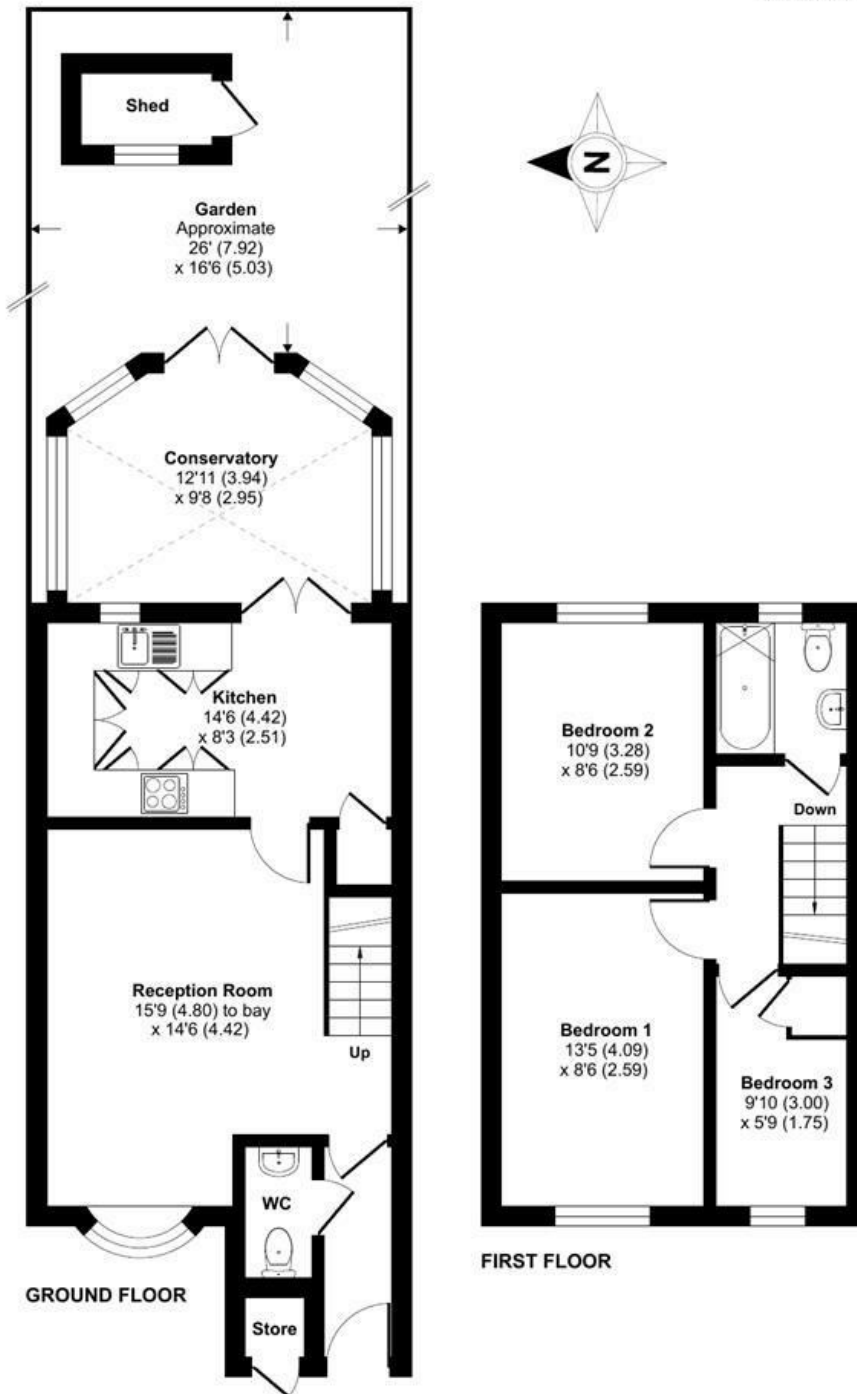

**Alex & Matteo**  
ESTATE AGENTS



Certified  
Property  
Measurer

Floor plan produced in accordance with RICS Property Measurement Standards incorporating International Property Measurement Standards (IPMS2 Residential). © nitchcom 2023. Produced for Alex & Matteo Estate Agents. REF: 1057578

