



Sherwood Gardens, London, SE16 3JB

A generous one bedroom apartment in a quiet Bermondsey residential setting. With modern double glazed windows throughout, the apartment boasts a good sized living room leading into the residents garden, a separate kitchen with plenty of space to dine, a spacious double bedroom, and the well kept bathroom. Additional benefits include designated parking space and an additional communal garden in the back. South Bermondsey Station is a 5 minute commute to London Bridge is just round the corner as well as a plethora of local amenities.

- Spacious One Bedroom Apartment
- Separate Kitchen with Space to Dine
- Direct Access To Garden
- Designated Car Parking Space
- Communal Garden
- Moments from South Bermondsey Station for a 5 minute Commute to London Bridge
- Steps from Bus Stop

Alex & Matteo
ESTATE AGENTS

Offers in excess of £300,000

Birchmere Lodge, Sherwood Gardens

Approx. Gross Internal Area 473 Sq Ft - 43.94 Sq M

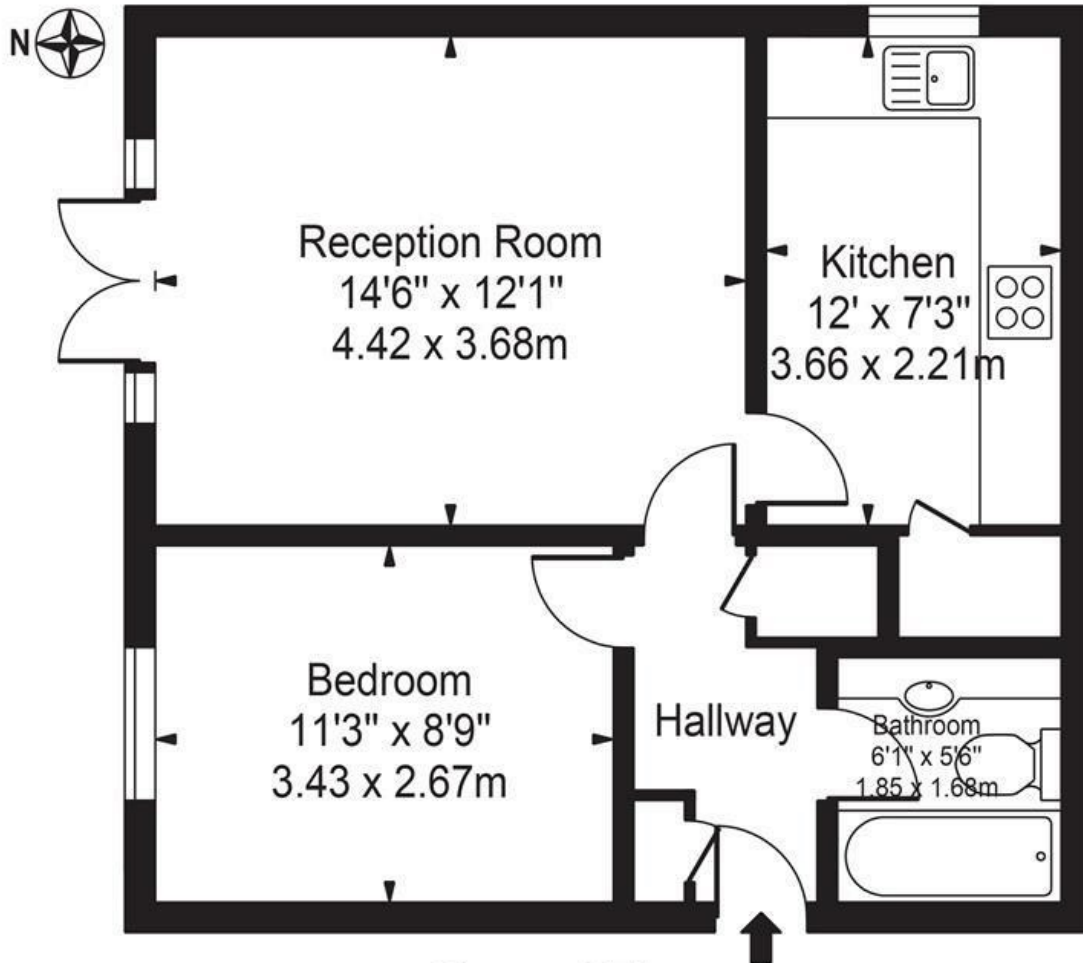

Ground Floor

For Illustration Purposes Only - Not To Scale

This floor plan should be used as a general outline for guidance only and does not constitute in whole or in part an offer or contract. Any intending purchaser or lessee should satisfy themselves by inspection, searches, enquiries and full survey as to the correctness of each statement. Any areas, measurements or distances quoted are approximate and should not be used to value a property or be the basis of any sale or let.

