



Arden Drive

Warsash, Southampton, SO31 9EH

£1,550 Per month



Signature Properties is excited to bring to market this beautiful two-bedroom coach house in the scenic village of Warsash, Southampton.

This property enjoys an excellent location, just a short drive to transport links, including Swanick & Barnes Lane Station, Southampton Airport and the M27, making it ideal for commuters. Supermarkets and other local amenities are conveniently located nearby.

The accommodation includes a spacious open-plan living area with a Juliet balcony and a modern fitted kitchen equipped with integrated appliances. There are two double bedrooms, each providing ample storage space, along with an ensuite shower room and a family bathroom. Additional benefits consist of double glazing, solar panels, an enclosed south-facing garden, and undercover parking for one vehicle.

We highly recommend scheduling a viewing to appreciate the property fully. To arrange a viewing, please contact Signature Properties.



Area Map



Floor Plans

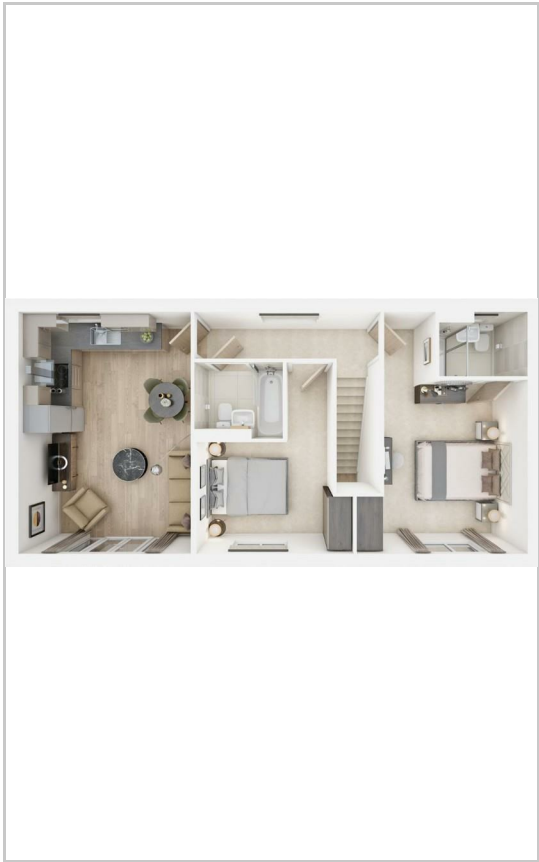

Energy Efficiency Graph

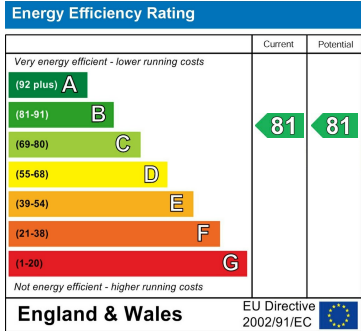

These particulars, whilst believed to be accurate are set out as a general outline only for guidance and do not constitute any part of an offer or contract. Intending purchasers should not rely on them as statements of representation of fact, but must satisfy themselves by inspection or otherwise as to their accuracy. No person in this firms employment has the authority to make or give any representation or warranty in respect of the property.