



Flat 15 1 Silvester Road

, Waterloooville, PO8 8TD

£950 Per month



Signature Properties are delighted to offer to the market this spacious one bedroom apartment situated on Silvester Road in Cowplain, a short stroll from the local shops.

The living accommodation comprises of a good size lounge/kitchen fitted with integrated Oven/ hob, fridge/freezer, dishwasher & washing machine. A double bedroom and a modern bathroom with a shower over the bath. Water rates are charged at £40 pcm. The property also benefits from double glazing, gas central heating and one allocated parking space.

Floor plan measurements may not be accurate so please contact us to arrange your viewing. Tenancy Length: 12 month tenancies renewed annually (6 month tenancies can be discussed)

***All applicants will be credit checked and fully referenced prior to a tenancy commencing. You will be required to pay the first month's rent and a security deposit prior to moving in. The deposit is equivalent of five weeks rent ***



Area Map



Floor Plans

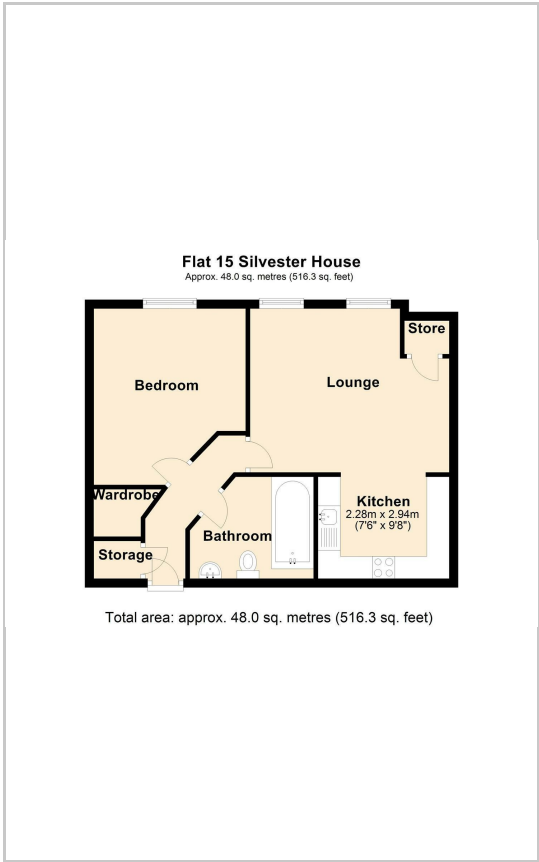

Energy Efficiency Graph

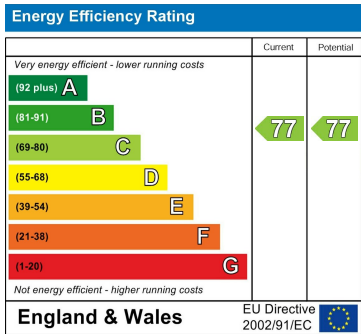

These particulars, whilst believed to be accurate are set out as a general outline only for guidance and do not constitute any part of an offer or contract. Intending purchasers should not rely on them as statements of representation of fact, but must satisfy themselves by inspection or otherwise as to their accuracy. No person in this firms employment has the authority to make or give any representation or warranty in respect of the property.