



Elan House F5, 5a Little Park Farm Road

Segensworth, Fareham, PO15 5SJ

£923 Per month



Elan House is a newly refurbished serviced office property boasting new LED lighting and comfort cooling/heating system. Each office comes with benefits various amenities such as an onsite Café, ample breakout and leisure areas and two meeting rooms. We offer furnished or unfurnished offices, with a staffed Reception, 24/7 access and onsite parking. All utilities and internet are included, excluding rates, furniture and telephony. F5 is a 1st floor external office of 277 square foot.



Area Map



Floor Plans

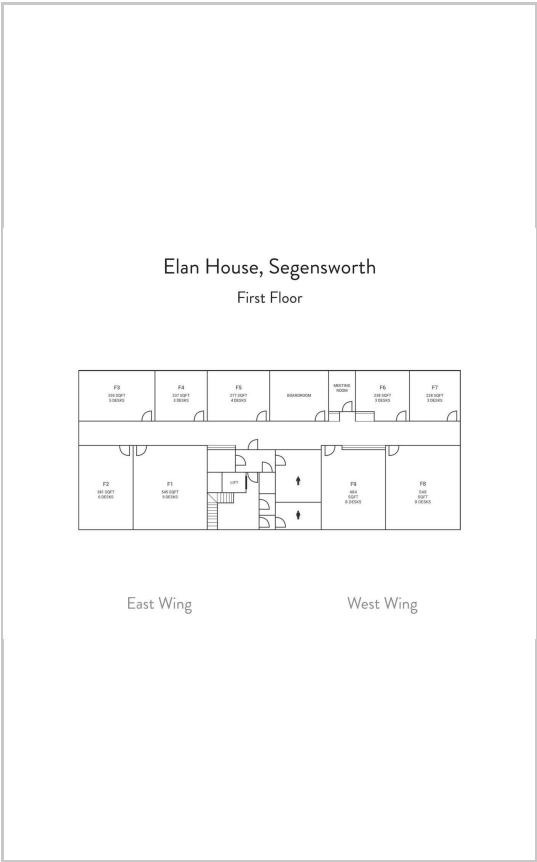

Energy Efficiency Graph

| Energy Efficiency Rating | | Current | Potential |
|--|--|-------------------------|-----------|
| <i>Very energy efficient - lower running costs</i> | | | |
| (92 plus) A | | | |
| (81-91) B | | | |
| (69-80) C | | | |
| (55-68) D | | | |
| (39-54) E | | | |
| (21-38) F | | | |
| (1-20) G | | | |
| <i>Not energy efficient - higher running costs</i> | | | |
| England & Wales | | EU Directive 2002/91/EC | |

These particulars, whilst believed to be accurate are set out as a general outline only for guidance and do not constitute any part of an offer or contract. Intending purchasers should not rely on them as statements of representation of fact, but must satisfy themselves by inspection or otherwise as to their accuracy. No person in this firms employment has the authority to make or give any representation or warranty in respect of the property.