



Cafe, Elan House 5a Little Park Farm Road, Segensworth, Fareham, PO15 5SJ £550 Per month

This kitchen facility is located on the ground floor of new serviced office development, situated in Segensworth, Fareham. The M27(M) is approximately ½ mile away, leading to Southampton, Portsmouth and M3. Swanwick train station is approximately five minutes drive away.

The kitchen unit is secure within the building. accessed through a communal corridor with separate access.

It benefits from an electric cooker, ovens and industrial dishwashers. The unit is not a retail facility open to members of the public.

- Recently Refurbished
- Integrated Appliances
- Air Conditioning
- 24/7 Access
- Serving Hatch
- Onsite Clientele
- Easy M27 Access
- Onsite Parking

Viewing

Please contact our Elan House Office on 01489 664254 if you wish to arrange a viewing appointment for this property or require further information.

Floor Plan

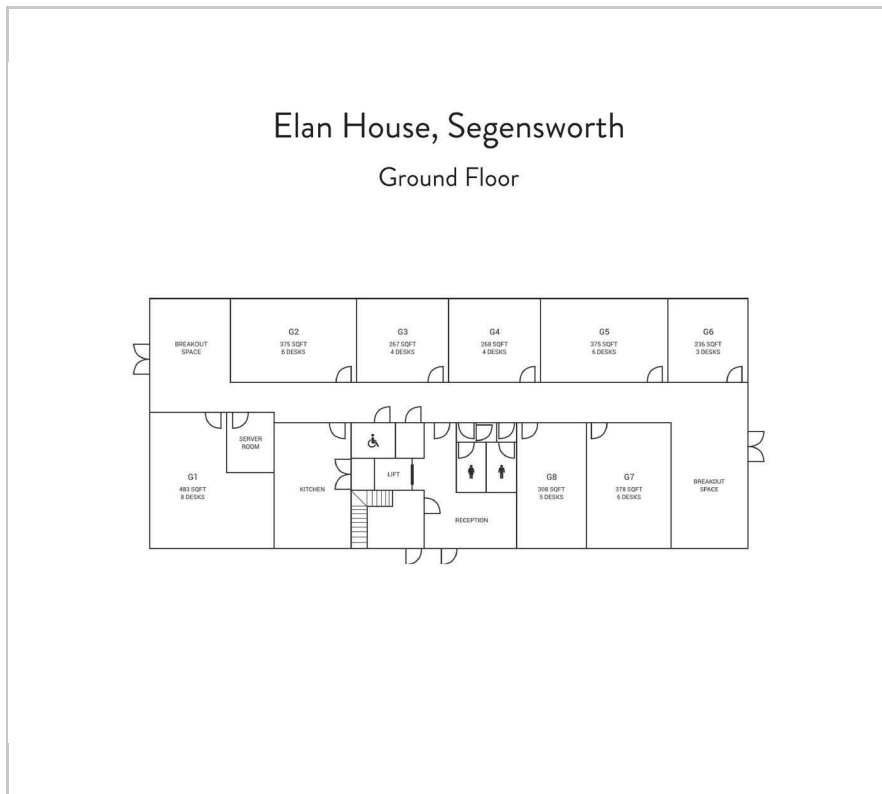

Area Map

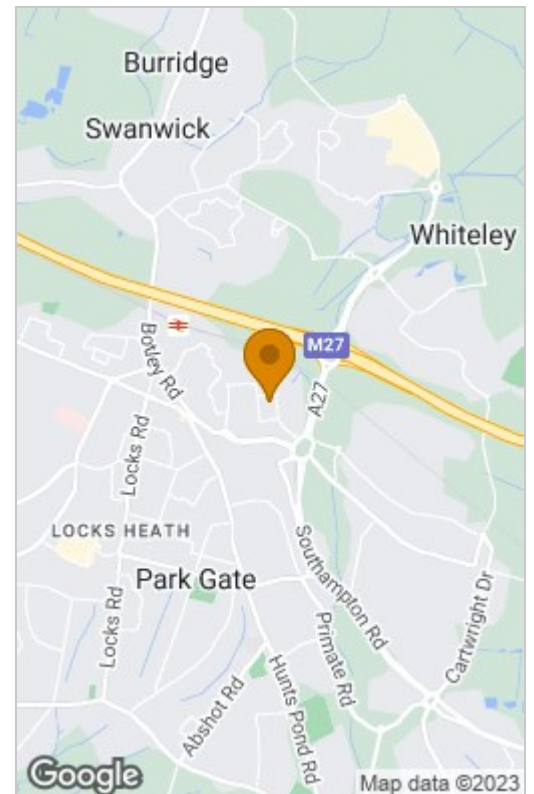

These particulars, whilst believed to be accurate are set out as a general outline only for guidance and do not constitute any part of an offer or contract. Intending purchasers should not rely on them as statements of representation of fact, but must satisfy themselves by inspection or otherwise as to their accuracy. No person in this firm's employment has the authority to make or give any representation or warranty in respect of the property.

5a Little Park Farm Road Segensworth, Fareham, Hampshire, PO15 5TT

Tel: 01489 664254 Email: stacey.mahoney@signaturepropertiesuk.co.uk <https://www.signaturepropertiesuk.co.uk>